

**GEORGIA ENVIRONMENTAL PROTECTION DIVISION  
HAZARDOUS SITE INVENTORY**

Site Number: **10467**

**SITE NAME:** Bleckley County Municipal Landfill  
**LOCATION:** State Route 26  
 Cochran, Bleckley County, GA 31014

Latitude 32° 25' 17" N      Longitude 83° 18' 34" W

**ACREAGE**      **PARCEL NUMBER**      **DATE LISTED**  
 69.67      B51 129      4/28/1997

**LAST KNOWN PROPERTY OWNER:**

Bleckley County  
 112 N. Second Street, PO Box 272  
 Cochran, GA 31014

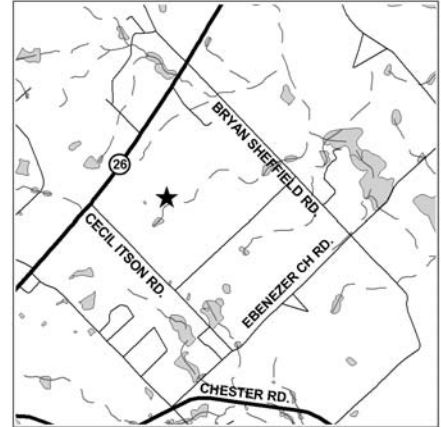

**STATUS OF CLEANUP ACTIVITIES:**

Cleanup activities are being conducted for source materials and groundwater.

**CLEANUP PRIORITY:** The Director has designated this site as a Class IV

**GA EPD DIRECTOR'S DETERMINATION REGARDING CORRECTIVE ACTION:**

The Director has determined that this site requires corrective action.

**REGULATED SUBSTANCES RELEASED, AND THREATS TO HUMAN HEALTH AND ENVIRONMENT POSED BY THE RELEASE:**

This site has a known release of Vinyl chloride in groundwater at levels exceeding the reportable quantity. No human exposure via drinking water is suspected from this release. The nearest drinking water well is less than 0.5 miles from the area affected by the release.

**REGULATED SUBSTANCES:**

Substance Name	GW	Soil	Substance Name	GW	Soil
1,2-Dichloropropane	<input checked="" type="checkbox"/>	<input type="checkbox"/>	Barium	<input checked="" type="checkbox"/>	<input type="checkbox"/>
Benzene	<input checked="" type="checkbox"/>	<input type="checkbox"/>	Chlorobenzene	<input checked="" type="checkbox"/>	<input type="checkbox"/>
Chloroethane	<input checked="" type="checkbox"/>	<input type="checkbox"/>	Cis-1,2-Dichloroethene	<input checked="" type="checkbox"/>	<input type="checkbox"/>
Dichlorobenzene, N.O.S.	<input checked="" type="checkbox"/>	<input type="checkbox"/>	Lead	<input checked="" type="checkbox"/>	<input type="checkbox"/>
Naphthalene	<input checked="" type="checkbox"/>	<input type="checkbox"/>	p-Dichlorobenzene	<input checked="" type="checkbox"/>	<input type="checkbox"/>
Vinyl chloride	<input checked="" type="checkbox"/>	<input type="checkbox"/>	Xylenes	<input checked="" type="checkbox"/>	<input type="checkbox"/>
Zinc	<input checked="" type="checkbox"/>	<input type="checkbox"/>			