

**GEORGIA ENVIRONMENTAL PROTECTION DIVISION
HAZARDOUS SITE INVENTORY**

Site Number: **10829**

SITE NAME: Square D Company (Former)
LOCATION: 1401 Marietta Blvd. NW
Atlanta, Fulton County, GA 30318

Latitude 33° 47' 34" N Longitude 84° 25' 48" W

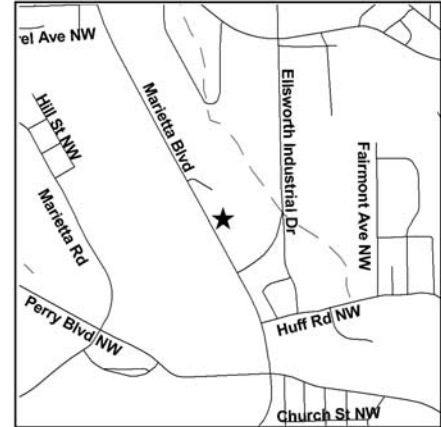

| ACREAGE | PARCEL NUMBER | DATE LISTED |
|---------|----------------|-------------|
| 5.3 | 17019100070444 | 1/13/2006 |
| 2.63 | 170191LL1465 | 1/13/2006 |
| 3.48 | 17019100070451 | 1/13/2006 |

LAST KNOWN PROPERTY OWNER:

Art Laminating & Finishing, LLC
2701 Wilmarco Ave.
Baltimore, MD 21223

M. West Homeowners Association, Inc.
1465 Northside Drive NW, Suite 128
Atlanta, GA 30318

STATUS OF CLEANUP ACTIVITIES:

Hazardous Site Response Act cleanup levels have been met for source materials and soil through institutional and engineering controls to eliminate or reduce present and future threats to human health and the environment. Cleanup activities are being conducted for groundwater.

CLEANUP PRIORITY: The Director has designated this site as a Class II

GA EPD DIRECTOR'S DETERMINATION REGARDING CORRECTIVE ACTION:

Pending

REGULATED SUBSTANCES RELEASED, AND THREATS TO HUMAN HEALTH AND ENVIRONMENT POSED BY THE RELEASE:

The Director has determined that a release of regulated substances from groundwater to a water of the state has resulted in an exceedance of state water quality standards.

REGULATED SUBSTANCES:

| Substance Name | GW | Soil | Substance Name | GW | Soil |
|--------------------------|-------------------------------------|-------------------------------------|---------------------------|-------------------------------------|-------------------------------------|
| 1,1,1-Trichloroethane | <input type="checkbox"/> | <input checked="" type="checkbox"/> | 1,1,2,2-Tetrachloroethane | <input checked="" type="checkbox"/> | <input type="checkbox"/> |
| 1,1,2-Trichloroethane | <input type="checkbox"/> | <input checked="" type="checkbox"/> | 1,1-Dichloroethane | <input checked="" type="checkbox"/> | <input checked="" type="checkbox"/> |
| 1,1-Dichloroethene | <input checked="" type="checkbox"/> | <input checked="" type="checkbox"/> | 1,2-Dichloroethane | <input checked="" type="checkbox"/> | <input checked="" type="checkbox"/> |
| Chloroethane | <input checked="" type="checkbox"/> | <input checked="" type="checkbox"/> | Chloroform | <input checked="" type="checkbox"/> | <input checked="" type="checkbox"/> |
| Cis-1,2-Dichloroethene | <input checked="" type="checkbox"/> | <input checked="" type="checkbox"/> | Crotonaldehyde, (E) | <input checked="" type="checkbox"/> | <input type="checkbox"/> |
| Dichlorobromomethane | <input checked="" type="checkbox"/> | <input checked="" type="checkbox"/> | Dichloromethane | <input checked="" type="checkbox"/> | <input checked="" type="checkbox"/> |
| Ethylbenzene | <input checked="" type="checkbox"/> | <input checked="" type="checkbox"/> | Methyl ethyl ketone | <input checked="" type="checkbox"/> | <input checked="" type="checkbox"/> |
| Tetrachloroethene | <input type="checkbox"/> | <input checked="" type="checkbox"/> | Toluene | <input type="checkbox"/> | <input checked="" type="checkbox"/> |
| trans-1,2-Dichloroethene | <input checked="" type="checkbox"/> | <input checked="" type="checkbox"/> | Trichloroethene | <input type="checkbox"/> | <input checked="" type="checkbox"/> |
| Vinyl chloride | <input type="checkbox"/> | <input checked="" type="checkbox"/> | Xylenes | <input type="checkbox"/> | <input checked="" type="checkbox"/> |