



ENVIRONMENTAL PROTECTION DIVISION

Jeffrey W. Cown, Director

EPD Director's Office

2 Martin Luther King, Jr. Drive
Suite 1456, East Tower
Atlanta, Georgia 30334
404-656-4713

CATEGORICAL EXCLUSION DETERMINATION

Circle Drive Trunk Sewer Replacement
City of LaFayette (Walker County)
GEFA Loan No. CW-2023-030

The Georgia Environmental Protection Division (EPD) has conducted a review of the above project in accordance with the State's Environmental Review Process (SERP). EPD has determined that this project is eligible for a categorical exclusion. Accordingly, no further environmental review is planned. The proposed project consists of the replacement of approximately 2,800 linear feet (LF) of 15-in gravity sewer, 2,100 LF of 12-in gravity sewer, and 800 LF of 16-in gravity sewer. Existing buildings will not be impacted as a result of this project. All construction will be located on City-owned property and/or existing right-of-ways. The project will be located in the 100-year floodplain as indicated by the Federal Emergency Management Agency (FEMA) map. However, the scope of work taking place within the floodplain consists of replacement and/or rehabilitation of sewer lines and will not impact the floodplain. Detailed mitigation measures will be described in the construction documents (plans and specifications) for the project.

This project is eligible for a categorical exclusion because it meets the following specific criteria, outlined in the SERP: functional replacement of equipment and construction of new ancillary facilities adjacent to existing facilities that do not affect the degree of treatment or capacity of the existing facility. Furthermore: the project will not create a new or relocate an existing discharge to surface or ground waters; the project will not substantially increase the volume of discharge or loading of pollutants; the project will not provide capacity to serve a population 30% greater than the existing population; the project will not have a significant effect on the quality of the human environment; the action will not directly or indirectly affect cultural resources, habitats of endangered or threatened species, or environmentally important natural resource areas; and the action is cost-effective and should cause no significant public controversy.

This determination is effective immediately. This exclusion may be revoked at any time if: 1) the project is altered and no longer meets the requirements of a categorical exclusion, 2) new evidence shows that serious environmental issues exist, or 3) a local, State or Federal law is being or may be violated. The information which supports this decision can be viewed online via the Georgia EPD Online System (GEOS) at https://geos.epd.georgia.gov/GA/GEOS/Public/Client/GA_GEOS/Public/Pages/PublicApplicationList.aspx and is available for public review upon request with the Georgia EPD.

If you have any questions about this determination, please contact August Lutkehus of my staff at august.lutkehus@dnr.ga.gov or (470) 524-0733.

Issuance Date: 04/11/2024

Jeffrey W. Cown, Director
Environmental Protection Division

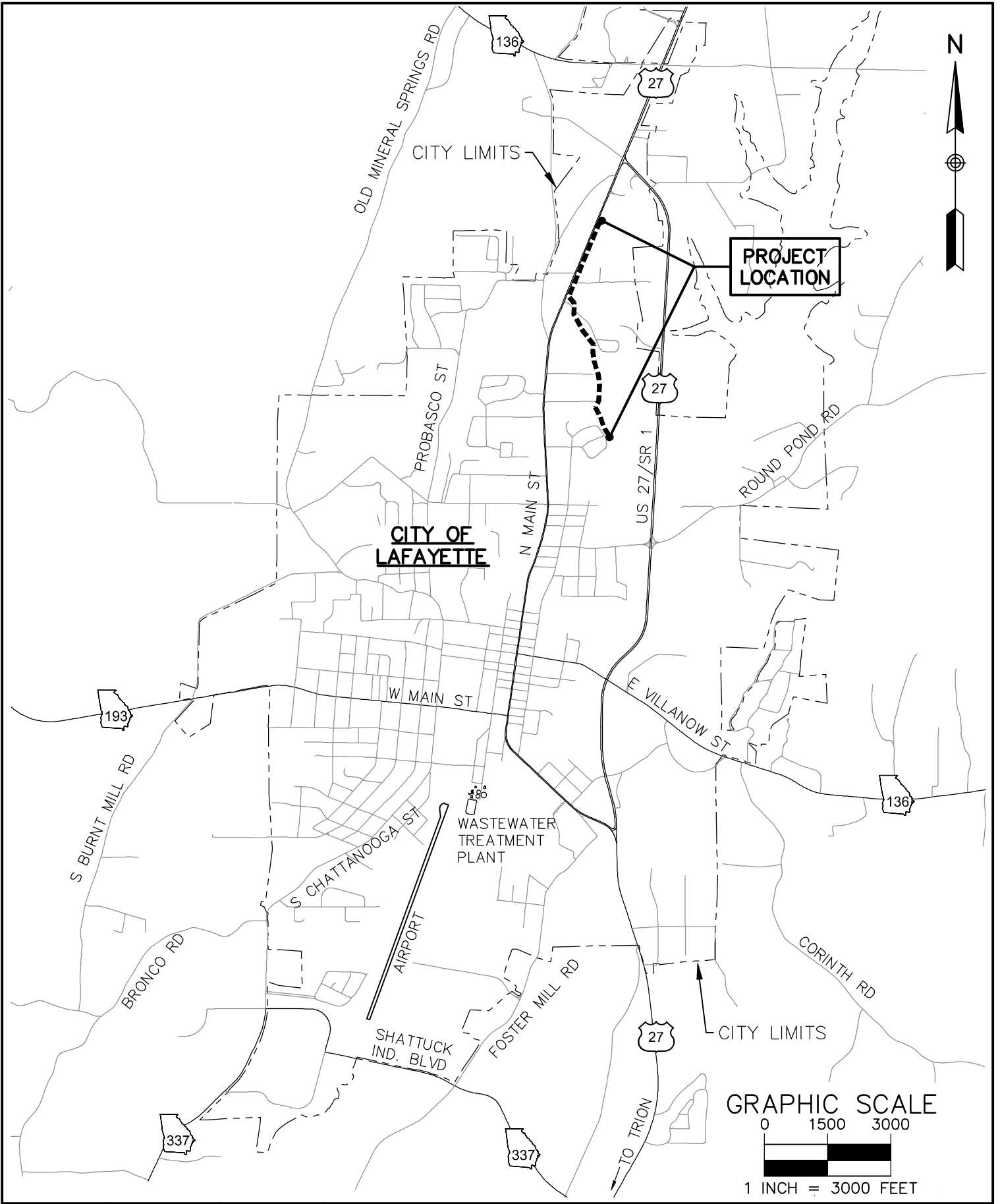

	PROJECT NO. 126-170.25
	DATE: OCTOBER 5, 2023

CIRCLE DRIVE TRUNK SEWER REPLACEMENT VICINITY MAP

FIGURE NO.
01

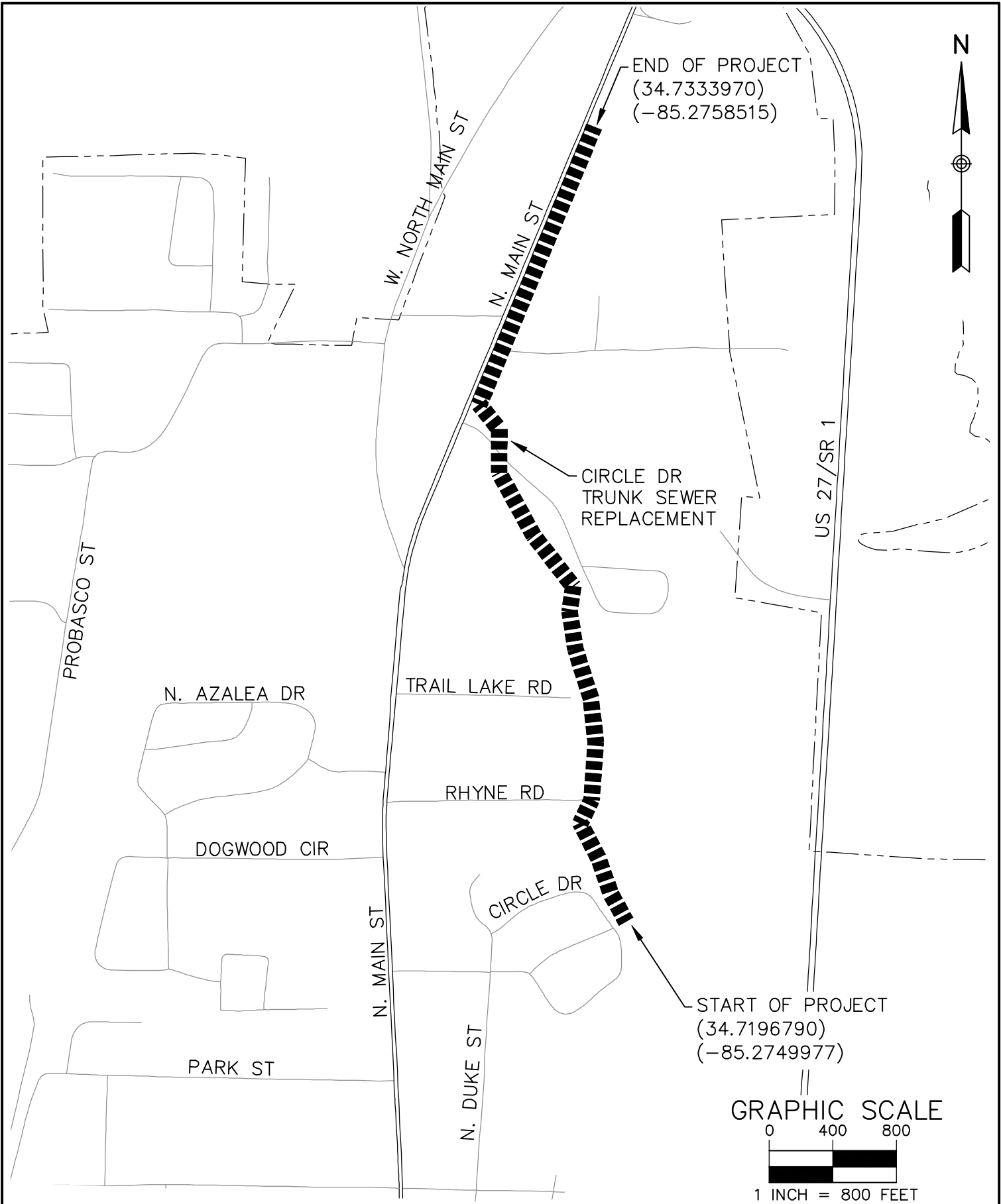

	PROJECT NO. 126-170.25
	DATE: OCTOBER 5, 2023

CIRCLE DRIVE TRUNK SEWER REPLACEMENT LOCATION MAP

FIGURE NO.
02