

**SITE NAME:** Woodgrain Millwork, Inc.  
**LOCATION:** 113 Industrial Boulevard  
Americus, Sumter County, GA 31719

Latitude 32° 6' 56" N Longitude 84° 12' 38" W

**ACREAGE** 6.88      **PARCEL NUMBER** 75 4      **DATE LISTED** 2/9/2000

**LAST KNOWN PROPERTY OWNER:**

MUDO Properties LLC  
161 Riverside Drive  
Cobb, GA 31735

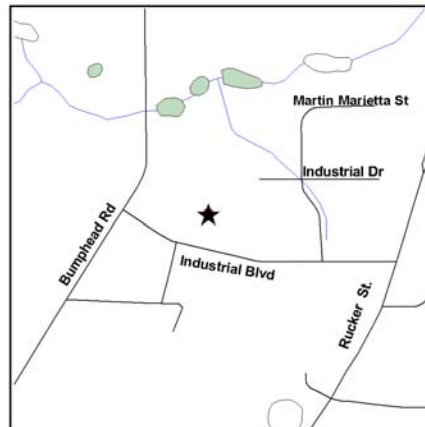

**STATUS OF CLEANUP ACTIVITIES:**

Cleanup activities are being conducted for source materials, soil, and groundwater.

**CLEANUP PRIORITY:** The Director has designated this site as a Class V

**GA EPD DIRECTOR'S DETERMINATION REGARDING CORRECTIVE ACTION:**

The Director has determined that this site requires corrective action.

**REGULATED SUBSTANCES RELEASED, AND THREATS TO HUMAN HEALTH AND ENVIRONMENT POSED BY THE RELEASE:**

This site has a known release of Benzene in groundwater at levels exceeding the reportable quantity. No human exposure via drinking water is suspected from this release. The nearest drinking water well is less than 0.5 miles from the area affected by the release.

**REGULATED SUBSTANCES:**

Substance Name	GW	Soil	Substance Name	GW	Soil
1,1,1-Trichloroethane	<input checked="" type="checkbox"/>	<input type="checkbox"/>	Benzene	<input checked="" type="checkbox"/>	<input checked="" type="checkbox"/>
bis(2-Ethylhexyl) phthalate	<input type="checkbox"/>	<input checked="" type="checkbox"/>	Chloroform	<input checked="" type="checkbox"/>	<input type="checkbox"/>
Dichlorobromomethane	<input checked="" type="checkbox"/>	<input type="checkbox"/>	Ethylbenzene	<input checked="" type="checkbox"/>	<input type="checkbox"/>
Methyl ethyl ketone	<input checked="" type="checkbox"/>	<input checked="" type="checkbox"/>	Methyl isobutyl ketone	<input checked="" type="checkbox"/>	<input checked="" type="checkbox"/>
p-Dichlorobenzene	<input checked="" type="checkbox"/>	<input checked="" type="checkbox"/>	Tetrachloroethene	<input checked="" type="checkbox"/>	<input type="checkbox"/>
Toluene	<input checked="" type="checkbox"/>	<input checked="" type="checkbox"/>	Trichloroethene	<input checked="" type="checkbox"/>	<input type="checkbox"/>
Xylenes	<input checked="" type="checkbox"/>	<input checked="" type="checkbox"/>			

**SITE NAME:** Trent Tube Division  
**LOCATION:** 141 Hammond Street  
Carrollton, Carroll County, GA 30117

Latitude 33° 35' 24 " N Longitude 85° 5' 39 " W

**ACREAGE** 36.25      **PARCEL NUMBER** C02-043-0003      **DATE LISTED** 2/15/2000

**LAST KNOWN PROPERTY OWNER:**  
BoMetals, Inc./BTR Properties, LLC  
303 Springs Industrial Dr.  
Powder Springs, GA 30073



**STATUS OF CLEANUP ACTIVITIES:**

Hazardous Site Response Act cleanup levels have been met for source materials and soil. Cleanup activities are being conducted for groundwater.

**CLEANUP PRIORITY:** The Director has designated this site as a Class II

**GA EPD DIRECTOR'S DETERMINATION REGARDING CORRECTIVE ACTION:**

Pending

**REGULATED SUBSTANCES RELEASED, AND THREATS TO HUMAN HEALTH AND ENVIRONMENT POSED BY THE RELEASE:**

This site has a known release of Nickel in groundwater at levels exceeding the reportable quantity. No human exposure via drinking water is suspected from this release. The nearest drinking water well is between 0.5 and 1 miles from the area affected by the release.

**REGULATED SUBSTANCES:**

Substance Name	GW	Soil	Substance Name	GW	Soil
Barium	<input checked="" type="checkbox"/>	<input type="checkbox"/>	Benzene	<input checked="" type="checkbox"/>	<input type="checkbox"/>
Chromium	<input checked="" type="checkbox"/>	<input checked="" type="checkbox"/>	Hydrofluoric acid	<input checked="" type="checkbox"/>	<input type="checkbox"/>
Mercury	<input checked="" type="checkbox"/>	<input type="checkbox"/>	Nickel	<input checked="" type="checkbox"/>	<input type="checkbox"/>
Nitric acid	<input checked="" type="checkbox"/>	<input checked="" type="checkbox"/>	Toluene	<input checked="" type="checkbox"/>	<input type="checkbox"/>
Trichloroethene	<input checked="" type="checkbox"/>	<input type="checkbox"/>			

**SITE NAME:** CSXT Depriest Signal Shop  
**LOCATION:** 641 East Liberty  
Savannah, Chatham County, GA 31401

Latitude 32° 4' 6" N Longitude 81° 5' 6" W

**ACREAGE** 13.37 **PARCEL NUMBER** 2-0033-12-001 **DATE LISTED** 2/10/2000

**LAST KNOWN PROPERTY OWNER:**

CSX Transportation, Inc.  
500 Water Street  
Jacksonville, FL 32202

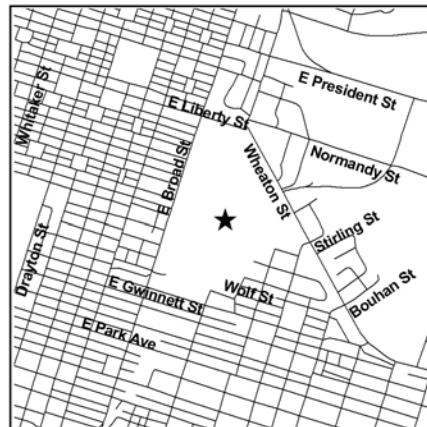

**STATUS OF CLEANUP ACTIVITIES:**

Cleanup activities are being conducted for source materials, soil, and groundwater.

**CLEANUP PRIORITY:** The Director has designated this site as a Class V

**GA EPD DIRECTOR'S DETERMINATION REGARDING CORRECTIVE ACTION:**

The Director has determined that this site requires corrective action.

**REGULATED SUBSTANCES RELEASED, AND THREATS TO HUMAN HEALTH AND ENVIRONMENT POSED BY THE RELEASE:**

This site has a release of Lead that exceeds a reportable quantity because it has the potential to contaminate groundwater. The nearest drinking water well is between 0.5 and 1 miles from the area affected by the release. This site has a known release of Lead in soil at levels exceeding the reportable quantity. This site has limited access. The nearest resident individual is between 301 and 1000 feet from the area affected by the release.

**REGULATED SUBSTANCES:**

Substance Name	GW	Soil	Substance Name	GW	Soil
Antimony	<input type="checkbox"/>	<input checked="" type="checkbox"/>	Arsenic	<input type="checkbox"/>	<input checked="" type="checkbox"/>
Barium	<input type="checkbox"/>	<input checked="" type="checkbox"/>	Benzo(a)pyrene	<input type="checkbox"/>	<input checked="" type="checkbox"/>
Benzo(a)pyrene	<input type="checkbox"/>	<input checked="" type="checkbox"/>	Benzo(b)fluoranthene	<input type="checkbox"/>	<input checked="" type="checkbox"/>
Benzo(k)fluoranthene	<input type="checkbox"/>	<input checked="" type="checkbox"/>	Cadmium	<input type="checkbox"/>	<input checked="" type="checkbox"/>
Chromium	<input type="checkbox"/>	<input checked="" type="checkbox"/>	Chrysene	<input type="checkbox"/>	<input checked="" type="checkbox"/>
Lead	<input type="checkbox"/>	<input checked="" type="checkbox"/>	Naphthalene	<input type="checkbox"/>	<input checked="" type="checkbox"/>
Silver	<input type="checkbox"/>	<input checked="" type="checkbox"/>			

**GEORGIA ENVIRONMENTAL PROTECTION DIVISION  
HAZARDOUS SITE INVENTORY**

Site Number **10612**

**SITE NAME:** Dettelbach Pesticide Warehouse Site  
**LOCATION:** 1251 Park Avenue  
Atlanta, Dekalb County, GA 30319

Latitude 33° 51' 42" N Longitude 84° 20' 15" W

<b>ACREAGE</b>	<b>PARCEL NUMBER</b>	<b>DATE LISTED</b>
1.1	D18-LL-241-Railroad right-of-way south	2/14/2000

**LAST KNOWN PROPERTY OWNER:**

Rollins, Inc./Attn: John Leach  
2170 Piedmont Road, NE  
Atlanta, GA 30324

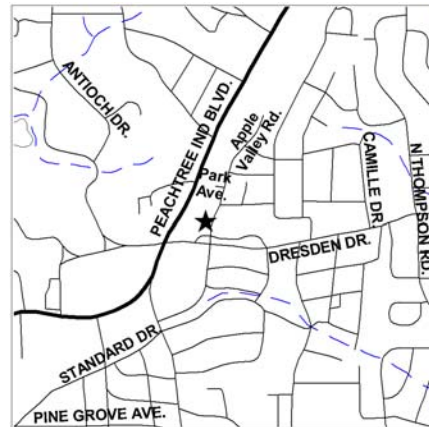

EPD received notification of a release to the following property(s), and determined on the indicated date that the property should be sublisted as part of this site.

PARCEL NAME	ACREAGE	PARCEL NUMBER	DATE LISTED
Apple Valley Associates	1.8	D18-LL-241 Parcels 3, 5, 7, 1	2/28/2000

**STATUS OF CLEANUP ACTIVITIES:**

Investigations are being conducted to determine how much cleanup is necessary for source materials, soil, and groundwater.

**CLEANUP PRIORITY:** The Director has designated this site as a Class II

**GA EPD DIRECTOR'S DETERMINATION REGARDING CORRECTIVE ACTION:**

Pending

**REGULATED SUBSTANCES RELEASED, AND THREATS TO HUMAN HEALTH AND ENVIRONMENT POSED BY THE RELEASE:**

This site has a known release of Dieldrin in soil at levels exceeding the reportable quantity. This site has unlimited access. The nearest resident individual is between 301 and 1000 feet from the area affected by the release.

**REGULATED SUBSTANCES:**

Substance Name	GW	Soil	Substance Name	GW	Soil
Aldrin	<input type="checkbox"/>	<input checked="" type="checkbox"/>	Chlordane	<input type="checkbox"/>	<input checked="" type="checkbox"/>
DDD	<input type="checkbox"/>	<input checked="" type="checkbox"/>	Dieldrin	<input type="checkbox"/>	<input checked="" type="checkbox"/>
Heptachlor	<input type="checkbox"/>	<input checked="" type="checkbox"/>	Heptachlor epoxide	<input type="checkbox"/>	<input checked="" type="checkbox"/>

**SITE NAME:** Legion Industries  
**LOCATION:** 370 Mills Road  
Waynesboro, Burke County, GA 30830

Latitude 33° 6' 07" N Longitude 82° 0' 27" W

**ACREAGE** 10.54 **PARCEL NUMBER** 073 022 **DATE LISTED** 3/14/2000

**LAST KNOWN PROPERTY OWNER:**

Legion Industries, Inc.  
P. O. Box 728  
Waynesboro, GA 30830-0728



**STATUS OF CLEANUP ACTIVITIES:**

Investigations are being conducted to determine how much cleanup is necessary for source materials, soil, and groundwater.

**CLEANUP PRIORITY:** The Director has designated this site as a Class II

**GA EPD DIRECTOR'S DETERMINATION REGARDING CORRECTIVE ACTION:**

Pending

**REGULATED SUBSTANCES RELEASED, AND THREATS TO HUMAN HEALTH AND ENVIRONMENT POSED BY THE RELEASE:**

This site has a known release of Vinyl chloride in groundwater at levels exceeding the reportable quantity. No human exposure via drinking water is suspected from this release. The nearest drinking water well is between 0.5 and 1 miles from the area affected by the release.

This site has a suspected release of Vinyl chloride in soil at levels exceeding the reportable quantity. This site has unlimited access. The nearest resident individual is between 1001 and 3000 feet from the area affected by the release.

**REGULATED SUBSTANCES:**

Substance Name	GW	Soil	Substance Name	GW	Soil
1,1-Dichloroethane	<input checked="" type="checkbox"/>	<input type="checkbox"/>	1,1-Dichloroethene	<input checked="" type="checkbox"/>	<input type="checkbox"/>
1,2,4-Trichlorobenzene	<input checked="" type="checkbox"/>	<input type="checkbox"/>	1,2-Dichlorobenzene	<input checked="" type="checkbox"/>	<input type="checkbox"/>
Aldrin	<input type="checkbox"/>	<input checked="" type="checkbox"/>	alpha-Benzenehexachloride	<input checked="" type="checkbox"/>	<input checked="" type="checkbox"/>
Barium	<input type="checkbox"/>	<input checked="" type="checkbox"/>	Benzene	<input checked="" type="checkbox"/>	<input type="checkbox"/>
beta-Benzenehexachloride	<input checked="" type="checkbox"/>	<input checked="" type="checkbox"/>	Chlordane	<input checked="" type="checkbox"/>	<input checked="" type="checkbox"/>
Chlorobenzene	<input type="checkbox"/>	<input checked="" type="checkbox"/>	Chlorobenzene	<input checked="" type="checkbox"/>	<input type="checkbox"/>
Chromium	<input type="checkbox"/>	<input checked="" type="checkbox"/>	Cis-1,2-Dichloroethene	<input checked="" type="checkbox"/>	<input checked="" type="checkbox"/>
Cumene	<input checked="" type="checkbox"/>	<input checked="" type="checkbox"/>	DDD	<input checked="" type="checkbox"/>	<input checked="" type="checkbox"/>
DDE	<input type="checkbox"/>	<input checked="" type="checkbox"/>	DDT	<input checked="" type="checkbox"/>	<input checked="" type="checkbox"/>
delta-Benzenehexachloride	<input checked="" type="checkbox"/>	<input checked="" type="checkbox"/>	Dichlorobenzene, N.O.S.	<input checked="" type="checkbox"/>	<input checked="" type="checkbox"/>
Dichloromethane	<input checked="" type="checkbox"/>	<input type="checkbox"/>	Dieldrin	<input checked="" type="checkbox"/>	<input checked="" type="checkbox"/>
Endrin	<input checked="" type="checkbox"/>	<input checked="" type="checkbox"/>	Ethylbenzene	<input type="checkbox"/>	<input checked="" type="checkbox"/>
Heptachlor	<input type="checkbox"/>	<input checked="" type="checkbox"/>	Heptachlor epoxide	<input type="checkbox"/>	<input checked="" type="checkbox"/>
Lead	<input type="checkbox"/>	<input checked="" type="checkbox"/>	Lindane	<input checked="" type="checkbox"/>	<input checked="" type="checkbox"/>
p-Dichlorobenzene	<input checked="" type="checkbox"/>	<input checked="" type="checkbox"/>	Tetrachloroethene	<input checked="" type="checkbox"/>	<input checked="" type="checkbox"/>
Toluene	<input type="checkbox"/>	<input checked="" type="checkbox"/>	Toxaphene	<input checked="" type="checkbox"/>	<input checked="" type="checkbox"/>
trans-1,2-Dichloroethene	<input checked="" type="checkbox"/>	<input type="checkbox"/>	Trichloroethene	<input checked="" type="checkbox"/>	<input checked="" type="checkbox"/>
Vinyl chloride	<input checked="" type="checkbox"/>	<input checked="" type="checkbox"/>	Xylenes	<input checked="" type="checkbox"/>	<input checked="" type="checkbox"/>

**GEORGIA ENVIRONMENTAL PROTECTION DIVISION  
HAZARDOUS SITE INVENTORY**

Site Number **10619**

**SITE NAME:** Georgia Pacific - Former Chlorate Plant, Brunswick

**LOCATION:** 1400 West Ninth Street  
Brunswick, Glynn County, GA 31520

Latitude 31° 10' 21 " N Longitude 81° 31' 0 " W

**ACREAGE** 650      **PARCEL NUMBER** 03-04993      **DATE LISTED** 3/16/2000

**LAST KNOWN PROPERTY OWNER:**

GP Cellulose, LLC  
133 Peachtree Street, NE  
Atlanta, GA 30303-1847



**STATUS OF CLEANUP ACTIVITIES:**

Cleanup activities are being conducted for source materials and groundwater. Hazardous Site Response Act cleanup levels have been met for soil.

**CLEANUP PRIORITY:** The Director has designated this site as a Class II

**GA EPD DIRECTOR'S DETERMINATION REGARDING CORRECTIVE ACTION:**

Pending

**REGULATED SUBSTANCES RELEASED, AND THREATS TO HUMAN HEALTH AND ENVIRONMENT POSED BY THE RELEASE:**

This site has a known release of Chromium in groundwater at levels exceeding the reportable quantity. No human exposure via drinking water is suspected from this release. The nearest drinking water well is less than 0.5 miles from the area affected by the release.

**REGULATED SUBSTANCES:**

Substance Name	GW	Soil	Substance Name	GW	Soil
2,4-Dimethylphenol	<input checked="" type="checkbox"/>	<input type="checkbox"/>	Acenaphthene	<input checked="" type="checkbox"/>	<input type="checkbox"/>
Acetone	<input checked="" type="checkbox"/>	<input type="checkbox"/>	Anthracene	<input checked="" type="checkbox"/>	<input type="checkbox"/>
Antimony	<input checked="" type="checkbox"/>	<input type="checkbox"/>	Arsenic	<input checked="" type="checkbox"/>	<input type="checkbox"/>
Barium	<input type="checkbox"/>	<input checked="" type="checkbox"/>	Benzene	<input checked="" type="checkbox"/>	<input type="checkbox"/>
Chromium	<input checked="" type="checkbox"/>	<input checked="" type="checkbox"/>	Copper	<input type="checkbox"/>	<input checked="" type="checkbox"/>
Fluoranthene	<input checked="" type="checkbox"/>	<input type="checkbox"/>	Lead	<input checked="" type="checkbox"/>	<input type="checkbox"/>
Mercury	<input type="checkbox"/>	<input checked="" type="checkbox"/>	Methyl ethyl ketone	<input checked="" type="checkbox"/>	<input type="checkbox"/>
m-Xylene	<input checked="" type="checkbox"/>	<input type="checkbox"/>	Naphthalene	<input checked="" type="checkbox"/>	<input type="checkbox"/>
Nickel	<input checked="" type="checkbox"/>	<input checked="" type="checkbox"/>	o-Xylene	<input checked="" type="checkbox"/>	<input type="checkbox"/>
Phenanthrene	<input checked="" type="checkbox"/>	<input type="checkbox"/>	Phenol	<input checked="" type="checkbox"/>	<input type="checkbox"/>
p-Xylene	<input checked="" type="checkbox"/>	<input type="checkbox"/>	Pyrene	<input checked="" type="checkbox"/>	<input type="checkbox"/>
Toluene	<input checked="" type="checkbox"/>	<input type="checkbox"/>	Zinc	<input checked="" type="checkbox"/>	<input checked="" type="checkbox"/>

**SITE NAME:** Cherokee Shopping Center  
**LOCATION:** 1966 Kissingbower Road  
Augusta, Richmond County, GA 30904

Latitude 33° 26' 24" N Longitude 82° 1' 26" W

**ACREAGE** 3.81      **PARCEL NUMBER** 086-1-056-00-0      **DATE LISTED** 4/21/2000

**LAST KNOWN PROPERTY OWNER:**  
Cherokee Property Partners, LLC  
P.O. Box 14670  
Savannah, GA 31416

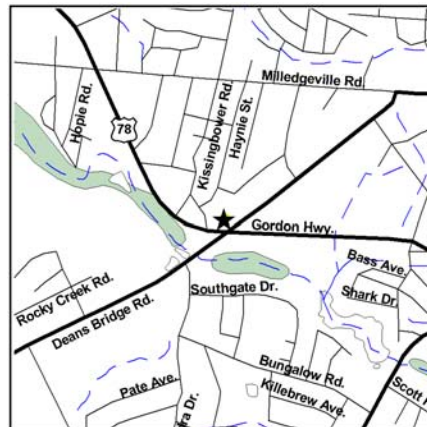

**STATUS OF CLEANUP ACTIVITIES:**

Cleanup activities are being conducted for source materials, soil, and groundwater.

**CLEANUP PRIORITY:** The Director has designated this site as a Class II

**GA EPD DIRECTOR'S DETERMINATION REGARDING CORRECTIVE ACTION:**  
Pending

**REGULATED SUBSTANCES RELEASED, AND THREATS TO HUMAN HEALTH AND ENVIRONMENT POSED BY THE RELEASE:**

This site has a known release of Vinyl chloride in groundwater at levels exceeding the reportable quantity. No human exposure via drinking water is suspected from this release. The nearest drinking water well is between 1 and 2 miles from the area affected by the release.

**REGULATED SUBSTANCES:**

Substance Name	GW	Soil	Substance Name	GW	Soil
1,1-Dichloroethene	<input checked="" type="checkbox"/>	<input type="checkbox"/>	Carbon disulfide	<input checked="" type="checkbox"/>	<input type="checkbox"/>
Chloroform	<input checked="" type="checkbox"/>	<input type="checkbox"/>	Cis-1,2-Dichloroethene	<input checked="" type="checkbox"/>	<input type="checkbox"/>
Tetrachloroethene	<input checked="" type="checkbox"/>	<input checked="" type="checkbox"/>	trans-1,2-Dichloroethene	<input checked="" type="checkbox"/>	<input type="checkbox"/>
Trichloroethene	<input checked="" type="checkbox"/>	<input type="checkbox"/>	Vinyl chloride	<input checked="" type="checkbox"/>	<input type="checkbox"/>

**SITE NAME:** Washington Manufacturing Company  
**LOCATION:** 308 East Montgomery Street  
Tennille, Washington County, GA 31089

Latitude 32° 56' 33" N Longitude 82° 48' 18" W

**ACREAGE** 8.6 **PARCEL NUMBER** T11 012 **DATE LISTED** 5/5/2000

**LAST KNOWN PROPERTY OWNER:**  
The Estate of Willie L. Langham  
c/o Ms. Beatrice Howell, Executrix  
202 Thomas Drive, Eatonton, GA 31024



**STATUS OF CLEANUP ACTIVITIES:**

Investigations are being conducted to determine how much cleanup is necessary for source materials, soil, and groundwater.

**CLEANUP PRIORITY:** The Director has designated this site as a Class I

**GA EPD DIRECTOR'S DETERMINATION REGARDING CORRECTIVE ACTION:**

The Director has determined that this site requires corrective action.

**REGULATED SUBSTANCES RELEASED, AND THREATS TO HUMAN HEALTH AND ENVIRONMENT POSED BY THE RELEASE:**

This site has a known release of Lead in groundwater at levels exceeding the reportable quantity. No human exposure via drinking water is suspected from this release. The nearest drinking water well is less than 0.5 miles from the area affected by the release.

This site has a known release of Lead in soil at levels exceeding the reportable quantity. This site has limited access. The nearest resident individual is less than 300 feet from the area affected by the release.

**REGULATED SUBSTANCES:**

Substance Name	GW	Soil	Substance Name	GW	Soil
Aroclor 1260	<input type="checkbox"/>	<input checked="" type="checkbox"/>	Arsenic	<input type="checkbox"/>	<input checked="" type="checkbox"/>
Barium	<input type="checkbox"/>	<input checked="" type="checkbox"/>	Benzo(a)anthracene	<input type="checkbox"/>	<input checked="" type="checkbox"/>
Benzo(a)anthracene	<input type="checkbox"/>	<input checked="" type="checkbox"/>	Benzo(a)pyrene	<input type="checkbox"/>	<input checked="" type="checkbox"/>
Benzo(b)fluoranthene	<input type="checkbox"/>	<input checked="" type="checkbox"/>	Cadmium	<input type="checkbox"/>	<input checked="" type="checkbox"/>
Chromium	<input type="checkbox"/>	<input checked="" type="checkbox"/>	Fluoranthene	<input type="checkbox"/>	<input checked="" type="checkbox"/>
Lead	<input checked="" type="checkbox"/>	<input checked="" type="checkbox"/>	Naphthalene	<input type="checkbox"/>	<input checked="" type="checkbox"/>
Nickel	<input type="checkbox"/>	<input checked="" type="checkbox"/>	Pyrene	<input type="checkbox"/>	<input checked="" type="checkbox"/>
Pyrene	<input type="checkbox"/>	<input checked="" type="checkbox"/>	Selenium	<input type="checkbox"/>	<input checked="" type="checkbox"/>



**SITE NAME:** St. Regis Wood Treating Site (Former)

**LOCATION:** GA Hwy. 94  
Fargo, Clinch County, GA 31631

Latitude 30° 41' 6" N Longitude 82° 33' 54" W

**ACREAGE** **PARCEL NUMBER**

1.11 F03 005C

**DATE LISTED**

6/5/2000

**LAST KNOWN PROPERTY OWNER:**

Tom Richardson / International Paper  
International Place III 6400 Poplar Ave, Tower #5 - 119  
Memphis, TN 38197

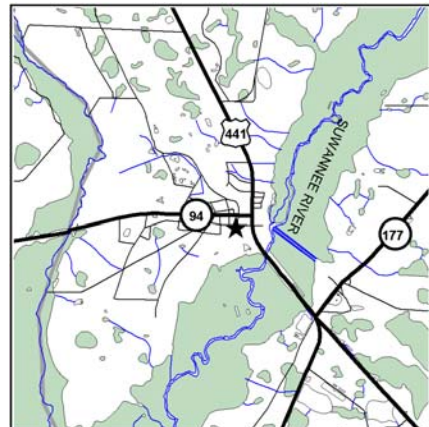

**STATUS OF CLEANUP ACTIVITIES:**

Cleanup activities are being conducted for source materials, soil, and groundwater.

**CLEANUP PRIORITY:** The Director has designated this site as a Class III

**GA EPD DIRECTOR'S DETERMINATION REGARDING CORRECTIVE ACTION:**

The Director has determined that this site requires corrective action.

**REGULATED SUBSTANCES RELEASED, AND THREATS TO HUMAN HEALTH AND ENVIRONMENT POSED BY THE RELEASE:**

This site has a known release of Pentachlorophenol in groundwater at levels exceeding the reportable quantity. No human exposure via drinking water is suspected from this release. The nearest drinking water well is less than 0.5 miles from the area affected by the release.

This site has a known release of Pentachlorophenol in soil at levels exceeding the reportable quantity. This site has unlimited access. The nearest resident individual is between 301 and 1000 feet from the area affected by the release.

**REGULATED SUBSTANCES:**

Substance Name	GW	Soil	Substance Name	GW	Soil
1,2-Dichlorobenzene	<input checked="" type="checkbox"/>	<input type="checkbox"/>	Acenaphthene	<input type="checkbox"/>	<input checked="" type="checkbox"/>
Benzene	<input checked="" type="checkbox"/>	<input checked="" type="checkbox"/>	Chrysene	<input type="checkbox"/>	<input checked="" type="checkbox"/>
Ethylbenzene	<input checked="" type="checkbox"/>	<input checked="" type="checkbox"/>	Fluorene	<input type="checkbox"/>	<input checked="" type="checkbox"/>
Naphthalene	<input checked="" type="checkbox"/>	<input checked="" type="checkbox"/>	Pentachlorophenol	<input checked="" type="checkbox"/>	<input checked="" type="checkbox"/>
Phenanthrene	<input type="checkbox"/>	<input checked="" type="checkbox"/>	Pyrene	<input type="checkbox"/>	<input checked="" type="checkbox"/>
Toluene	<input checked="" type="checkbox"/>	<input checked="" type="checkbox"/>	Xylenes	<input checked="" type="checkbox"/>	<input checked="" type="checkbox"/>

**SITE NAME:** Liberty Oil and Refining  
**LOCATION:** 312 East Yount Street  
Moultrie, Colquitt County, GA 31768

Latitude 31° 7' 48" N Longitude 83° 42' 25" W

**ACREAGE** 4      **PARCEL NUMBER** M009 005      **DATE LISTED** 5/11/2000

**LAST KNOWN PROPERTY OWNER:**

The Estate of Frances P. Toole  
508 Aumond Road  
Augusta, GA 30909



**STATUS OF CLEANUP ACTIVITIES:**

Cleanup activities are being conducted for source materials and soil. Investigations are being conducted to determine how much cleanup is necessary for groundwater.

**CLEANUP PRIORITY:** The Director has designated this site as a Class II

**GA EPD DIRECTOR'S DETERMINATION REGARDING CORRECTIVE ACTION:**

Pending

**REGULATED SUBSTANCES RELEASED, AND THREATS TO HUMAN HEALTH AND ENVIRONMENT POSED BY THE RELEASE:**

This site has a suspected release of Carbon disulfide in groundwater at levels exceeding the reportable quantity. No human exposure via drinking water is suspected from this release. The nearest drinking water well is less than 0.5 miles from the area affected by the release.

**REGULATED SUBSTANCES:**

Substance Name	GW	Soil	Substance Name	GW	Soil
Carbon disulfide	<input checked="" type="checkbox"/>	<input checked="" type="checkbox"/>			

**GEORGIA ENVIRONMENTAL PROTECTION DIVISION  
HAZARDOUS SITE INVENTORY**

Site Number **10628**

**SITE NAME:** Coastal Plains Treating Company

**LOCATION:** 812 E. Golden Road  
Tifton, Tift County, GA 31794

Latitude 31° 25' 48" N Longitude 83° 30' 14" W

**ACREAGE** **PARCEL NUMBER**

10.07 T061 012

**DATE LISTED**

6/23/2001

**LAST KNOWN PROPERTY OWNER:**

Mr. George Sumner  
1508 W Golden Road  
Tifton, GA 31793



**STATUS OF CLEANUP ACTIVITIES:**

Investigations are being conducted to determine how much cleanup is necessary for source materials, soil, and groundwater.

**CLEANUP PRIORITY:** The Director has designated this site as a Class II

**GA EPD DIRECTOR'S DETERMINATION REGARDING CORRECTIVE ACTION:**

Pending

**REGULATED SUBSTANCES RELEASED, AND THREATS TO HUMAN HEALTH AND ENVIRONMENT POSED BY THE RELEASE:**

This site has a known release of 2,4-Dichlorophenol in groundwater at levels exceeding the reportable quantity. No human exposure via drinking water is suspected from this release. The nearest drinking water well is less than 0.5 miles from the area affected by the release.

**REGULATED SUBSTANCES:**

Substance Name	GW	Soil	Substance Name	GW	Soil
1,2,4-Trichlorobenzene	<input checked="" type="checkbox"/>	<input type="checkbox"/>	2,4-Dichlorophenol	<input checked="" type="checkbox"/>	<input type="checkbox"/>
2,4-Dimethylphenol	<input checked="" type="checkbox"/>	<input type="checkbox"/>	2-Chloronaphthalene	<input checked="" type="checkbox"/>	<input type="checkbox"/>
Acenaphthene	<input checked="" type="checkbox"/>	<input type="checkbox"/>	Acenaphthylene	<input checked="" type="checkbox"/>	<input type="checkbox"/>
Anthracene	<input checked="" type="checkbox"/>	<input type="checkbox"/>	Arsenic	<input type="checkbox"/>	<input checked="" type="checkbox"/>
Barium	<input checked="" type="checkbox"/>	<input checked="" type="checkbox"/>	Cadmium	<input checked="" type="checkbox"/>	<input checked="" type="checkbox"/>
Chromium	<input type="checkbox"/>	<input checked="" type="checkbox"/>	Copper	<input checked="" type="checkbox"/>	<input checked="" type="checkbox"/>
Dibutyl phthalate	<input checked="" type="checkbox"/>	<input type="checkbox"/>	Dioxin	<input type="checkbox"/>	<input checked="" type="checkbox"/>
Fluoranthene	<input checked="" type="checkbox"/>	<input type="checkbox"/>	Fluorene	<input checked="" type="checkbox"/>	<input type="checkbox"/>
Lead	<input checked="" type="checkbox"/>	<input type="checkbox"/>	Naphthalene	<input checked="" type="checkbox"/>	<input type="checkbox"/>
o-Cresol	<input checked="" type="checkbox"/>	<input type="checkbox"/>	p-Cresol	<input checked="" type="checkbox"/>	<input type="checkbox"/>
Pentachlorophenol	<input type="checkbox"/>	<input checked="" type="checkbox"/>	Phenanthrene	<input checked="" type="checkbox"/>	<input checked="" type="checkbox"/>
Pyrene	<input checked="" type="checkbox"/>	<input type="checkbox"/>			

**SITE NAME:** Coats & Clark Inc.  
**LOCATION:** 525 West Doyle Street  
Toccoa, Stephens County, GA 30577

Latitude 34° 34' 44" N Longitude 83° 20' 16" W

**ACREAGE** 37.67      **PARCEL NUMBER** T10 005      **DATE LISTED** 8/18/2000

**LAST KNOWN PROPERTY OWNER:**  
Toccoa Renaissance c/o Christopher V. Woude, Partner  
1281 Georgia Road  
Franklin, NC 28734



**STATUS OF CLEANUP ACTIVITIES:**

Hazardous Site Response Act cleanup levels have been met for source materials and soil. Cleanup activities are being conducted for groundwater.

**CLEANUP PRIORITY:** The Director has designated this site as a Class V

**GA EPD DIRECTOR'S DETERMINATION REGARDING CORRECTIVE ACTION:**

The Director has determined that this site requires corrective action.

**REGULATED SUBSTANCES RELEASED, AND THREATS TO HUMAN HEALTH AND ENVIRONMENT POSED BY THE RELEASE:**

This site has a known release of Carbon tetrachloride in groundwater at levels exceeding the reportable quantity. No human exposure via drinking water is suspected from this release. The nearest drinking water well is between 0.5 and 1 miles from the area affected by the release.

**REGULATED SUBSTANCES:**

Substance Name	GW	Soil	Substance Name	GW	Soil
1,1,1-Trichloroethane	<input checked="" type="checkbox"/>	<input type="checkbox"/>	Carbon disulfide	<input checked="" type="checkbox"/>	<input type="checkbox"/>
Carbon tetrachloride	<input checked="" type="checkbox"/>	<input checked="" type="checkbox"/>	Chloroform	<input checked="" type="checkbox"/>	<input type="checkbox"/>
Cis-1,2-Dichloroethene	<input checked="" type="checkbox"/>	<input type="checkbox"/>	Tetrachloroethene	<input checked="" type="checkbox"/>	<input type="checkbox"/>
Trichloroethene	<input checked="" type="checkbox"/>	<input type="checkbox"/>	Zinc	<input checked="" type="checkbox"/>	<input type="checkbox"/>

**SITE NAME:** Del Cook Lumber Company  
**LOCATION:** West 9th Street  
Adel, Cook County, GA 31610

Latitude 31° 7' 41" N Longitude 83° 25' 42" W

**ACREAGE** 86.38      **PARCEL NUMBER** 0040D-004      **DATE LISTED** 9/19/2000

**LAST KNOWN PROPERTY OWNER:**  
Del Cook Lumber Company  
4370 Peachtree Road NE, 5th Floor  
Atlanta, GA 30319

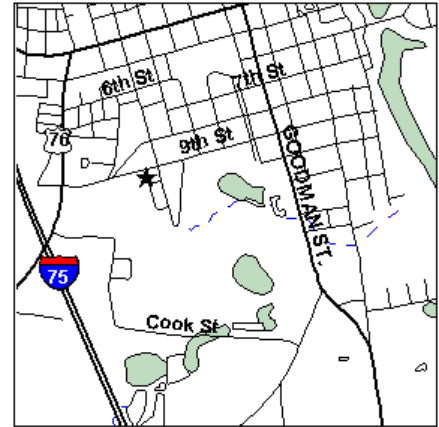

**STATUS OF CLEANUP ACTIVITIES:**

Hazardous Site Response Act cleanup levels have been met for source materials and soil. Cleanup activities are being conducted for groundwater.

**CLEANUP PRIORITY:** The Director has designated this site as a Class II

**GA EPD DIRECTOR'S DETERMINATION REGARDING CORRECTIVE ACTION:**  
Pending

**REGULATED SUBSTANCES RELEASED, AND THREATS TO HUMAN HEALTH AND ENVIRONMENT POSED BY THE RELEASE:**

This site has a known release of Pentachlorophenol in groundwater at levels exceeding the reportable quantity. No human exposure via drinking water is suspected from this release. The nearest drinking water well is between 0.5 and 1 miles from the area affected by the release.

**REGULATED SUBSTANCES:**

Substance Name	GW	Soil	Substance Name	GW	Soil
Acetone	<input checked="" type="checkbox"/>	<input type="checkbox"/>	Benzene	<input checked="" type="checkbox"/>	<input type="checkbox"/>
Benzoic acid	<input checked="" type="checkbox"/>	<input type="checkbox"/>	Naphthalene	<input checked="" type="checkbox"/>	<input type="checkbox"/>
Pentachlorophenol	<input checked="" type="checkbox"/>	<input checked="" type="checkbox"/>	Phenol	<input checked="" type="checkbox"/>	<input type="checkbox"/>
Toluene	<input checked="" type="checkbox"/>	<input type="checkbox"/>			

**GEORGIA ENVIRONMENTAL PROTECTION DIVISION  
HAZARDOUS SITE INVENTORY**

Site Number **10636**

**SITE NAME:** One Hour Martinizing  
**LOCATION:** 2070 Beaver Ruin Road  
Norcross, Gwinnett County, GA 30071

Latitude 33° 56' 24 " N Longitude 84° 10' 48 " W

**ACREAGE** 1 **PARCEL NUMBER** 6213023 **DATE LISTED** 9/25/2000

**LAST KNOWN PROPERTY OWNER:**

RS Beaver Ruin Center, LLC  
5995 Nelson Road  
Longmont, CO 80503

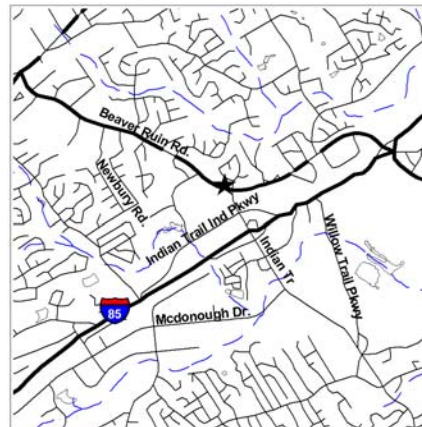

EPD received notification of a release to the following property(s), and determined on the indicated date that the property should be sublisted as part of this site.

PARCEL NAME	ACREAGE	PARCEL NUMBER	DATE LISTED
Vacant Lot - 2078 Beaver Ruin Road	1.23	6213078	9/25/2000

**STATUS OF CLEANUP ACTIVITIES:**

Investigations are being conducted to determine how much cleanup is necessary for source materials, soil, and groundwater.

**CLEANUP PRIORITY:** The Director has designated this site as a Class II

**GA EPD DIRECTOR'S DETERMINATION REGARDING CORRECTIVE ACTION:**

Pending

**REGULATED SUBSTANCES RELEASED, AND THREATS TO HUMAN HEALTH AND ENVIRONMENT POSED BY THE RELEASE:**

This site has a known release of Tetrachloroethene in groundwater at levels exceeding the reportable quantity. No human exposure via drinking water is suspected from this release. The nearest drinking water well is between 0.5 and 1 miles from the area affected by the release.

**REGULATED SUBSTANCES:**

Substance Name	GW	Soil	Substance Name	GW	Soil
Tetrachloroethene	<input checked="" type="checkbox"/>	<input type="checkbox"/>			

**GEORGIA ENVIRONMENTAL PROTECTION DIVISION  
HAZARDOUS SITE INVENTORY**

Site Number **10637**

**SITE NAME:** Welcome Years, Inc.  
**LOCATION:** 1115 Howell Mill Road  
Atlanta, Fulton County, GA 30318

Latitude 33° 47' 6" N Longitude 84° 24' 38" W

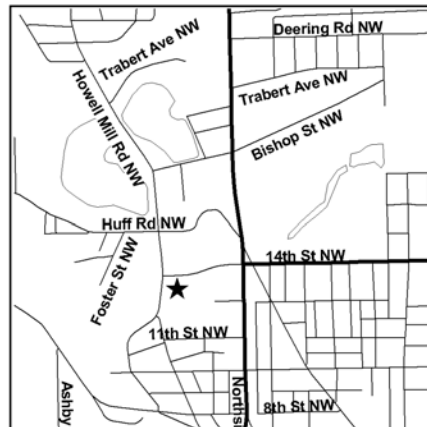

ACREAGE	PARCEL NUMBER	DATE LISTED
0.8923	17-0150-0009-014-4	9/18/2000
0.905	17-0150-0009-071-4	9/18/2000
5.29	17-0150-0009-076-3	9/18/2000
0.7025	17-0150-0009-062-3	9/18/2000
1045	17-0150-0009-013-6	9/18/2000
3.21	17-0150-0009-064-9	9/18/2000
0.2445	17-0150-0009-061-5	9/18/2000

**LAST KNOWN PROPERTY OWNER:**

VLP2, LLC / c/o Patrick J. McKenna, Registered Agent  
221 Uncle Heinie Way NW, Room 305  
Atlanta, GA 30332-0207

Iron Works International Inc. c/o Angelo Viale, Registered Agent  
1085 Howell Mill Road NW  
Atlanta, Ga 30318

**STATUS OF CLEANUP ACTIVITIES:**

Cleanup activities are being conducted for source materials, soil, and groundwater.

**CLEANUP PRIORITY:** The Director has designated this site as a Class I

**GA EPD DIRECTOR'S DETERMINATION REGARDING CORRECTIVE ACTION:**

The Director has determined that this site requires corrective action.

**REGULATED SUBSTANCES RELEASED, AND THREATS TO HUMAN HEALTH AND ENVIRONMENT POSED BY THE RELEASE:**

This site has a known release of Lead in soil at levels exceeding the reportable quantity. This site has limited access. The nearest resident individual is between 301 and 1000 feet from the area affected by the release.

**REGULATED SUBSTANCES:**

Substance Name	GW	Soil	Substance Name	GW	Soil
Arsenic	<input type="checkbox"/>	<input checked="" type="checkbox"/>	Barium	<input checked="" type="checkbox"/>	<input checked="" type="checkbox"/>
Benzene	<input checked="" type="checkbox"/>	<input type="checkbox"/>	Cadmium	<input type="checkbox"/>	<input checked="" type="checkbox"/>
Chromium	<input type="checkbox"/>	<input checked="" type="checkbox"/>	Ethylbenzene	<input checked="" type="checkbox"/>	<input checked="" type="checkbox"/>
Lead	<input type="checkbox"/>	<input checked="" type="checkbox"/>	Naphthalene	<input checked="" type="checkbox"/>	<input checked="" type="checkbox"/>
Tetrachloroethene	<input checked="" type="checkbox"/>	<input type="checkbox"/>	Toluene	<input checked="" type="checkbox"/>	<input checked="" type="checkbox"/>
Xylenes	<input checked="" type="checkbox"/>	<input checked="" type="checkbox"/>			

**GEORGIA ENVIRONMENTAL PROTECTION DIVISION  
HAZARDOUS SITE INVENTORY**

Site Number **10639**

**SITE NAME:** Spalding Corners Shopping Center  
**LOCATION:** 7700 Spalding Drive  
Norcross, Fulton County, GA 30092

Latitude 33° 58' 3" N Longitude 84° 15' 40" W

**ACREAGE** 8.63      **PARCEL NUMBER** 06-0313 LL-009-1      **DATE LISTED** 12/18/2000

**LAST KNOWN PROPERTY OWNER:**  
Selig Enterprises, Inc.  
1100 Spring Street, NW, Suite 550  
Atlanta, GA 30309-2848



EPD received notification of a release to the following property(s), and determined on the indicated date that the property should be sublisted as part of this site.

PARCEL NAME	ACREAGE	PARCEL NUMBER	DATE LISTED
Dunwoody Place Venture LLC (Jim Cowart Inc.)	10.99	06-0313-LL-034-9	4/12/2001

**STATUS OF CLEANUP ACTIVITIES:**

Hazardous Site Response Act cleanup levels have been met for source materials and soil. Cleanup activities are being conducted for groundwater.

**CLEANUP PRIORITY:** The Director has designated this site as a Class V

**GA EPD DIRECTOR'S DETERMINATION REGARDING CORRECTIVE ACTION:**

The Director has determined that this site requires corrective action.

**REGULATED SUBSTANCES RELEASED, AND THREATS TO HUMAN HEALTH AND ENVIRONMENT POSED BY THE RELEASE:**

This site has a known release of Tetrachloroethene in groundwater at levels exceeding the reportable quantity. No human exposure via drinking water is suspected from this release. The nearest drinking water well is between 0.5 and 1 miles from the area affected by the release.

**REGULATED SUBSTANCES:**

Substance Name	GW	Soil	Substance Name	GW	Soil
Chloroform	<input checked="" type="checkbox"/>	<input type="checkbox"/>	Cis-1,2-Dichloroethene	<input checked="" type="checkbox"/>	<input type="checkbox"/>
Tetrachloroethene	<input checked="" type="checkbox"/>	<input checked="" type="checkbox"/>	Trichloroethene	<input checked="" type="checkbox"/>	<input type="checkbox"/>



**SITE NAME:** K & D Cleaners  
**LOCATION:** 2114 Lumpkin Road  
Augusta, Richmond County, GA 30906

Latitude 33° 25' 7" N Longitude 82° 1' 27" W

**ACREAGE** 0.18      **PARCEL NUMBER** 110-1-028-01-0      **DATE LISTED** 12/15/2000

**LAST KNOWN PROPERTY OWNER:**

Margaret Richards  
2712 Fleming Drive  
Augusta, GA 30906

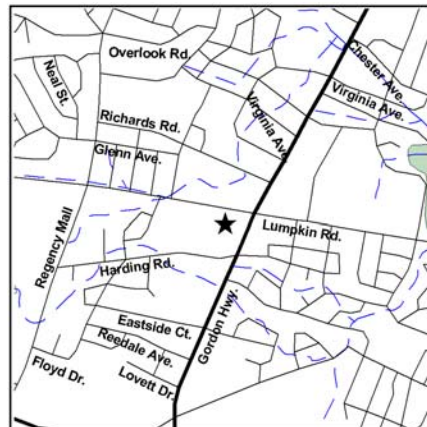

**STATUS OF CLEANUP ACTIVITIES:**

Investigations are being conducted to determine how much cleanup is necessary for source materials, soil, and groundwater.

**CLEANUP PRIORITY:** The Director has designated this site as a Class II

**GA EPD DIRECTOR'S DETERMINATION REGARDING CORRECTIVE ACTION:**

Pending

**REGULATED SUBSTANCES RELEASED, AND THREATS TO HUMAN HEALTH AND ENVIRONMENT POSED BY THE RELEASE:**

This site has a known release of Tetrachloroethene in groundwater at levels exceeding the reportable quantity. This release has resulted in suspected human exposure.

**REGULATED SUBSTANCES:**

Substance Name	GW	Soil	Substance Name	GW	Soil
Cis-1,2-Dichloroethene	<input checked="" type="checkbox"/>	<input type="checkbox"/>	Tetrachloroethene	<input checked="" type="checkbox"/>	<input checked="" type="checkbox"/>
Trichloroethene	<input checked="" type="checkbox"/>	<input type="checkbox"/>			

**GEORGIA ENVIRONMENTAL PROTECTION DIVISION  
HAZARDOUS SITE INVENTORY**

Site Number **10641**

**SITE NAME:** Kerr McGee Pigments, Inc.  
**LOCATION:** 1 Kerr McGee Road  
Savannah, Chatham County, GA 31402

Latitude 32° 5' 0" N Longitude 81° 1' 21" W

**ACREAGE** 1459.74 **PARCEL NUMBER** 1-0122-01-001 **DATE LISTED** 10/18/2000

**LAST KNOWN PROPERTY OWNER:**

Tronox, LLC  
1201 Lake Robbins Drive  
Spring, TX 77380

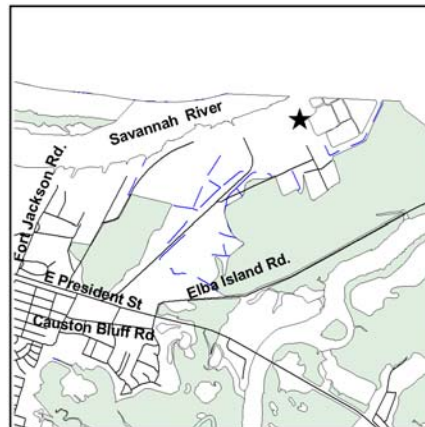

**STATUS OF CLEANUP ACTIVITIES:**

EPD has not yet directed the responsible parties to begin investigation or cleanup under the Hazardous Site Response Act for source materials, soil, and groundwater.

**CLEANUP PRIORITY:** The Director has designated this site as a Class II

**GA EPD DIRECTOR'S DETERMINATION REGARDING CORRECTIVE ACTION:**

Pending

**REGULATED SUBSTANCES RELEASED, AND THREATS TO HUMAN HEALTH AND ENVIRONMENT POSED BY THE RELEASE:**

This site has a known release of Vinyl chloride in groundwater at levels exceeding the reportable quantity. No human exposure via drinking water is suspected from this release. The nearest drinking water well is between 1 and 2 miles from the area affected by the release.

**REGULATED SUBSTANCES:**

Substance Name	GW	Soil	Substance Name	GW	Soil
1,1-Dichloroethane	<input checked="" type="checkbox"/>	<input type="checkbox"/>	1,1-Dichloroethene	<input checked="" type="checkbox"/>	<input type="checkbox"/>
Acenaphthene	<input checked="" type="checkbox"/>	<input type="checkbox"/>	Acetone	<input checked="" type="checkbox"/>	<input type="checkbox"/>
Arsenic	<input checked="" type="checkbox"/>	<input type="checkbox"/>	Barium	<input checked="" type="checkbox"/>	<input type="checkbox"/>
Cadmium	<input checked="" type="checkbox"/>	<input type="checkbox"/>	Chromium	<input checked="" type="checkbox"/>	<input checked="" type="checkbox"/>
Cis-1,2-Dichloroethene	<input checked="" type="checkbox"/>	<input type="checkbox"/>	Copper	<input checked="" type="checkbox"/>	<input type="checkbox"/>
Fluorene	<input checked="" type="checkbox"/>	<input type="checkbox"/>	Lead	<input checked="" type="checkbox"/>	<input checked="" type="checkbox"/>
Naphthalene	<input checked="" type="checkbox"/>	<input type="checkbox"/>	Nickel	<input checked="" type="checkbox"/>	<input type="checkbox"/>
Tetrachloroethene	<input checked="" type="checkbox"/>	<input type="checkbox"/>	trans-1,2-Dichloroethene	<input checked="" type="checkbox"/>	<input type="checkbox"/>
Trichloroethene	<input checked="" type="checkbox"/>	<input type="checkbox"/>	Vinyl chloride	<input checked="" type="checkbox"/>	<input type="checkbox"/>
Zinc	<input checked="" type="checkbox"/>	<input type="checkbox"/>			

**GEORGIA ENVIRONMENTAL PROTECTION DIVISION  
HAZARDOUS SITE INVENTORY**

Site Number **10642**

**SITE NAME:** Bartow County - SR 294 Emerson Landfill

**LOCATION:** SR 294 (Allatoona Dam Road)  
Emerson, Bartow County, GA 30137

Latitude 34° 8' 38" N      Longitude 84° 45' 46" W

**ACREAGE**      **PARCEL NUMBER**

295.31      0093-0690-001

**DATE LISTED**

1/24/2001

**LAST KNOWN PROPERTY OWNER:**

Bartow County  
135 W. Cherokee Ave., Suite 251  
Cartersville, GA 30120



**STATUS OF CLEANUP ACTIVITIES:**

Cleanup activities are being conducted for source materials and groundwater.

**CLEANUP PRIORITY:** The Director has designated this site as a Class IV

**GA EPD DIRECTOR'S DETERMINATION REGARDING CORRECTIVE ACTION:**

The Director has determined that this site requires corrective action.

**REGULATED SUBSTANCES RELEASED, AND THREATS TO HUMAN HEALTH AND ENVIRONMENT POSED BY THE RELEASE:**

This site has a known release of Vinyl chloride in groundwater at levels exceeding the reportable quantity. No human exposure via drinking water is suspected from this release. The nearest drinking water well is between 0.5 and 1 miles from the area affected by the release.

**REGULATED SUBSTANCES:**

Substance Name	GW	Soil	Substance Name	GW	Soil
Barium	<input checked="" type="checkbox"/>	<input type="checkbox"/>	Mercury	<input checked="" type="checkbox"/>	<input type="checkbox"/>
Vinyl chloride	<input checked="" type="checkbox"/>	<input type="checkbox"/>			

**SITE NAME:** Berrien County Landfill  
**LOCATION:** CR28 & CR48  
Nashville, Berrien County, GA 31639

Latitude 31° 7' 40" N Longitude 83° 14' 19" W

**ACREAGE** 57.13      **PARCEL NUMBER** 057 31 001      **DATE LISTED** 1/24/2001

**LAST KNOWN PROPERTY OWNER:**  
Berrien Co. Resource Recovery Dev. Authority  
105 E. Washington Ave., P. O. Box 446  
Nashville, GA 31639

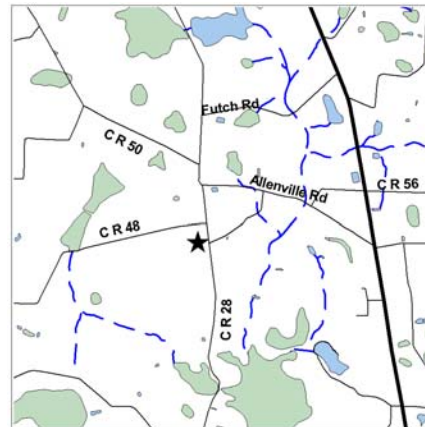

**STATUS OF CLEANUP ACTIVITIES:**

Cleanup activities are being conducted for source materials and groundwater.

**CLEANUP PRIORITY:** The Director has designated this site as a Class IV

**GA EPD DIRECTOR'S DETERMINATION REGARDING CORRECTIVE ACTION:**

The Director has determined that this site requires corrective action.

**REGULATED SUBSTANCES RELEASED, AND THREATS TO HUMAN HEALTH AND ENVIRONMENT POSED BY THE RELEASE:**

This site has a known release of 1,1-Dichloroethane in groundwater at levels exceeding the reportable quantity. No human exposure via drinking water is suspected from this release. The nearest drinking water well is less than 0.5 miles from the area affected by the release.

**REGULATED SUBSTANCES:**

Substance Name	GW	Soil	Substance Name	GW	Soil
1,1-Dichloroethane	<input checked="" type="checkbox"/>	<input type="checkbox"/>	Arsenic	<input checked="" type="checkbox"/>	<input type="checkbox"/>
Barium	<input checked="" type="checkbox"/>	<input type="checkbox"/>	Benzene	<input checked="" type="checkbox"/>	<input type="checkbox"/>
Chlorobenzene	<input checked="" type="checkbox"/>	<input type="checkbox"/>	Chloroethane	<input checked="" type="checkbox"/>	<input type="checkbox"/>
Cis-1,2-Dichloroethene	<input checked="" type="checkbox"/>	<input type="checkbox"/>	p-Dichlorobenzene	<input checked="" type="checkbox"/>	<input type="checkbox"/>
Zinc	<input checked="" type="checkbox"/>	<input type="checkbox"/>			

**SITE NAME:** Quitman - SR 333 Landfill  
**LOCATION:** SR - 333  
Quitman, Brooks County, GA 31643

Latitude 30° 45' 7" N Longitude 83° 32' 51" W



ACREAGE	PARCEL NUMBER	DATE LISTED
35	096 0003	1/24/2001
3.48	096 0001B	1/24/2001
16.5	096 0016	1/24/2001
5.5	096 0004A	1/24/2001

**LAST KNOWN PROPERTY OWNER:**

Brooks County  
P. O. Box 272  
Quitman, GA 31643

**STATUS OF CLEANUP ACTIVITIES:**

Cleanup activities are being conducted for source materials and groundwater.

**CLEANUP PRIORITY:** The Director has designated this site as a Class IV

**GA EPD DIRECTOR'S DETERMINATION REGARDING CORRECTIVE ACTION:**

The Director has determined that this site requires corrective action.

**REGULATED SUBSTANCES RELEASED, AND THREATS TO HUMAN HEALTH AND ENVIRONMENT POSED BY THE RELEASE:**

This site has a known release of Vinyl chloride in groundwater at levels exceeding the reportable quantity. No human exposure via drinking water is suspected from this release. The nearest drinking water well is less than 0.5 miles from the area affected by the release.

**REGULATED SUBSTANCES:**

Substance Name	GW	Soil	Substance Name	GW	Soil
Acetone	<input checked="" type="checkbox"/>	<input type="checkbox"/>	Antimony	<input checked="" type="checkbox"/>	<input type="checkbox"/>
Barium	<input checked="" type="checkbox"/>	<input type="checkbox"/>	Benzene	<input checked="" type="checkbox"/>	<input type="checkbox"/>
Chlorobenzene	<input checked="" type="checkbox"/>	<input type="checkbox"/>	Chromium	<input checked="" type="checkbox"/>	<input type="checkbox"/>
Cis-1,2-Dichloroethene	<input checked="" type="checkbox"/>	<input type="checkbox"/>	Diethyl phthalate	<input checked="" type="checkbox"/>	<input type="checkbox"/>
Lead	<input checked="" type="checkbox"/>	<input type="checkbox"/>	Mercury	<input checked="" type="checkbox"/>	<input type="checkbox"/>
Selenium	<input checked="" type="checkbox"/>	<input type="checkbox"/>	Tetrachloroethene	<input checked="" type="checkbox"/>	<input type="checkbox"/>
Trichloroethene	<input checked="" type="checkbox"/>	<input type="checkbox"/>	Vinyl chloride	<input checked="" type="checkbox"/>	<input type="checkbox"/>

**SITE NAME:** Bryan County - US 280 Mill Creek MSWLF  
**LOCATION:** 7392 E. Highway 280  
Pembroke, Bryan County, GA 31321

Latitude 32° 9' 12" N Longitude 81° 30' 35" W

**ACREAGE** 26.97      **PARCEL NUMBER** 0261 014      **DATE LISTED** 1/24/2001

**LAST KNOWN PROPERTY OWNER:**

Bryan County  
P. O. Box 430  
Pembroke, GA 31321

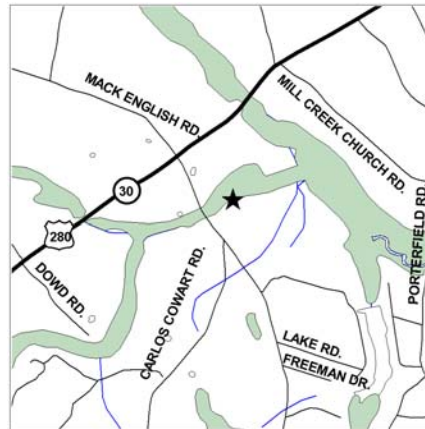

**STATUS OF CLEANUP ACTIVITIES:**

Cleanup activities are being conducted for source materials and groundwater.

**CLEANUP PRIORITY:** The Director has designated this site as a Class IV

**GA EPD DIRECTOR'S DETERMINATION REGARDING CORRECTIVE ACTION:**

The Director has determined that this site requires corrective action.

**REGULATED SUBSTANCES RELEASED, AND THREATS TO HUMAN HEALTH AND ENVIRONMENT POSED BY THE RELEASE:**

This site has a known release of Lead in groundwater at levels exceeding the reportable quantity. No human exposure via drinking water is suspected from this release. The nearest drinking water well is less than 0.5 miles from the area affected by the release.

**REGULATED SUBSTANCES:**

Substance Name	GW	Soil	Substance Name	GW	Soil
Antimony	<input checked="" type="checkbox"/>	<input type="checkbox"/>	bis(2-Ethylhexyl) phthalate	<input checked="" type="checkbox"/>	<input type="checkbox"/>
Cis-1,2-Dichloroethene	<input checked="" type="checkbox"/>	<input type="checkbox"/>	Dichloromethane	<input checked="" type="checkbox"/>	<input type="checkbox"/>
Lead	<input checked="" type="checkbox"/>	<input type="checkbox"/>	Nickel	<input checked="" type="checkbox"/>	<input type="checkbox"/>
p-Dichlorobenzene	<input checked="" type="checkbox"/>	<input type="checkbox"/>	Vinyl chloride	<input checked="" type="checkbox"/>	<input type="checkbox"/>

**SITE NAME:** Camden County Vacuna Road LF  
**LOCATION:** Vacuna Road  
Kingsland, Camden County, GA 31548

Latitude 30° 46' 52" N Longitude 81° 41' 24" W

**ACREAGE** 19.7      **PARCEL NUMBER** 083 031A      **DATE LISTED** 1/24/2001

**LAST KNOWN PROPERTY OWNER:**

Camden County  
200 East Fourth Street  
Woodbine, GA 31569



**STATUS OF CLEANUP ACTIVITIES:**

Cleanup activities are being conducted for source materials and groundwater.

**CLEANUP PRIORITY:** The Director has designated this site as a Class IV

**GA EPD DIRECTOR'S DETERMINATION REGARDING CORRECTIVE ACTION:**

The Director has determined that this site requires corrective action.

**REGULATED SUBSTANCES RELEASED, AND THREATS TO HUMAN HEALTH AND ENVIRONMENT POSED BY THE RELEASE:**

This site has a known release of Vinyl chloride in groundwater at levels exceeding the reportable quantity. No human exposure via drinking water is suspected from this release. The nearest drinking water well is less than 0.5 miles from the area affected by the release.

**REGULATED SUBSTANCES:**

Substance Name	GW	Soil	Substance Name	GW	Soil
Arsenic	<input checked="" type="checkbox"/>	<input type="checkbox"/>	Barium	<input checked="" type="checkbox"/>	<input type="checkbox"/>
Benzene	<input checked="" type="checkbox"/>	<input type="checkbox"/>	Cadmium	<input checked="" type="checkbox"/>	<input type="checkbox"/>
p-Dichlorobenzene	<input checked="" type="checkbox"/>	<input type="checkbox"/>	Vinyl chloride	<input checked="" type="checkbox"/>	<input type="checkbox"/>

**SITE NAME:** Carroll County / Carrollton SR 166 LF  
**LOCATION:** State Road 166 (Simonton Mill Road)  
Carrollton, Carroll County, GA 30117

Latitude 33° 33' 4" N Longitude 85° 9' 13" W

**ACREAGE** 125.72      **PARCEL NUMBER** 060-113      **DATE LISTED** 1/24/2001

**LAST KNOWN PROPERTY OWNER:**  
Carroll County Solid Waste Management Authority  
439 Simonton Mill Road  
Carrollton, GA 30117

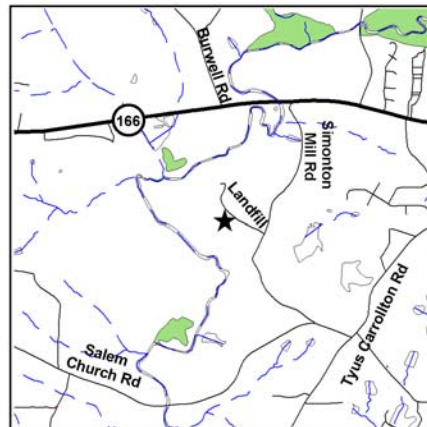

**STATUS OF CLEANUP ACTIVITIES:**

Cleanup activities are being conducted for source materials and groundwater.

**CLEANUP PRIORITY:** The Director has designated this site as a Class IV

**GA EPD DIRECTOR'S DETERMINATION REGARDING CORRECTIVE ACTION:**

The Director has determined that this site requires corrective action.

**REGULATED SUBSTANCES RELEASED, AND THREATS TO HUMAN HEALTH AND ENVIRONMENT POSED BY THE RELEASE:**

This site has a known release of Cadmium in groundwater at levels exceeding the reportable quantity. No human exposure via drinking water is suspected from this release. The nearest drinking water well is between 1 and 2 miles from the area affected by the release.

**REGULATED SUBSTANCES:**

Substance Name	GW	Soil	Substance Name	GW	Soil
1,1-Dichloroethane	<input checked="" type="checkbox"/>	<input type="checkbox"/>	1,2-Dichloroethane	<input checked="" type="checkbox"/>	<input type="checkbox"/>
Antimony	<input checked="" type="checkbox"/>	<input type="checkbox"/>	Barium	<input checked="" type="checkbox"/>	<input type="checkbox"/>
Benzene	<input checked="" type="checkbox"/>	<input type="checkbox"/>	bis(2-Ethylhexyl) phthalate	<input checked="" type="checkbox"/>	<input type="checkbox"/>
Cadmium	<input checked="" type="checkbox"/>	<input type="checkbox"/>	Carbon disulfide	<input checked="" type="checkbox"/>	<input type="checkbox"/>
Chlorobenzene	<input checked="" type="checkbox"/>	<input type="checkbox"/>	Chloroethane	<input checked="" type="checkbox"/>	<input type="checkbox"/>
Cis-1,2-Dichloroethene	<input checked="" type="checkbox"/>	<input type="checkbox"/>	Cobalt {reference only, not regulated substance}	<input checked="" type="checkbox"/>	<input type="checkbox"/>
Dichlorodifluoromethane	<input checked="" type="checkbox"/>	<input type="checkbox"/>	Dichloromethane	<input checked="" type="checkbox"/>	<input type="checkbox"/>
Mercury	<input checked="" type="checkbox"/>	<input type="checkbox"/>	Methyl isobutyl ketone	<input checked="" type="checkbox"/>	<input type="checkbox"/>
Nickel	<input checked="" type="checkbox"/>	<input type="checkbox"/>	p-Dichlorobenzene	<input checked="" type="checkbox"/>	<input type="checkbox"/>
Zinc	<input checked="" type="checkbox"/>	<input type="checkbox"/>			



**SITE NAME:** Chatham County Landfill  
**LOCATION:** Dean Forest Road  
Savannah, Chatham County, GA 31405

Latitude 32° 3' 29" N Longitude 81° 12' 53" W

**ACREAGE** 457.3      **PARCEL NUMBER** 2-0990-01-009A      **DATE LISTED** 1/24/2001

**LAST KNOWN PROPERTY OWNER:**  
City of Savannah  
124 Bull Street, Suite 210, P. O. Box 8161  
Savannah, GA 31412

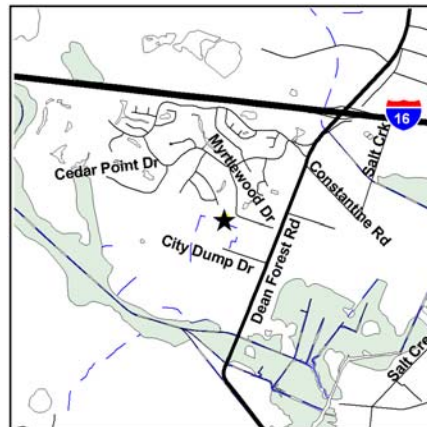

**STATUS OF CLEANUP ACTIVITIES:**

Cleanup activities are being conducted for source materials and groundwater.

**CLEANUP PRIORITY:** The Director has designated this site as a Class IV

**GA EPD DIRECTOR'S DETERMINATION REGARDING CORRECTIVE ACTION:**

The Director has determined that this site requires corrective action.

**REGULATED SUBSTANCES RELEASED, AND THREATS TO HUMAN HEALTH AND ENVIRONMENT POSED BY THE RELEASE:**

This site has a known release of Cadmium in groundwater at levels exceeding the reportable quantity. No human exposure via drinking water is suspected from this release. The nearest drinking water well is less than 0.5 miles from the area affected by the release.

**REGULATED SUBSTANCES:**

Substance Name	GW	Soil	Substance Name	GW	Soil
Antimony	<input checked="" type="checkbox"/>	<input type="checkbox"/>	Arsenic	<input checked="" type="checkbox"/>	<input type="checkbox"/>
Barium	<input checked="" type="checkbox"/>	<input type="checkbox"/>	Beryllium	<input checked="" type="checkbox"/>	<input type="checkbox"/>
Cadmium	<input checked="" type="checkbox"/>	<input type="checkbox"/>	Cobalt (reference only, not regulated substance)	<input checked="" type="checkbox"/>	<input type="checkbox"/>
Lead	<input checked="" type="checkbox"/>	<input type="checkbox"/>	Nickel	<input checked="" type="checkbox"/>	<input type="checkbox"/>

**SITE NAME:** Cherokee County - Blalock Road Landfill  
**LOCATION:** Blalock Road  
Holly Springs, Cherokee County, GA 30115

Latitude 34° 8' 56" N Longitude 84° 29' 2" W

**ACREAGE** 220      **PARCEL NUMBER** 15N21035      **DATE LISTED** 1/24/2001

**LAST KNOWN PROPERTY OWNER:**

Cherokee County  
1130 Bluffs Parkway  
Canton, GA 30114



**STATUS OF CLEANUP ACTIVITIES:**

Cleanup activities are being conducted for source materials and groundwater.

**CLEANUP PRIORITY:** The Director has designated this site as a Class IV

**GA EPD DIRECTOR'S DETERMINATION REGARDING CORRECTIVE ACTION:**

The Director has determined that this site requires corrective action.

**REGULATED SUBSTANCES RELEASED, AND THREATS TO HUMAN HEALTH AND ENVIRONMENT POSED BY THE RELEASE:**

This site has a known release of Vinyl chloride in groundwater at levels exceeding the reportable quantity. This release has resulted in known human exposure greater than or equal to the MCL for Vinyl chloride.

**REGULATED SUBSTANCES:**

Substance Name	GW	Soil	Substance Name	GW	Soil
1,1-Dichloroethane	<input checked="" type="checkbox"/>	<input type="checkbox"/>	1,1-Dichloroethene	<input checked="" type="checkbox"/>	<input type="checkbox"/>
Benzene	<input checked="" type="checkbox"/>	<input type="checkbox"/>	Chloroethane	<input checked="" type="checkbox"/>	<input type="checkbox"/>
Cis-1,2-Dichloroethene	<input checked="" type="checkbox"/>	<input type="checkbox"/>	Dichlorodifluoromethane	<input checked="" type="checkbox"/>	<input type="checkbox"/>
Dichloromethane	<input checked="" type="checkbox"/>	<input type="checkbox"/>	Ethylbenzene	<input checked="" type="checkbox"/>	<input type="checkbox"/>
Tetrachloroethene	<input checked="" type="checkbox"/>	<input type="checkbox"/>	Toluene	<input checked="" type="checkbox"/>	<input type="checkbox"/>
Trichloroethene	<input checked="" type="checkbox"/>	<input type="checkbox"/>	Trichlorofluoromethane	<input checked="" type="checkbox"/>	<input type="checkbox"/>
Vinyl chloride	<input checked="" type="checkbox"/>	<input type="checkbox"/>	Xylenes	<input checked="" type="checkbox"/>	<input type="checkbox"/>

**SITE NAME:** Coffee County Landfill  
**LOCATION:** Landen Road (CR 129) and SR 206  
Douglas, Coffee County, GA 31533

Latitude 31° 34' 21 " N Longitude 82° 53' 44 " W

**ACREAGE** 502.87 **PARCEL NUMBER** 0095 072A **DATE LISTED** 1/24/2001

**LAST KNOWN PROPERTY OWNER:**

Coffee County  
109 S. Peterson Avenue  
Douglas, GA 31533

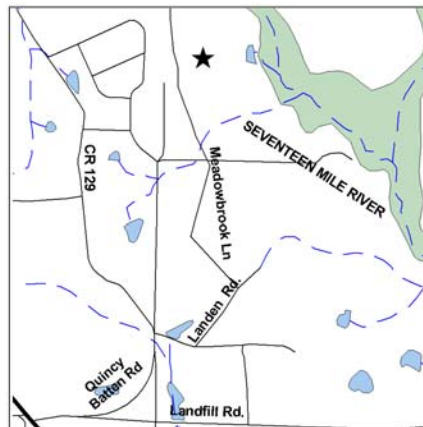

**STATUS OF CLEANUP ACTIVITIES:**

Cleanup activities are being conducted for source materials and groundwater.

**CLEANUP PRIORITY:** The Director has designated this site as a Class IV

**GA EPD DIRECTOR'S DETERMINATION REGARDING CORRECTIVE ACTION:**

The Director has determined that this site requires corrective action.

**REGULATED SUBSTANCES RELEASED, AND THREATS TO HUMAN HEALTH AND ENVIRONMENT POSED BY THE RELEASE:**

This site has a known release of Tetrachloroethene in groundwater at levels exceeding the reportable quantity. No human exposure via drinking water is suspected from this release. The nearest drinking water well is less than 0.5 miles from the area affected by the release.

**REGULATED SUBSTANCES:**

Substance Name	GW	Soil	Substance Name	GW	Soil
1,1-Dichloroethane	<input checked="" type="checkbox"/>	<input type="checkbox"/>	Cis-1,2-Dichloroethene	<input checked="" type="checkbox"/>	<input type="checkbox"/>
Tetrachloroethene	<input checked="" type="checkbox"/>	<input type="checkbox"/>			

**SITE NAME:** Columbia County - Baker Place Road MSWLF

**LOCATION:** 590 Baker Place Road  
Grovetown, Columbia County, GA 30813

Latitude 33° 29' 21 " N Longitude 82° 13' 44 " W

**ACREAGE** 154      **PARCEL NUMBER** 051 001      **DATE LISTED** 1/24/2001

**LAST KNOWN PROPERTY OWNER:**

Columbia County  
P. O. Box 498  
Evans, GA 30809



**STATUS OF CLEANUP ACTIVITIES:**

Cleanup activities are being conducted for source materials and groundwater.

**CLEANUP PRIORITY:** The Director has designated this site as a Class IV

**GA EPD DIRECTOR'S DETERMINATION REGARDING CORRECTIVE ACTION:**

The Director has determined that this site requires corrective action.

**REGULATED SUBSTANCES RELEASED, AND THREATS TO HUMAN HEALTH AND ENVIRONMENT POSED BY THE RELEASE:**

This site has a known release of Vinyl chloride in groundwater at levels exceeding the reportable quantity. No human exposure via drinking water is suspected from this release. The nearest drinking water well is between 1 and 2 miles from the area affected by the release.

**REGULATED SUBSTANCES:**

Substance Name	GW	Soil	Substance Name	GW	Soil
1,1-Dichloroethane	<input checked="" type="checkbox"/>	<input type="checkbox"/>	Barium	<input checked="" type="checkbox"/>	<input type="checkbox"/>
Benzene	<input checked="" type="checkbox"/>	<input type="checkbox"/>	Cis-1,2-Dichloroethene	<input checked="" type="checkbox"/>	<input type="checkbox"/>
Dichloromethane	<input checked="" type="checkbox"/>	<input type="checkbox"/>	Ethylbenzene	<input checked="" type="checkbox"/>	<input type="checkbox"/>
Mercury	<input checked="" type="checkbox"/>	<input type="checkbox"/>	p-Dichlorobenzene	<input checked="" type="checkbox"/>	<input type="checkbox"/>
Tetrachloroethene	<input checked="" type="checkbox"/>	<input type="checkbox"/>	Toluene	<input checked="" type="checkbox"/>	<input type="checkbox"/>
Trichloroethene	<input checked="" type="checkbox"/>	<input type="checkbox"/>	Vinyl chloride	<input checked="" type="checkbox"/>	<input type="checkbox"/>
Xylenes	<input checked="" type="checkbox"/>	<input type="checkbox"/>			

**SITE NAME:** Dawson County Shoal Hole Road MSWLF  
**LOCATION:** 946 Burt Creek Road  
Dawsonville, Dawson County, GA 30534

Latitude 34° 26' 19" N Longitude 84° 7' 11" W

ACREAGE	PARCEL NUMBER	DATE LISTED
33.25	092 001 002	1/24/2001
26.92	091 057	1/24/2001

**LAST KNOWN PROPERTY OWNER:**

Dawson County  
78 Howard Avenue East, Suite 100  
Dawsonville, GA 30534

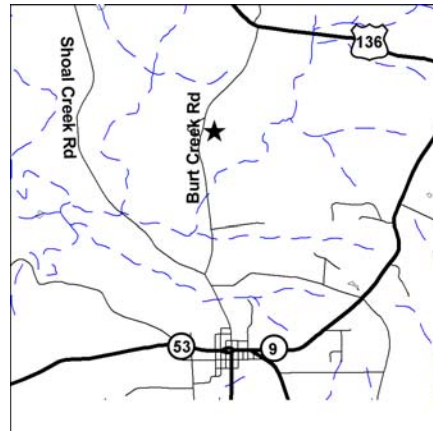

**STATUS OF CLEANUP ACTIVITIES:**

Cleanup activities are being conducted for source materials and groundwater.

**CLEANUP PRIORITY:** The Director has designated this site as a Class IV

**GA EPD DIRECTOR'S DETERMINATION REGARDING CORRECTIVE ACTION:**

The Director has determined that this site requires corrective action.

**REGULATED SUBSTANCES RELEASED, AND THREATS TO HUMAN HEALTH AND ENVIRONMENT POSED BY THE RELEASE:**

This site has a known release of Tetrachloroethene in groundwater at levels exceeding the reportable quantity. No human exposure via drinking water is suspected from this release. The nearest drinking water well is less than 0.5 miles from the area affected by the release.

**REGULATED SUBSTANCES:**

Substance Name	GW	Soil	Substance Name	GW	Soil
Chloroethane	<input checked="" type="checkbox"/>	<input type="checkbox"/>	Cis-1,2-Dichloroethene	<input checked="" type="checkbox"/>	<input type="checkbox"/>
Dichloromethane	<input checked="" type="checkbox"/>	<input type="checkbox"/>	Tetrachloroethene	<input checked="" type="checkbox"/>	<input type="checkbox"/>
Trichloroethene	<input checked="" type="checkbox"/>	<input type="checkbox"/>	Xylenes	<input checked="" type="checkbox"/>	<input type="checkbox"/>

**SITE NAME:** Dooly County - CR 101 MSWLF  
**LOCATION:** CR 101  
Vienna, Dooly County, GA 31092

Latitude 32° 7' 32" N Longitude 83° 50' 50" W

**ACREAGE** 27.92    **PARCEL NUMBER** 44 20    **DATE LISTED** 1/24/2001

**LAST KNOWN PROPERTY OWNER:**

Dooly County Commissioners  
P. O. Box 348  
Vienna, GA 31092



**STATUS OF CLEANUP ACTIVITIES:**

Cleanup activities are being conducted for source materials and groundwater.

**CLEANUP PRIORITY:** The Director has designated this site as a Class IV

**GA EPD DIRECTOR'S DETERMINATION REGARDING CORRECTIVE ACTION:**

The Director has determined that this site requires corrective action.

**REGULATED SUBSTANCES RELEASED, AND THREATS TO HUMAN HEALTH AND ENVIRONMENT POSED BY THE RELEASE:**

This site has a known release of Nickel in groundwater at levels exceeding the reportable quantity. No human exposure via drinking water is suspected from this release. The nearest drinking water well is less than 0.5 miles from the area affected by the release.

**REGULATED SUBSTANCES:**

Substance Name	GW	Soil	Substance Name	GW	Soil
Barium	<input checked="" type="checkbox"/>	<input type="checkbox"/>	Cis-1,2-Dichloroethene	<input checked="" type="checkbox"/>	<input type="checkbox"/>
Nickel	<input checked="" type="checkbox"/>	<input type="checkbox"/>			

**SITE NAME:** Douglas County Landfill - Cedar Mt/Worthan Rd Phase 1

**LOCATION:** Cedar Mountain / Worthan Road  
Douglasville, Douglas County, GA 30134

Latitude 33° 45' 56" N Longitude 84° 48' 39" W

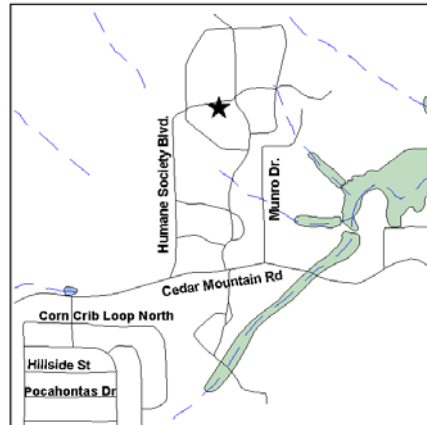

ACREAGE	PARCEL NUMBER	DATE LISTED
35.15	02190250003	1/24/2001
141.43	01980250001	1/24/2001

**LAST KNOWN PROPERTY OWNER:**

Douglas County  
8700 Hospital Drive  
Douglasville, GA 30134

**STATUS OF CLEANUP ACTIVITIES:**

Cleanup activities are being conducted for source materials and groundwater.

**CLEANUP PRIORITY:** The Director has designated this site as a Class IV

**GA EPD DIRECTOR'S DETERMINATION REGARDING CORRECTIVE ACTION:**

The Director has determined that this site requires corrective action.

**REGULATED SUBSTANCES RELEASED, AND THREATS TO HUMAN HEALTH AND ENVIRONMENT POSED BY THE RELEASE:**

This site has a known release of Tetrachloroethene in groundwater at levels exceeding the reportable quantity. No human exposure via drinking water is suspected from this release. The nearest drinking water well is between 0.5 and 1 miles from the area affected by the release.

**REGULATED SUBSTANCES:**

Substance Name	GW	Soil	Substance Name	GW	Soil
1,1-Dichloroethane	<input checked="" type="checkbox"/>	<input type="checkbox"/>	Barium	<input checked="" type="checkbox"/>	<input type="checkbox"/>
Benzene	<input checked="" type="checkbox"/>	<input type="checkbox"/>	Chloroethane	<input checked="" type="checkbox"/>	<input type="checkbox"/>
Chromium	<input checked="" type="checkbox"/>	<input type="checkbox"/>	Cis-1,2-Dichloroethene	<input checked="" type="checkbox"/>	<input type="checkbox"/>
Dichloromethane	<input checked="" type="checkbox"/>	<input type="checkbox"/>	Tetrachloroethene	<input checked="" type="checkbox"/>	<input type="checkbox"/>
Toluene	<input checked="" type="checkbox"/>	<input type="checkbox"/>	Trichloroethene	<input checked="" type="checkbox"/>	<input type="checkbox"/>
Vinyl chloride	<input checked="" type="checkbox"/>	<input type="checkbox"/>	Xylenes	<input checked="" type="checkbox"/>	<input type="checkbox"/>
Zinc	<input checked="" type="checkbox"/>	<input type="checkbox"/>			

**SITE NAME:** Blakely - Howell Street / Pit Road MSWLF

**LOCATION:** Corner of Howell Street and Pit Road  
Blakely, Early County, GA 31723

Latitude 31° 24' 2" N Longitude 84° 55' 44" W

**ACREAGE**    **PARCEL NUMBER**

30.52    B024A14003

**DATE LISTED**

1/24/2001

**LAST KNOWN PROPERTY OWNER:**

City of Blakely and Early County  
P. O. Box 350  
Blakely, GA 31723  
  
Early County Board of Commissioners  
17 McDonald Street, P. O. Box 693  
Blakely, GA 39823



**STATUS OF CLEANUP ACTIVITIES:**

Cleanup activities are being conducted for source materials and groundwater.

**CLEANUP PRIORITY:** The Director has designated this site as a Class IV

**GA EPD DIRECTOR'S DETERMINATION REGARDING CORRECTIVE ACTION:**

The Director has determined that this site requires corrective action.

**REGULATED SUBSTANCES RELEASED, AND THREATS TO HUMAN HEALTH AND ENVIRONMENT POSED BY THE RELEASE:**

This site has a known release of Vinyl chloride in groundwater at levels exceeding the reportable quantity. No human exposure via drinking water is suspected from this release. The nearest drinking water well is between 1 and 2 miles from the area affected by the release.

**REGULATED SUBSTANCES:**

Substance Name	GW	Soil	Substance Name	GW	Soil
Benzene	<input checked="" type="checkbox"/>	<input type="checkbox"/>	Chlorobenzene	<input checked="" type="checkbox"/>	<input type="checkbox"/>
Vinyl chloride	<input checked="" type="checkbox"/>	<input type="checkbox"/>			



**SITE NAME:** Elbert County Landfill  
**LOCATION:** Hulmes Chapel Road  
Elberton, Elbert County, GA 30635

Latitude 34° 8' 6" N Longitude 82° 46' 51" W

**ACREAGE** 88.79      **PARCEL NUMBER** 051 059      **DATE LISTED** 1/24/2001

**LAST KNOWN PROPERTY OWNER:**

Elbert County  
10 W. Church Street  
Elberton, GA 30635

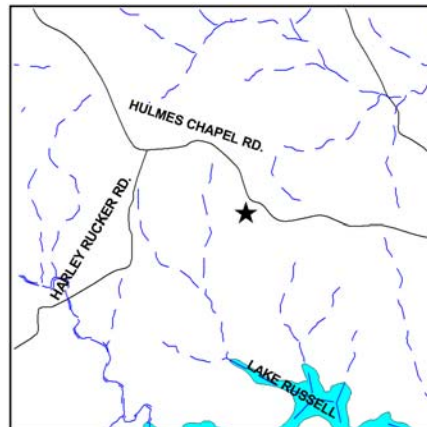

**STATUS OF CLEANUP ACTIVITIES:**

Cleanup activities are being conducted for source materials and groundwater.

**CLEANUP PRIORITY:** The Director has designated this site as a Class IV

**GA EPD DIRECTOR'S DETERMINATION REGARDING CORRECTIVE ACTION:**

The Director has determined that this site requires corrective action.

**REGULATED SUBSTANCES RELEASED, AND THREATS TO HUMAN HEALTH AND ENVIRONMENT POSED BY THE RELEASE:**

This site has a known release of Mercury in groundwater at levels exceeding the reportable quantity. No human exposure via drinking water is suspected from this release. The nearest drinking water well is between 0.5 and 1 miles from the area affected by the release.

**REGULATED SUBSTANCES:**

Substance Name	GW	Soil	Substance Name	GW	Soil
1,1-Dichloroethane	<input checked="" type="checkbox"/>	<input type="checkbox"/>	Benzene	<input checked="" type="checkbox"/>	<input type="checkbox"/>
Cis-1,2-Dichloroethene	<input checked="" type="checkbox"/>	<input type="checkbox"/>	Dichloromethane	<input checked="" type="checkbox"/>	<input type="checkbox"/>
Ethylbenzene	<input checked="" type="checkbox"/>	<input type="checkbox"/>	Mercury	<input checked="" type="checkbox"/>	<input type="checkbox"/>
p-Dichlorobenzene	<input checked="" type="checkbox"/>	<input type="checkbox"/>	Tetrachloroethene	<input checked="" type="checkbox"/>	<input type="checkbox"/>
Trichloroethene	<input checked="" type="checkbox"/>	<input type="checkbox"/>	Vinyl chloride	<input checked="" type="checkbox"/>	<input type="checkbox"/>
Xylenes	<input checked="" type="checkbox"/>	<input type="checkbox"/>	Zinc	<input checked="" type="checkbox"/>	<input type="checkbox"/>

**SITE NAME:** Emanuel County Landfill  
**LOCATION:** SR 297  
Swainsboro, Emanuel County, GA 30401

Latitude 32° 30' 59" N Longitude 82° 19' 58" W

**ACREAGE** 84      **PARCEL NUMBER** 079 003      **DATE LISTED** 1/24/2001

**LAST KNOWN PROPERTY OWNER:**

Emanuel County  
101 North Main  
Swainsboro, GA 30401



**STATUS OF CLEANUP ACTIVITIES:**

Cleanup activities are being conducted for source materials and groundwater.

**CLEANUP PRIORITY:** The Director has designated this site as a Class IV

**GA EPD DIRECTOR'S DETERMINATION REGARDING CORRECTIVE ACTION:**

The Director has determined that this site requires corrective action.

**REGULATED SUBSTANCES RELEASED, AND THREATS TO HUMAN HEALTH AND ENVIRONMENT POSED BY THE RELEASE:**

This site has a known release of Vinyl chloride in groundwater at levels exceeding the reportable quantity. No human exposure via drinking water is suspected from this release. The nearest drinking water well is between 1 and 2 miles from the area affected by the release.

**REGULATED SUBSTANCES:**

Substance Name	GW	Soil	Substance Name	GW	Soil
Barium	<input checked="" type="checkbox"/>	<input type="checkbox"/>	Beryllium	<input checked="" type="checkbox"/>	<input type="checkbox"/>
Vinyl chloride	<input checked="" type="checkbox"/>	<input type="checkbox"/>	Zinc	<input checked="" type="checkbox"/>	<input type="checkbox"/>

**SITE NAME:** Fannin County Landfill  
**LOCATION:** SR 5 and Tom Boyd Road  
Blue Ridge, Fannin County, GA 30513

Latitude 34° 53' 55" N Longitude 84° 20' 59" W

<b>ACREAGE</b>	<b>PARCEL NUMBER</b>	<b>DATE LISTED</b>
52.9	0051 106	1/24/2001
4.5	0051 106B	

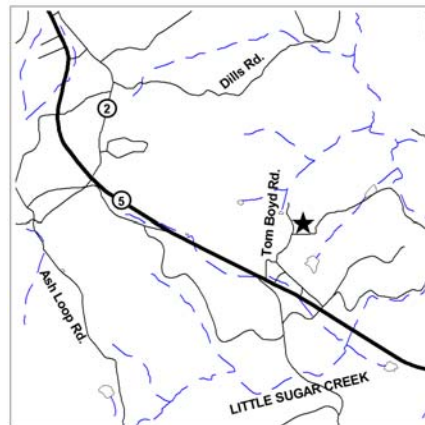

**LAST KNOWN PROPERTY OWNER:**

Pearl Pinson  
Route 1 Box 1146  
Blue Ridge, GA 30513  
  
Rudy Roach  
48 River Street, Suite F  
Hiawassee, GA 30546

**STATUS OF CLEANUP ACTIVITIES:**

Cleanup activities are being conducted for source materials and groundwater.

**CLEANUP PRIORITY:** The Director has designated this site as a Class IV

**GA EPD DIRECTOR'S DETERMINATION REGARDING CORRECTIVE ACTION:**

The Director has determined that this site requires corrective action.

**REGULATED SUBSTANCES RELEASED, AND THREATS TO HUMAN HEALTH AND ENVIRONMENT POSED BY THE RELEASE:**

This site has a known release of Dichloromethane in groundwater at levels exceeding the reportable quantity. No human exposure via drinking water is suspected from this release. The nearest drinking water well is less than 0.5 miles from the area affected by the release.

**REGULATED SUBSTANCES:**

Substance Name	GW	Soil	Substance Name	GW	Soil
1,1-Dichloroethane	<input checked="" type="checkbox"/>	<input type="checkbox"/>	Acetone	<input checked="" type="checkbox"/>	<input type="checkbox"/>
Barium	<input checked="" type="checkbox"/>	<input type="checkbox"/>	Benzene	<input checked="" type="checkbox"/>	<input type="checkbox"/>
Beryllium	<input checked="" type="checkbox"/>	<input type="checkbox"/>	Cis-1,2-Dichloroethene	<input checked="" type="checkbox"/>	<input type="checkbox"/>
Cobalt {reference only, not regulated substance}	<input checked="" type="checkbox"/>	<input type="checkbox"/>	Dichloromethane	<input checked="" type="checkbox"/>	<input type="checkbox"/>
Mercury	<input checked="" type="checkbox"/>	<input type="checkbox"/>	Nickel	<input checked="" type="checkbox"/>	<input type="checkbox"/>
p-Dichlorobenzene	<input checked="" type="checkbox"/>	<input type="checkbox"/>	Vinyl chloride	<input checked="" type="checkbox"/>	<input type="checkbox"/>
Zinc	<input checked="" type="checkbox"/>	<input type="checkbox"/>			

**SITE NAME:** Franklin County - Harrison Bridge Road MSWLF

**LOCATION:** Harrison Bridge Road  
Carnesville, Franklin County, GA 30521

Latitude 34° 20' 31 " N Longitude 83° 13' 41 " W

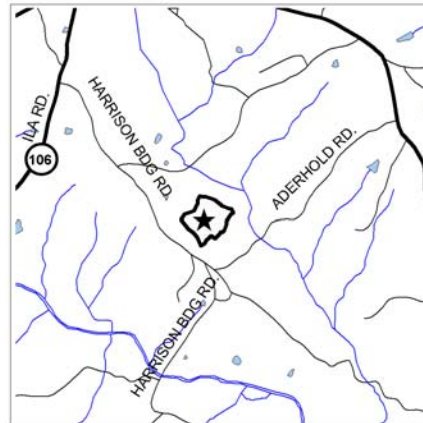

<b>ACREAGE</b>	<b>PARCEL NUMBER</b>	<b>DATE LISTED</b>
80.49	037 046A	1/24/2001
13	037 034A	1/24/2001

**LAST KNOWN PROPERTY OWNER:**

Franklin County  
141 Athens Street, P. O. Box 159  
Carnesville, GA 30521

**STATUS OF CLEANUP ACTIVITIES:**

Cleanup activities are being conducted for source materials and groundwater.

**CLEANUP PRIORITY:** The Director has designated this site as a Class IV

**GA EPD DIRECTOR'S DETERMINATION REGARDING CORRECTIVE ACTION:**

The Director has determined that this site requires corrective action.

**REGULATED SUBSTANCES RELEASED, AND THREATS TO HUMAN HEALTH AND ENVIRONMENT POSED BY THE RELEASE:**

This site has a known release of Dichloromethane in groundwater at levels exceeding the reportable quantity. No human exposure via drinking water is suspected from this release. The nearest drinking water well is less than 0.5 miles from the area affected by the release.

**REGULATED SUBSTANCES:**

Substance Name	GW	Soil	Substance Name	GW	Soil
1,1-Dichloroethane	<input checked="" type="checkbox"/>	<input type="checkbox"/>	1,1-Dichloroethene	<input checked="" type="checkbox"/>	<input type="checkbox"/>
1,2-Dichlorobenzene	<input checked="" type="checkbox"/>	<input type="checkbox"/>	2,4-Dichlorophenoxyacetic acid, salts and esters	<input checked="" type="checkbox"/>	<input type="checkbox"/>
alpha-Benzenehexachloride	<input checked="" type="checkbox"/>	<input type="checkbox"/>	Barium	<input checked="" type="checkbox"/>	<input type="checkbox"/>
Benzene	<input checked="" type="checkbox"/>	<input type="checkbox"/>	Cadmium	<input checked="" type="checkbox"/>	<input type="checkbox"/>
Chlorobenzene	<input checked="" type="checkbox"/>	<input type="checkbox"/>	Chloroethane	<input checked="" type="checkbox"/>	<input type="checkbox"/>
Cis-1,2-Dichloroethene	<input checked="" type="checkbox"/>	<input type="checkbox"/>	Cobalt {reference only, not regulated substance}	<input checked="" type="checkbox"/>	<input type="checkbox"/>
Dichlorodifluoromethane	<input checked="" type="checkbox"/>	<input type="checkbox"/>	Dichloromethane	<input checked="" type="checkbox"/>	<input type="checkbox"/>
p-Dichlorobenzene	<input checked="" type="checkbox"/>	<input type="checkbox"/>	Tetrachloroethene	<input checked="" type="checkbox"/>	<input type="checkbox"/>
Trichloroethene	<input checked="" type="checkbox"/>	<input type="checkbox"/>	Trichlorofluoromethane	<input checked="" type="checkbox"/>	<input type="checkbox"/>
Xylenes	<input checked="" type="checkbox"/>	<input type="checkbox"/>	Zinc	<input checked="" type="checkbox"/>	<input type="checkbox"/>

**SITE NAME:** Fulton County Landfill  
**LOCATION:** Merk / Miles Road  
Atlanta, Fulton County, GA 30349

Latitude 33° 40' 9" N Longitude 84° 33' 56" W

**ACREAGE** 153.32      **PARCEL NUMBER** 14F-0102-LL-0037      **DATE LISTED** 1/24/2001

**LAST KNOWN PROPERTY OWNER:**

Fulton County  
141 Prior Street, Suite 6001  
Atlanta, GA 30303

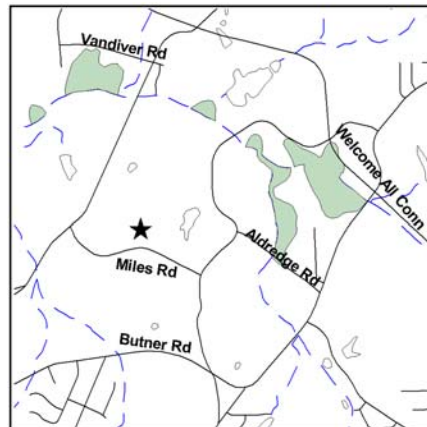

**STATUS OF CLEANUP ACTIVITIES:**

Cleanup activities are being conducted for source materials and groundwater.

**CLEANUP PRIORITY:** The Director has designated this site as a Class IV

**GA EPD DIRECTOR'S DETERMINATION REGARDING CORRECTIVE ACTION:**

The Director has determined that this site requires corrective action.

**REGULATED SUBSTANCES RELEASED, AND THREATS TO HUMAN HEALTH AND ENVIRONMENT POSED BY THE RELEASE:**

This site has a known release of Vinyl chloride in groundwater at levels exceeding the reportable quantity. No human exposure via drinking water is suspected from this release. The nearest drinking water well is less than 0.5 miles from the area affected by the release.

**REGULATED SUBSTANCES:**

Substance Name	GW	Soil	Substance Name	GW	Soil
1,1,1-Trichloroethane	<input checked="" type="checkbox"/>	<input type="checkbox"/>	1,1-Dichloroethane	<input checked="" type="checkbox"/>	<input type="checkbox"/>
1,1-Dichloroethene	<input checked="" type="checkbox"/>	<input type="checkbox"/>	Barium	<input checked="" type="checkbox"/>	<input type="checkbox"/>
Benzene	<input checked="" type="checkbox"/>	<input type="checkbox"/>	Chloroethane	<input checked="" type="checkbox"/>	<input type="checkbox"/>
Chloroform	<input checked="" type="checkbox"/>	<input type="checkbox"/>	Chromium	<input checked="" type="checkbox"/>	<input type="checkbox"/>
Cis-1,2-Dichloroethene	<input checked="" type="checkbox"/>	<input type="checkbox"/>	Copper	<input checked="" type="checkbox"/>	<input type="checkbox"/>
Dichloromethane	<input checked="" type="checkbox"/>	<input type="checkbox"/>	Tetrachloroethene	<input checked="" type="checkbox"/>	<input type="checkbox"/>
Toluene	<input checked="" type="checkbox"/>	<input type="checkbox"/>	Trichloroethene	<input checked="" type="checkbox"/>	<input type="checkbox"/>
Vinyl chloride	<input checked="" type="checkbox"/>	<input type="checkbox"/>	Xylenes	<input checked="" type="checkbox"/>	<input type="checkbox"/>
Zinc	<input checked="" type="checkbox"/>	<input type="checkbox"/>			

**SITE NAME:** Gilmer County SR 52 - Tower Road MSWLF

**LOCATION:** TV Tower Road  
Ellijay, Gilmer County, GA 30540

Latitude 34° 42' 50 " N Longitude 84° 29' 26 " W

**ACREAGE** **PARCEL NUMBER**

93 3065 175A

**DATE LISTED**

1/24/2001

**LAST KNOWN PROPERTY OWNER:**

Gilmer County  
1 Westside Square  
Ellijay, GA 30540

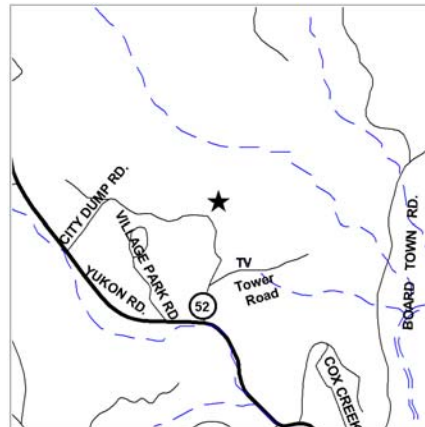

**STATUS OF CLEANUP ACTIVITIES:**

Cleanup activities are being conducted for source materials and groundwater.

**CLEANUP PRIORITY:** The Director has designated this site as a Class IV

**GA EPD DIRECTOR'S DETERMINATION REGARDING CORRECTIVE ACTION:**

The Director has determined that this site requires corrective action.

**REGULATED SUBSTANCES RELEASED, AND THREATS TO HUMAN HEALTH AND ENVIRONMENT POSED BY THE RELEASE:**

This site has a known release of Vinyl chloride in groundwater at levels exceeding the reportable quantity. No human exposure via drinking water is suspected from this release. The nearest drinking water well is less than 0.5 miles from the area affected by the release.

**REGULATED SUBSTANCES:**

Substance Name	GW	Soil	Substance Name	GW	Soil
Barium	<input checked="" type="checkbox"/>	<input type="checkbox"/>	Cis-1,2-Dichloroethene	<input checked="" type="checkbox"/>	<input type="checkbox"/>
Cobalt {reference only, not regulated substance}	<input checked="" type="checkbox"/>	<input type="checkbox"/>	Dichloromethane	<input checked="" type="checkbox"/>	<input type="checkbox"/>
Mercury	<input checked="" type="checkbox"/>	<input type="checkbox"/>	Tetrachloroethene	<input checked="" type="checkbox"/>	<input type="checkbox"/>
Vinyl chloride	<input checked="" type="checkbox"/>	<input type="checkbox"/>			

**SITE NAME:** Glynn Co. - Cate Road C&D MSWLF  
**LOCATION:** 1000 Pritchard Island Road  
Brunswick, Glynn County, GA 31521

Latitude 31° 15' 28" N Longitude 81° 31' 39" W

**ACREAGE** 140.98      **PARCEL NUMBER** 02-02215      **DATE LISTED** 1/24/2001

**LAST KNOWN PROPERTY OWNER:**

Glynn County  
701 G Street  
Brunswick, GA 31520



**STATUS OF CLEANUP ACTIVITIES:**

Cleanup activities are being conducted for source materials and groundwater.

**CLEANUP PRIORITY:** The Director has designated this site as a Class IV

**GA EPD DIRECTOR'S DETERMINATION REGARDING CORRECTIVE ACTION:**

The Director has determined that this site requires corrective action.

**REGULATED SUBSTANCES RELEASED, AND THREATS TO HUMAN HEALTH AND ENVIRONMENT POSED BY THE RELEASE:**

This site has a known release of Vinyl chloride in groundwater at levels exceeding the reportable quantity. No human exposure via drinking water is suspected from this release. The nearest drinking water well is less than 0.5 miles from the area affected by the release.

**REGULATED SUBSTANCES:**

Substance Name	GW	Soil	Substance Name	GW	Soil
Barium	<input checked="" type="checkbox"/>	<input type="checkbox"/>	Chlorobenzene	<input checked="" type="checkbox"/>	<input type="checkbox"/>
Cis-1,2-Dichloroethene	<input checked="" type="checkbox"/>	<input type="checkbox"/>	Vinyl chloride	<input checked="" type="checkbox"/>	<input type="checkbox"/>

**SITE NAME:** Haralson County Landfill (US 78 Bremen)  
**LOCATION:** Landfill Road  
Bremen, Haralson County, GA 30110

Latitude 33° 42' 13" N Longitude 85° 13' 31" W

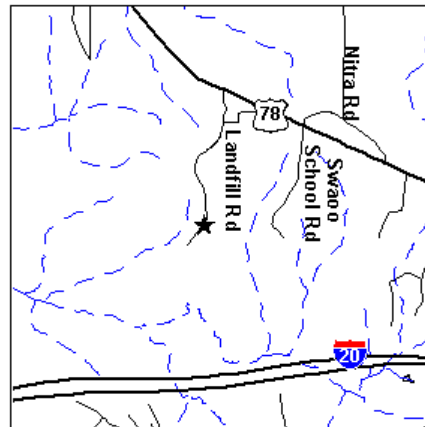

ACREAGE	PARCEL NUMBER	DATE LISTED
111	0067 0001	1/24/2001
133.84	0067 0007	1/24/2001

**LAST KNOWN PROPERTY OWNER:**

Haralson County Solid Waste Management Authority  
P. O. Box 489  
Buchanan, GA 30113-0489

**STATUS OF CLEANUP ACTIVITIES:**

Cleanup activities are being conducted for source materials and groundwater.

**CLEANUP PRIORITY:** The Director has designated this site as a Class IV

**GA EPD DIRECTOR'S DETERMINATION REGARDING CORRECTIVE ACTION:**

The Director has determined that this site requires corrective action.

**REGULATED SUBSTANCES RELEASED, AND THREATS TO HUMAN HEALTH AND ENVIRONMENT POSED BY THE RELEASE:**

This site has a known release of Vinyl chloride in groundwater at levels exceeding the reportable quantity. No human exposure via drinking water is suspected from this release. The nearest drinking water well is less than 0.5 miles from the area affected by the release.

**REGULATED SUBSTANCES:**

Substance Name	GW	Soil	Substance Name	GW	Soil
Barium	<input checked="" type="checkbox"/>	<input type="checkbox"/>	Benzene	<input checked="" type="checkbox"/>	<input type="checkbox"/>
Cadmium	<input checked="" type="checkbox"/>	<input type="checkbox"/>	Chloroethane	<input checked="" type="checkbox"/>	<input type="checkbox"/>
Chromium	<input checked="" type="checkbox"/>	<input type="checkbox"/>	Cis-1,2-Dichloroethene	<input checked="" type="checkbox"/>	<input type="checkbox"/>
Cobalt {reference only, not regulated substance}	<input checked="" type="checkbox"/>	<input type="checkbox"/>	Copper	<input checked="" type="checkbox"/>	<input type="checkbox"/>
Dichloromethane	<input checked="" type="checkbox"/>	<input type="checkbox"/>	Mercury	<input checked="" type="checkbox"/>	<input type="checkbox"/>
Nickel	<input checked="" type="checkbox"/>	<input type="checkbox"/>	Tetrachloroethene	<input checked="" type="checkbox"/>	<input type="checkbox"/>
Trichloroethene	<input checked="" type="checkbox"/>	<input type="checkbox"/>	Vanadium {reference only, not regulated substance}	<input checked="" type="checkbox"/>	<input type="checkbox"/>
Vinyl chloride	<input checked="" type="checkbox"/>	<input type="checkbox"/>	Zinc	<input checked="" type="checkbox"/>	<input type="checkbox"/>



**SITE NAME:** Hart County Landfill  
**LOCATION:** Landfill Road  
Hartwell, Hart County, GA 30643

Latitude 34° 18' 50" N Longitude 82° 56' 21" W

**ACREAGE** 192.45      **PARCEL NUMBER** C58D 076      **DATE LISTED** 1/24/2001

**LAST KNOWN PROPERTY OWNER:**

Hart County  
P. O. Box 279  
Hartwell, GA 30643-0279

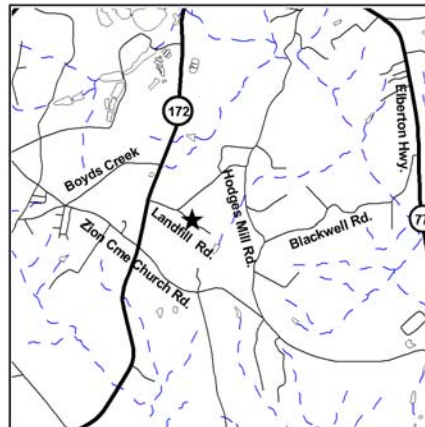

**STATUS OF CLEANUP ACTIVITIES:**

Cleanup activities are being conducted for source materials and groundwater.

**CLEANUP PRIORITY:** The Director has designated this site as a Class IV

**GA EPD DIRECTOR'S DETERMINATION REGARDING CORRECTIVE ACTION:**

The Director has determined that this site requires corrective action.

**REGULATED SUBSTANCES RELEASED, AND THREATS TO HUMAN HEALTH AND ENVIRONMENT POSED BY THE RELEASE:**

This site has a known release of Mercury in groundwater at levels exceeding the reportable quantity. No human exposure via drinking water is suspected from this release. The nearest drinking water well is less than 0.5 miles from the area affected by the release.

**REGULATED SUBSTANCES:**

Substance Name	GW	Soil	Substance Name	GW	Soil
1,1,1-Trichloroethane	<input checked="" type="checkbox"/>	<input type="checkbox"/>	1,1-Dichloroethane	<input checked="" type="checkbox"/>	<input type="checkbox"/>
1,1-Dichloroethene	<input checked="" type="checkbox"/>	<input type="checkbox"/>	1,2,3-Trichloropropane	<input checked="" type="checkbox"/>	<input type="checkbox"/>
Antimony	<input checked="" type="checkbox"/>	<input type="checkbox"/>	Barium	<input checked="" type="checkbox"/>	<input type="checkbox"/>
Benzene	<input checked="" type="checkbox"/>	<input type="checkbox"/>	Beryllium	<input checked="" type="checkbox"/>	<input type="checkbox"/>
bis(2-Ethylhexyl) phthalate	<input checked="" type="checkbox"/>	<input type="checkbox"/>	Cadmium	<input checked="" type="checkbox"/>	<input type="checkbox"/>
Carbon tetrachloride	<input checked="" type="checkbox"/>	<input type="checkbox"/>	Chlorobenzene	<input checked="" type="checkbox"/>	<input type="checkbox"/>
Chloroethane	<input checked="" type="checkbox"/>	<input type="checkbox"/>	Cis-1,2-Dichloroethene	<input checked="" type="checkbox"/>	<input type="checkbox"/>
Cobalt {reference only, not regulated substance}	<input checked="" type="checkbox"/>	<input type="checkbox"/>	Dichloromethane	<input checked="" type="checkbox"/>	<input type="checkbox"/>
Mercury	<input checked="" type="checkbox"/>	<input type="checkbox"/>	Nickel	<input checked="" type="checkbox"/>	<input type="checkbox"/>
p-Dichlorobenzene	<input checked="" type="checkbox"/>	<input type="checkbox"/>	Tetrachloroethene	<input checked="" type="checkbox"/>	<input type="checkbox"/>
Thallium	<input checked="" type="checkbox"/>	<input type="checkbox"/>	Trichloroethene	<input checked="" type="checkbox"/>	<input type="checkbox"/>
Vinyl chloride	<input checked="" type="checkbox"/>	<input type="checkbox"/>	Xylenes	<input checked="" type="checkbox"/>	<input type="checkbox"/>
Zinc	<input checked="" type="checkbox"/>	<input type="checkbox"/>			

**SITE NAME:** West Asbury Road Phase II MSWLF  
**LOCATION:** West Asbury Road  
McDonough, Henry County, GA 30253

Latitude 33° 25' 56" N Longitude 84° 10' 13" W

**ACREAGE** 80.24      **PARCEL NUMBER** 093-01007000      **DATE LISTED** 10/31/2000

**LAST KNOWN PROPERTY OWNER:**  
Henry County Board of Commissioners  
140 Henry Parkway  
McDonough, GA 30253



**STATUS OF CLEANUP ACTIVITIES:**

Cleanup activities are being conducted for source materials and groundwater.

**CLEANUP PRIORITY:** The Director has designated this site as a Class IV

**GA EPD DIRECTOR'S DETERMINATION REGARDING CORRECTIVE ACTION:**

The Director has determined that this site requires corrective action.

**REGULATED SUBSTANCES RELEASED, AND THREATS TO HUMAN HEALTH AND ENVIRONMENT POSED BY THE RELEASE:**

This site has a known release of Tetrachloroethene in groundwater at levels exceeding the reportable quantity. No human exposure via drinking water is suspected from this release. The nearest drinking water well is between 0.5 and 1 miles from the area affected by the release.

**REGULATED SUBSTANCES:**

Substance Name	GW	Soil	Substance Name	GW	Soil
1,1-Dichloroethane	<input checked="" type="checkbox"/>	<input type="checkbox"/>	1,2-Dichloroethane	<input checked="" type="checkbox"/>	<input type="checkbox"/>
Antimony	<input checked="" type="checkbox"/>	<input type="checkbox"/>	Arsenic	<input checked="" type="checkbox"/>	<input type="checkbox"/>
Barium	<input checked="" type="checkbox"/>	<input type="checkbox"/>	Benzene	<input checked="" type="checkbox"/>	<input type="checkbox"/>
Beryllium	<input checked="" type="checkbox"/>	<input type="checkbox"/>	bis(2-Ethylhexyl) phthalate	<input checked="" type="checkbox"/>	<input type="checkbox"/>
Chloroethane	<input checked="" type="checkbox"/>	<input type="checkbox"/>	Chromium	<input checked="" type="checkbox"/>	<input type="checkbox"/>
Cis-1,2-Dichloroethene	<input checked="" type="checkbox"/>	<input type="checkbox"/>	Copper	<input checked="" type="checkbox"/>	<input type="checkbox"/>
Dichloromethane	<input checked="" type="checkbox"/>	<input type="checkbox"/>	Lead	<input checked="" type="checkbox"/>	<input type="checkbox"/>
Mercury	<input checked="" type="checkbox"/>	<input type="checkbox"/>	Naphthalene	<input checked="" type="checkbox"/>	<input type="checkbox"/>
Nickel	<input checked="" type="checkbox"/>	<input type="checkbox"/>	p-Dichlorobenzene	<input checked="" type="checkbox"/>	<input type="checkbox"/>
Tetrachloroethene	<input checked="" type="checkbox"/>	<input type="checkbox"/>	Thallium	<input checked="" type="checkbox"/>	<input type="checkbox"/>
Toluene	<input checked="" type="checkbox"/>	<input type="checkbox"/>	Trichloroethene	<input checked="" type="checkbox"/>	<input type="checkbox"/>
Vinyl chloride	<input checked="" type="checkbox"/>	<input type="checkbox"/>	Xylenes	<input checked="" type="checkbox"/>	<input type="checkbox"/>
Zinc	<input checked="" type="checkbox"/>	<input type="checkbox"/>			

**SITE NAME:** Jefferson County - US 1 (Avera Rd) MSWLF

**LOCATION:** 1159 Clarks Mill Road  
Louisville, Jefferson County, GA 30434

Latitude 33° 1' 51" N Longitude 82° 24' 34" W

**ACREAGE** 34.04      **PARCEL NUMBER** 0072 036      **DATE LISTED** 1/24/2001

**LAST KNOWN PROPERTY OWNER:**

Jefferson County Board of Commissioners  
P.O. Box 658  
Louisville, GA 30434



**STATUS OF CLEANUP ACTIVITIES:**

Cleanup activities are being conducted for source materials and groundwater.

**CLEANUP PRIORITY:** The Director has designated this site as a Class IV

**GA EPD DIRECTOR'S DETERMINATION REGARDING CORRECTIVE ACTION:**

The Director has determined that this site requires corrective action.

**REGULATED SUBSTANCES RELEASED, AND THREATS TO HUMAN HEALTH AND ENVIRONMENT POSED BY THE RELEASE:**

This site has a known release of Cis-1,2 Dichloroethylene in groundwater at levels exceeding the reportable quantity. This release has resulted in known human exposure less than the MCL for Cis-1,2 Dichloroethylene.

**REGULATED SUBSTANCES:**

Substance Name	GW	Soil	Substance Name	GW	Soil
Barium	<input checked="" type="checkbox"/>	<input type="checkbox"/>	Cadmium	<input checked="" type="checkbox"/>	<input type="checkbox"/>
Cis-1,2-Dichloroethene	<input checked="" type="checkbox"/>	<input type="checkbox"/>	Cobalt {reference only, not regulated substance}	<input checked="" type="checkbox"/>	<input type="checkbox"/>
Nickel	<input checked="" type="checkbox"/>	<input type="checkbox"/>	Thallium	<input checked="" type="checkbox"/>	<input type="checkbox"/>

**SITE NAME:** Lamar County - Grove Street Extension MSWLF

**LOCATION:** 172 Roger Brown Drive  
Barnesville, Lamar County, GA 30204

Latitude 33° 5' 9" N Longitude 84° 12' 30" W

<b>ACREAGE</b>	<b>PARCEL NUMBER</b>	<b>DATE LISTED</b>
132.2	022 004	1/24/2001

**LAST KNOWN PROPERTY OWNER:**

Lamar County Regional Solid Waste Management Authority  
172 Roger Brown Dr.  
Barnesville, GA 30204

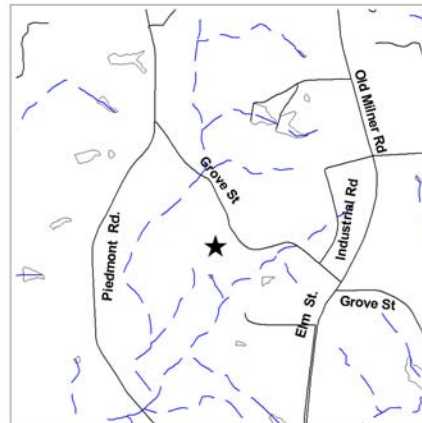

**STATUS OF CLEANUP ACTIVITIES:**

Cleanup activities are being conducted for source materials and groundwater.

**CLEANUP PRIORITY:** The Director has designated this site as a Class IV

**GA EPD DIRECTOR'S DETERMINATION REGARDING CORRECTIVE ACTION:**

The Director has determined that this site requires corrective action.

**REGULATED SUBSTANCES RELEASED, AND THREATS TO HUMAN HEALTH AND ENVIRONMENT POSED BY THE RELEASE:**

This site has a known release of Vinyl chloride in groundwater at levels exceeding the reportable quantity. No human exposure via drinking water is suspected from this release. The nearest drinking water well is less than 0.5 miles from the area affected by the release.

**REGULATED SUBSTANCES:**

Substance Name	GW	Soil	Substance Name	GW	Soil
1,1-Dichloroethane	<input checked="" type="checkbox"/>	<input type="checkbox"/>	1,2-Dichloropropane	<input checked="" type="checkbox"/>	<input type="checkbox"/>
Benzene	<input checked="" type="checkbox"/>	<input type="checkbox"/>	Cis-1,2-Dichloroethene	<input checked="" type="checkbox"/>	<input type="checkbox"/>
Cobalt {reference only, not regulated substance}	<input checked="" type="checkbox"/>	<input type="checkbox"/>	Dichloromethane	<input checked="" type="checkbox"/>	<input type="checkbox"/>
p-Dichlorobenzene	<input checked="" type="checkbox"/>	<input type="checkbox"/>	Tetrachloroethene	<input checked="" type="checkbox"/>	<input type="checkbox"/>
Toluene	<input checked="" type="checkbox"/>	<input type="checkbox"/>	Trichloroethene	<input checked="" type="checkbox"/>	<input type="checkbox"/>
Vinyl chloride	<input checked="" type="checkbox"/>	<input type="checkbox"/>	Xylenes	<input checked="" type="checkbox"/>	<input type="checkbox"/>

**GEORGIA ENVIRONMENTAL PROTECTION DIVISION  
HAZARDOUS SITE INVENTORY**

Site Number **10671**

**SITE NAME:** Lee County - SR 32 MSWLF  
**LOCATION:** SR 32 W  
 Leesburg, Lee County, GA 31763

Latitude 31° 43' 59" N Longitude 84° 7' 13" W

**ACREAGE** 117.38      **PARCEL NUMBER** 115 051 005      **DATE LISTED** 1/24/2001

**LAST KNOWN PROPERTY OWNER:**  
 Lee County Board of Commissioners  
 104 Leslie Highway / P. O. Box 889  
 Leesburg, GA 31763

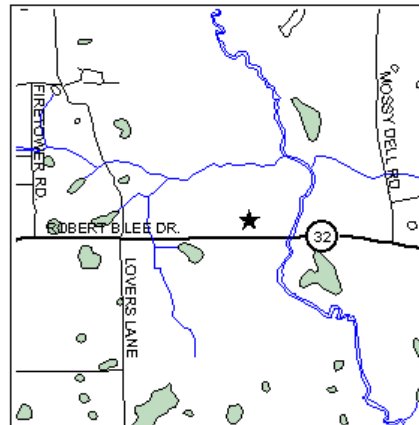

**STATUS OF CLEANUP ACTIVITIES:**

Cleanup activities are being conducted for source materials and groundwater.

**CLEANUP PRIORITY:** The Director has designated this site as a Class IV

**GA EPD DIRECTOR'S DETERMINATION REGARDING CORRECTIVE ACTION:**

The Director has determined that this site requires corrective action.

**REGULATED SUBSTANCES RELEASED, AND THREATS TO HUMAN HEALTH AND ENVIRONMENT POSED BY THE RELEASE:**

This site has a known release of Vinyl chloride in groundwater at levels exceeding the reportable quantity. No human exposure via drinking water is suspected from this release. The nearest drinking water well is less than 0.5 miles from the area affected by the release.

**REGULATED SUBSTANCES:**

Substance Name	GW	Soil	Substance Name	GW	Soil
Arsenic	<input checked="" type="checkbox"/>	<input type="checkbox"/>	Barium	<input checked="" type="checkbox"/>	<input type="checkbox"/>
Benzene	<input checked="" type="checkbox"/>	<input type="checkbox"/>	Chlorobenzene	<input checked="" type="checkbox"/>	<input type="checkbox"/>
Cis-1,2-Dichloroethene	<input checked="" type="checkbox"/>	<input type="checkbox"/>	Lead	<input checked="" type="checkbox"/>	<input type="checkbox"/>
Mercury	<input checked="" type="checkbox"/>	<input type="checkbox"/>	Nickel	<input checked="" type="checkbox"/>	<input type="checkbox"/>
p-Dichlorobenzene	<input checked="" type="checkbox"/>	<input type="checkbox"/>	Thallium	<input checked="" type="checkbox"/>	<input type="checkbox"/>
Vinyl chloride	<input checked="" type="checkbox"/>	<input type="checkbox"/>			

**GEORGIA ENVIRONMENTAL PROTECTION DIVISION  
HAZARDOUS SITE INVENTORY**

Site Number **10672**

**SITE NAME:** Liberty County - Limerick Road MSWLF  
**LOCATION:** Limerick Road  
Limerick, Liberty County, GA 31313

Latitude 31° 50' 34 " N Longitude 81° 23' 46 " W

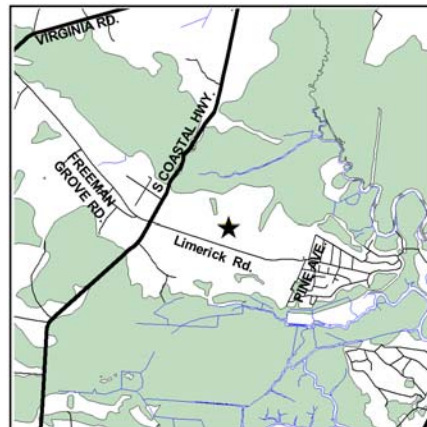

ACREAGE	PARCEL NUMBER	DATE LISTED
50.64	237 038	1/24/2001
7.77	237 041	1/24/2001
10.02	237 040	1/24/2001
4.62	237 039	1/24/2001

**LAST KNOWN PROPERTY OWNER:**

Liberty County  
112 North Main Street  
Hinesville, GA 31313

**STATUS OF CLEANUP ACTIVITIES:**

Cleanup activities are being conducted for source materials and groundwater.

**CLEANUP PRIORITY:** The Director has designated this site as a Class IV

**GA EPD DIRECTOR'S DETERMINATION REGARDING CORRECTIVE ACTION:**

The Director has determined that this site requires corrective action.

**REGULATED SUBSTANCES RELEASED, AND THREATS TO HUMAN HEALTH AND ENVIRONMENT POSED BY THE RELEASE:**

This site has a known release of Vinyl chloride in groundwater at levels exceeding the reportable quantity. No human exposure via drinking water is suspected from this release. The nearest drinking water well is less than 0.5 miles from the area affected by the release.

**REGULATED SUBSTANCES:**

Substance Name	GW	Soil	Substance Name	GW	Soil
Arsenic	<input checked="" type="checkbox"/>	<input type="checkbox"/>	Barium	<input checked="" type="checkbox"/>	<input type="checkbox"/>
Benzene	<input checked="" type="checkbox"/>	<input type="checkbox"/>	Chlorobenzene	<input checked="" type="checkbox"/>	<input type="checkbox"/>
Cis-1,2-Dichloroethene	<input checked="" type="checkbox"/>	<input type="checkbox"/>	Ethylbenzene	<input checked="" type="checkbox"/>	<input type="checkbox"/>
Nickel	<input checked="" type="checkbox"/>	<input type="checkbox"/>	p-Dichlorobenzene	<input checked="" type="checkbox"/>	<input type="checkbox"/>
Vinyl chloride	<input checked="" type="checkbox"/>	<input type="checkbox"/>			

**SITE NAME:** Valdosta - Wetherington Lane SL  
**LOCATION:** Wetherington Lane  
Valdosta, Lowndes County, GA 31603

Latitude 30° 49' 26 " N Longitude 83° 21' 35 " W

**ACREAGE** 24.35 **PARCEL NUMBER** 0058 002 **DATE LISTED** 1/24/2001

**LAST KNOWN PROPERTY OWNER:**

City of Valdosta  
Post Office Box 1125  
Valdosta, GA 31603-1125

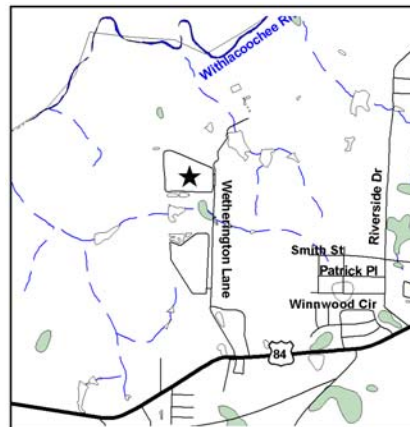

**STATUS OF CLEANUP ACTIVITIES:**

Cleanup activities are being conducted for source materials and groundwater.

**CLEANUP PRIORITY:** The Director has designated this site as a Class IV

**GA EPD DIRECTOR'S DETERMINATION REGARDING CORRECTIVE ACTION:**

The Director has determined that this site requires corrective action.

**REGULATED SUBSTANCES RELEASED, AND THREATS TO HUMAN HEALTH AND ENVIRONMENT POSED BY THE RELEASE:**

This site has a known release of Tetrachloroethene in groundwater at levels exceeding the reportable quantity. No human exposure via drinking water is suspected from this release. The nearest drinking water well is less than 0.5 miles from the area affected by the release.

**REGULATED SUBSTANCES:**

Substance Name	GW	Soil	Substance Name	GW	Soil
Ethylene dibromide	<input checked="" type="checkbox"/>	<input type="checkbox"/>	Mercury	<input checked="" type="checkbox"/>	<input type="checkbox"/>
Tetrachloroethene	<input checked="" type="checkbox"/>	<input type="checkbox"/>	Zinc	<input checked="" type="checkbox"/>	<input type="checkbox"/>

**SITE NAME:** McIntosh County - King Road MSWLF  
**LOCATION:** King Road  
Eulonia, McIntosh County, GA 31305

Latitude 31° 30' 48" N Longitude 81° 28' 57" W



ACREAGE	PARCEL NUMBER	DATE LISTED
72.86	0037 0001	1/24/2001
81.2	0037 00012EX	
18.99	0037 00011EX	

**LAST KNOWN PROPERTY OWNER:**

McIntosh County Board of Commissioners  
310 Northway / P. O. Box 584  
Darien, GA 31305

**STATUS OF CLEANUP ACTIVITIES:**

Cleanup activities are being conducted for source materials and groundwater.

**CLEANUP PRIORITY:** The Director has designated this site as a Class IV

**GA EPD DIRECTOR'S DETERMINATION REGARDING CORRECTIVE ACTION:**

The Director has determined that this site requires corrective action.

**REGULATED SUBSTANCES RELEASED, AND THREATS TO HUMAN HEALTH AND ENVIRONMENT POSED BY THE RELEASE:**

This site has a known release of Vinyl chloride in groundwater at levels exceeding the reportable quantity. No human exposure via drinking water is suspected from this release. The nearest drinking water well is between 0.5 and 1 miles from the area affected by the release.

**REGULATED SUBSTANCES:**

Substance Name	GW	Soil	Substance Name	GW	Soil
1,1-Dichloroethane	<input checked="" type="checkbox"/>	<input type="checkbox"/>	Arsenic	<input checked="" type="checkbox"/>	<input type="checkbox"/>
Benzene	<input checked="" type="checkbox"/>	<input type="checkbox"/>	Chlorobenzene	<input checked="" type="checkbox"/>	<input type="checkbox"/>
Cis-1,2-Dichloroethene	<input checked="" type="checkbox"/>	<input type="checkbox"/>	Lead	<input checked="" type="checkbox"/>	<input type="checkbox"/>
Mercury	<input checked="" type="checkbox"/>	<input type="checkbox"/>	Vinyl chloride	<input checked="" type="checkbox"/>	<input type="checkbox"/>



**SITE NAME:** Mitchell County - SR 3A MSWLF  
**LOCATION:** State Road 3  
Pelham, Mitchell County, GA 31730

Latitude 31° 10' 7" N Longitude 84° 10' 9" W

**ACREAGE** 20      **PARCEL NUMBER** 01000-006-000      **DATE LISTED** 1/24/2001

**LAST KNOWN PROPERTY OWNER:**  
Mitchell County Board of Commissioners  
P. O. Box 187  
Camilla, GA 31730

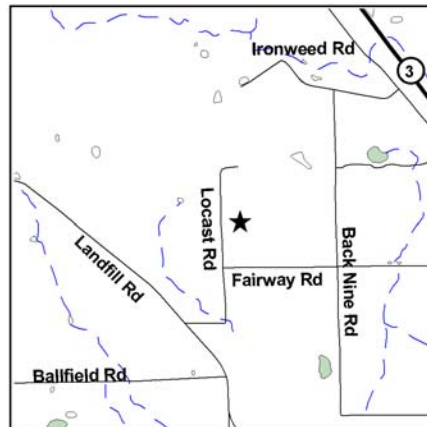

**STATUS OF CLEANUP ACTIVITIES:**

Cleanup activities are being conducted for source materials and groundwater.

**CLEANUP PRIORITY:** The Director has designated this site as a Class IV

**GA EPD DIRECTOR'S DETERMINATION REGARDING CORRECTIVE ACTION:**

The Director has determined that this site requires corrective action.

**REGULATED SUBSTANCES RELEASED, AND THREATS TO HUMAN HEALTH AND ENVIRONMENT POSED BY THE RELEASE:**

This site has a known release of Vinyl chloride in groundwater at levels exceeding the reportable quantity. No human exposure via drinking water is suspected from this release. The nearest drinking water well is between 0.5 and 1 miles from the area affected by the release.

**REGULATED SUBSTANCES:**

Substance Name	GW	Soil	Substance Name	GW	Soil
Barium	<input checked="" type="checkbox"/>	<input type="checkbox"/>	Benzene	<input checked="" type="checkbox"/>	<input type="checkbox"/>
Cadmium	<input checked="" type="checkbox"/>	<input type="checkbox"/>	Chlorobenzene	<input checked="" type="checkbox"/>	<input type="checkbox"/>
Chromium	<input checked="" type="checkbox"/>	<input type="checkbox"/>	Cis-1,2-Dichloroethene	<input checked="" type="checkbox"/>	<input type="checkbox"/>
Copper	<input checked="" type="checkbox"/>	<input type="checkbox"/>	Cyanides (soluble salts and complexes) n.o.s.	<input checked="" type="checkbox"/>	<input type="checkbox"/>
Dichloromethane	<input checked="" type="checkbox"/>	<input type="checkbox"/>	Lead	<input checked="" type="checkbox"/>	<input type="checkbox"/>
Mercury	<input checked="" type="checkbox"/>	<input type="checkbox"/>	p-Dichlorobenzene	<input checked="" type="checkbox"/>	<input type="checkbox"/>
Selenium	<input checked="" type="checkbox"/>	<input type="checkbox"/>	Tetrachloroethene	<input checked="" type="checkbox"/>	<input type="checkbox"/>
Thallium	<input checked="" type="checkbox"/>	<input type="checkbox"/>	Trichloroethene	<input checked="" type="checkbox"/>	<input type="checkbox"/>
Vinyl chloride	<input checked="" type="checkbox"/>	<input type="checkbox"/>	Zinc	<input checked="" type="checkbox"/>	<input type="checkbox"/>

**SITE NAME:** Murray County - US 411 Westside MSWLF

**LOCATION:** US 411 Westside  
Ramhurst, Murray County, GA 30705

Latitude 34° 40' 50" N Longitude 84° 44' 1" W

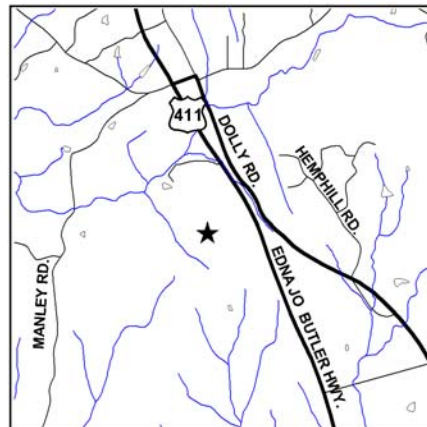

ACREAGE	PARCEL NUMBER	DATE LISTED
104.05	0070 187	1/24/2001
60	0071 055	1/24/2001

**LAST KNOWN PROPERTY OWNER:**

Murray County  
P. O. Box 1129  
Chatsworth, GA 30705

**STATUS OF CLEANUP ACTIVITIES:**

Cleanup activities are being conducted for source materials and groundwater.

**CLEANUP PRIORITY:** The Director has designated this site as a Class IV

**GA EPD DIRECTOR'S DETERMINATION REGARDING CORRECTIVE ACTION:**

The Director has determined that this site requires corrective action.

**REGULATED SUBSTANCES RELEASED, AND THREATS TO HUMAN HEALTH AND ENVIRONMENT POSED BY THE RELEASE:**

This site has a known release of 1,1-Dichloroethane in groundwater at levels exceeding the reportable quantity. No human exposure via drinking water is suspected from this release. The nearest drinking water well is less than 0.5 miles from the area affected by the release.

**REGULATED SUBSTANCES:**

Substance Name	GW	Soil	Substance Name	GW	Soil
1,1-Dichloroethane	<input checked="" type="checkbox"/>	<input type="checkbox"/>	Arsenic	<input checked="" type="checkbox"/>	<input type="checkbox"/>
Barium	<input checked="" type="checkbox"/>	<input type="checkbox"/>	Chloroethane	<input checked="" type="checkbox"/>	<input type="checkbox"/>
Copper	<input checked="" type="checkbox"/>	<input type="checkbox"/>	Lead	<input checked="" type="checkbox"/>	<input type="checkbox"/>
Vinyl chloride	<input checked="" type="checkbox"/>	<input type="checkbox"/>	Zinc	<input checked="" type="checkbox"/>	<input type="checkbox"/>

**SITE NAME:** Newton County - Lower River Road MSWLF

**LOCATION:** 205 Lower River Road  
Porterdale, Newton County, GA 30209

Latitude 33° 33' 5" N Longitude 83° 53' 43" W

**ACREAGE** 272.31      **PARCEL NUMBER** 00460-00000-040-000      **DATE LISTED** 1/24/2001

**LAST KNOWN PROPERTY OWNER:**

Newton County  
1113 Usher Street, N. E.  
Covington, GA 30014

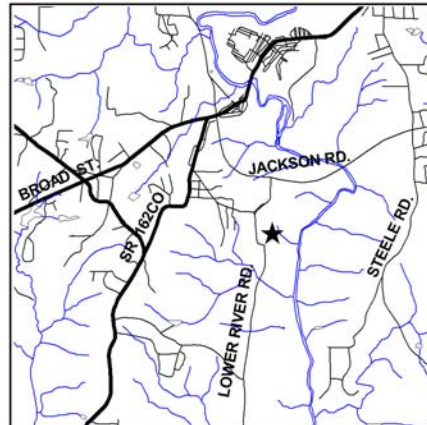

**STATUS OF CLEANUP ACTIVITIES:**

Cleanup activities are being conducted for source materials and groundwater.

**CLEANUP PRIORITY:** The Director has designated this site as a Class IV

**GA EPD DIRECTOR'S DETERMINATION REGARDING CORRECTIVE ACTION:**

The Director has determined that this site requires corrective action.

**REGULATED SUBSTANCES RELEASED, AND THREATS TO HUMAN HEALTH AND ENVIRONMENT POSED BY THE RELEASE:**

This site has a known release of Vinyl chloride in groundwater at levels exceeding the reportable quantity. No human exposure via drinking water is suspected from this release. The nearest drinking water well is between 1 and 2 miles from the area affected by the release.

**REGULATED SUBSTANCES:**

Substance Name	GW	Soil	Substance Name	GW	Soil
1,1,1-Trichloroethane	<input checked="" type="checkbox"/>	<input type="checkbox"/>	1,1-Dichloroethane	<input checked="" type="checkbox"/>	<input type="checkbox"/>
1,1-Dichloroethane	<input checked="" type="checkbox"/>	<input type="checkbox"/>	1,1-Dichloroethene	<input checked="" type="checkbox"/>	<input type="checkbox"/>
1,2-Dichloroethane	<input checked="" type="checkbox"/>	<input type="checkbox"/>	Acetone	<input checked="" type="checkbox"/>	<input type="checkbox"/>
Barium	<input checked="" type="checkbox"/>	<input type="checkbox"/>	Benzene	<input checked="" type="checkbox"/>	<input type="checkbox"/>
Chloroethane	<input checked="" type="checkbox"/>	<input type="checkbox"/>	Chromium	<input checked="" type="checkbox"/>	<input type="checkbox"/>
Cis-1,2-Dichloroethene	<input checked="" type="checkbox"/>	<input type="checkbox"/>	Dichloromethane	<input checked="" type="checkbox"/>	<input type="checkbox"/>
Ethylbenzene	<input checked="" type="checkbox"/>	<input type="checkbox"/>	Nickel	<input checked="" type="checkbox"/>	<input type="checkbox"/>
p-Dichlorobenzene	<input checked="" type="checkbox"/>	<input type="checkbox"/>	Tetrachloroethene	<input checked="" type="checkbox"/>	<input type="checkbox"/>
Toluene	<input checked="" type="checkbox"/>	<input type="checkbox"/>	Trichloroethene	<input checked="" type="checkbox"/>	<input type="checkbox"/>
Vinyl chloride	<input checked="" type="checkbox"/>	<input type="checkbox"/>	Xylenes	<input checked="" type="checkbox"/>	<input type="checkbox"/>
Zinc	<input checked="" type="checkbox"/>	<input type="checkbox"/>			

**SITE NAME:** Pickens Co. - Jones Mountain Road Westside MSWLF

**LOCATION:** Jones Mountain Road  
Talking Rock, Pickens County, GA 30175

Latitude 34° 32' 30" N Longitude 84° 28' 31" W

<b>ACREAGE</b>	<b>PARCEL NUMBER</b>	<b>DATE LISTED</b>
53.63	010-024	1/24/2001

**LAST KNOWN PROPERTY OWNER:**

Pickens County  
52 North Main Street, Suite 201  
Jasper, GA 30143



**STATUS OF CLEANUP ACTIVITIES:**

Cleanup activities are being conducted for source materials and groundwater.

**CLEANUP PRIORITY:** The Director has designated this site as a Class IV

**GA EPD DIRECTOR'S DETERMINATION REGARDING CORRECTIVE ACTION:**

The Director has determined that this site requires corrective action.

**REGULATED SUBSTANCES RELEASED, AND THREATS TO HUMAN HEALTH AND ENVIRONMENT POSED BY THE RELEASE:**

This site has a known release of Arsenic in groundwater at levels exceeding the reportable quantity. No human exposure via drinking water is suspected from this release. The nearest drinking water well is less than 0.5 miles from the area affected by the release.

**REGULATED SUBSTANCES:**

Substance Name	GW	Soil	Substance Name	GW	Soil
1,1-Dichloroethane	<input checked="" type="checkbox"/>	<input type="checkbox"/>	Arsenic	<input checked="" type="checkbox"/>	<input type="checkbox"/>
Chloroethane	<input checked="" type="checkbox"/>	<input type="checkbox"/>	Cis-1,2-Dichloroethene	<input checked="" type="checkbox"/>	<input type="checkbox"/>

**SITE NAME:** Pierce County - SR 121 MSWLF  
**LOCATION:** SR 121 / County Farm Road  
Blackshear, Pierce County, GA 31516

Latitude 31° 20' 57" N Longitude 82° 12' 45" W

**ACREAGE** 209      **PARCEL NUMBER** 045 033      **DATE LISTED** 1/24/2001

**LAST KNOWN PROPERTY OWNER:**

Pierce County  
Post Office Box 679 / 312 Nichols Street  
Blackshear, GA 31516-0679



**STATUS OF CLEANUP ACTIVITIES:**

Cleanup activities are being conducted for source materials and groundwater.

**CLEANUP PRIORITY:** The Director has designated this site as a Class IV

**GA EPD DIRECTOR'S DETERMINATION REGARDING CORRECTIVE ACTION:**

The Director has determined that this site requires corrective action.

**REGULATED SUBSTANCES RELEASED, AND THREATS TO HUMAN HEALTH AND ENVIRONMENT POSED BY THE RELEASE:**

This site has a known release of Vinyl chloride in groundwater at levels exceeding the reportable quantity. No human exposure via drinking water is suspected from this release. The nearest drinking water well is less than 0.5 miles from the area affected by the release.

**REGULATED SUBSTANCES:**

Substance Name	GW	Soil	Substance Name	GW	Soil
Barium	<input checked="" type="checkbox"/>	<input type="checkbox"/>	Chlorobenzene	<input checked="" type="checkbox"/>	<input type="checkbox"/>
Vinyl chloride	<input checked="" type="checkbox"/>	<input type="checkbox"/>			

**SITE NAME:** Terrell County - U. S. 82 MSWLF  
**LOCATION:** U. S. Highway 82  
Dawson, Terrell County, GA 31742

Latitude 31° 44' 57" N Longitude 84° 25' 16" W

**ACREAGE** 50.64      **PARCEL NUMBER** 042 016      **DATE LISTED** 1/24/2001

**LAST KNOWN PROPERTY OWNER:**  
Terrell County  
Post Office Box 525, 955 Forrester Road  
Dawson, GA 31742



**STATUS OF CLEANUP ACTIVITIES:**

Cleanup activities are being conducted for source materials and groundwater.

**CLEANUP PRIORITY:** The Director has designated this site as a Class IV

**GA EPD DIRECTOR'S DETERMINATION REGARDING CORRECTIVE ACTION:**

The Director has determined that this site requires corrective action.

**REGULATED SUBSTANCES RELEASED, AND THREATS TO HUMAN HEALTH AND ENVIRONMENT POSED BY THE RELEASE:**

This site has a known release of Vinyl chloride in groundwater at levels exceeding the reportable quantity. No human exposure via drinking water is suspected from this release. The nearest drinking water well is between 1 and 2 miles from the area affected by the release.

**REGULATED SUBSTANCES:**

Substance Name	GW	Soil	Substance Name	GW	Soil
Barium	<input checked="" type="checkbox"/>	<input type="checkbox"/>	Cadmium	<input checked="" type="checkbox"/>	<input type="checkbox"/>
Chlorobenzene	<input checked="" type="checkbox"/>	<input type="checkbox"/>	Cobalt (reference only, not regulated substance)	<input checked="" type="checkbox"/>	<input type="checkbox"/>
Lead	<input checked="" type="checkbox"/>	<input type="checkbox"/>	Nickel	<input checked="" type="checkbox"/>	<input type="checkbox"/>
Thallium	<input checked="" type="checkbox"/>	<input type="checkbox"/>	Vinyl chloride	<input checked="" type="checkbox"/>	<input type="checkbox"/>

**SITE NAME:** Tifton - Omega / Eldorado Road MSWLF

**LOCATION:** Omega - Eldorado Road  
Tifton, Tift County, GA 31793

Latitude 31° 21' 28" N Longitude 83° 32' 14" W

<b>ACREAGE</b>	<b>PARCEL NUMBER</b>	<b>DATE LISTED</b>
112.4	0051 022	1/21/2001

**LAST KNOWN PROPERTY OWNER:**

City of Tifton  
800 Armour Road/ Post Office Box 229  
Tifton, GA 31793

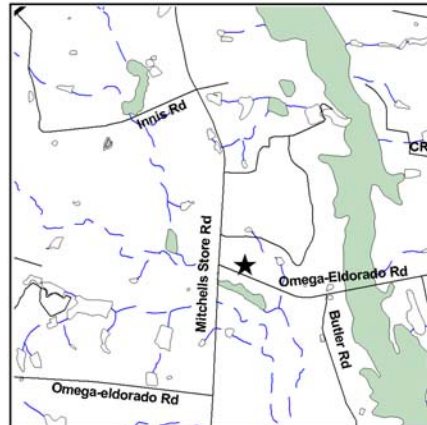

**STATUS OF CLEANUP ACTIVITIES:**

Cleanup activities are being conducted for source materials and groundwater.

**CLEANUP PRIORITY:** The Director has designated this site as a Class IV

**GA EPD DIRECTOR'S DETERMINATION REGARDING CORRECTIVE ACTION:**

The Director has determined that this site requires corrective action.

**REGULATED SUBSTANCES RELEASED, AND THREATS TO HUMAN HEALTH AND ENVIRONMENT POSED BY THE RELEASE:**

This site has a known release of Vinyl chloride in groundwater at levels exceeding the reportable quantity. No human exposure via drinking water is suspected from this release. The nearest drinking water well is less than 0.5 miles from the area affected by the release.

**REGULATED SUBSTANCES:**

Substance Name	GW	Soil	Substance Name	GW	Soil
1,1-Dichloroethane	<input checked="" type="checkbox"/>	<input type="checkbox"/>	Barium	<input checked="" type="checkbox"/>	<input type="checkbox"/>
Benzene	<input checked="" type="checkbox"/>	<input type="checkbox"/>	Chlorobenzenes	<input checked="" type="checkbox"/>	<input type="checkbox"/>
Chromium	<input checked="" type="checkbox"/>	<input type="checkbox"/>	Cis-1,2-Dichloroethene	<input checked="" type="checkbox"/>	<input type="checkbox"/>
Copper	<input checked="" type="checkbox"/>	<input type="checkbox"/>	Dichlorodifluoromethane	<input checked="" type="checkbox"/>	<input type="checkbox"/>
p-Chloroaniline	<input checked="" type="checkbox"/>	<input type="checkbox"/>	p-Dichlorobenzene	<input checked="" type="checkbox"/>	<input type="checkbox"/>
Tetrachloroethene	<input checked="" type="checkbox"/>	<input type="checkbox"/>	Trichloroethene	<input checked="" type="checkbox"/>	<input type="checkbox"/>
Vinyl chloride	<input checked="" type="checkbox"/>	<input type="checkbox"/>	Zinc	<input checked="" type="checkbox"/>	<input type="checkbox"/>

**SITE NAME:** Towns County - SR 288 MSWLF  
**LOCATION:** S. R. 288  
Hiwassee, Towns County, GA 30546

Latitude 34° 55' 38" N Longitude 83° 44' 47" W

**ACREAGE** 29.92      **PARCEL NUMBER** 0045 010      **DATE LISTED** 1/24/2001

**LAST KNOWN PROPERTY OWNER:**

Towns County  
48 River Street, Suite B  
Hiwassee, GA 30546

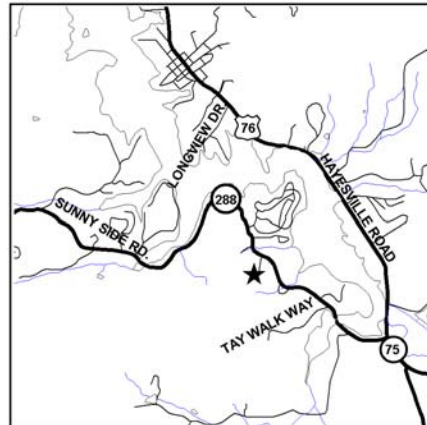

**STATUS OF CLEANUP ACTIVITIES:**

Cleanup activities are being conducted for source materials and groundwater.

**CLEANUP PRIORITY:** The Director has designated this site as a Class IV

**GA EPD DIRECTOR'S DETERMINATION REGARDING CORRECTIVE ACTION:**

The Director has determined that this site requires corrective action.

**REGULATED SUBSTANCES RELEASED, AND THREATS TO HUMAN HEALTH AND ENVIRONMENT POSED BY THE RELEASE:**

This site has a known release of Dichloromethane in groundwater at levels exceeding the reportable quantity. No human exposure via drinking water is suspected from this release. The nearest drinking water well is less than 0.5 miles from the area affected by the release.

**REGULATED SUBSTANCES:**

Substance Name	GW	Soil	Substance Name	GW	Soil
Chromium	<input checked="" type="checkbox"/>	<input type="checkbox"/>	Cis-1,2-Dichloroethene	<input checked="" type="checkbox"/>	<input type="checkbox"/>
Dichloromethane	<input checked="" type="checkbox"/>	<input type="checkbox"/>			



**SITE NAME:** Upson County - Zorn Street Phase 2, 3 MSWLF  
**LOCATION:** Department of Transportation Drive  
Thomaston, Upson County, GA 30286

Latitude 32° 51' 49" N Longitude 84° 19' 28" W

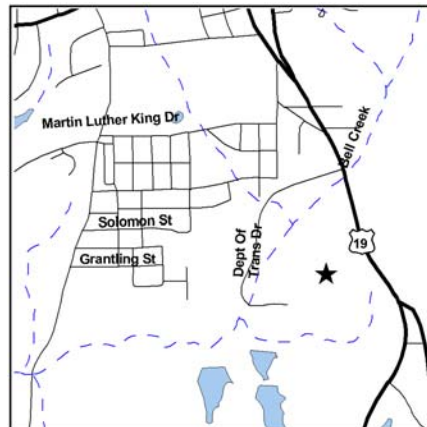

ACREAGE	PARCEL NUMBER	DATE LISTED
5.7	T27 060	1/24/2001
44.68	046 051	1/24/2001
62.1	046 052	1/24/2001

**LAST KNOWN PROPERTY OWNER:**  
City of Thomaston / Upson County (Joint Service)  
106 East Lee Street  
Thomaston, GA 30286

**STATUS OF CLEANUP ACTIVITIES:**

Cleanup activities are being conducted for source materials and groundwater.

**CLEANUP PRIORITY:** The Director has designated this site as a Class IV

**GA EPD DIRECTOR'S DETERMINATION REGARDING CORRECTIVE ACTION:**

The Director has determined that this site requires corrective action.

**REGULATED SUBSTANCES RELEASED, AND THREATS TO HUMAN HEALTH AND ENVIRONMENT POSED BY THE RELEASE:**

This site has a known release of Vinyl chloride in groundwater at levels exceeding the reportable quantity. No human exposure via drinking water is suspected from this release. The nearest drinking water well is between 0.5 and 1 miles from the area affected by the release.

**REGULATED SUBSTANCES:**

Substance Name	GW	Soil	Substance Name	GW	Soil
1,1,1-Trichloroethane	<input checked="" type="checkbox"/>	<input type="checkbox"/>	1,1-Dichloroethane	<input checked="" type="checkbox"/>	<input type="checkbox"/>
1,1-Dichloroethene	<input checked="" type="checkbox"/>	<input type="checkbox"/>	Benzene	<input checked="" type="checkbox"/>	<input type="checkbox"/>
Cadmium	<input checked="" type="checkbox"/>	<input type="checkbox"/>	Chlorobenzene	<input checked="" type="checkbox"/>	<input type="checkbox"/>
Chloroethane	<input checked="" type="checkbox"/>	<input type="checkbox"/>	Cis-1,2-Dichloroethene	<input checked="" type="checkbox"/>	<input type="checkbox"/>
Dichloromethane	<input checked="" type="checkbox"/>	<input type="checkbox"/>	p-Dichlorobenzene	<input checked="" type="checkbox"/>	<input type="checkbox"/>
Trichloroethene	<input checked="" type="checkbox"/>	<input type="checkbox"/>	Vinyl chloride	<input checked="" type="checkbox"/>	<input type="checkbox"/>

**SITE NAME:** Wayne County - Goose Creek Phase 1 MSWLF

**LOCATION:** Highway 169 N  
Jesup, Wayne County, GA 31545

Latitude 31° 39' 52" N Longitude 81° 54' 56" W

**ACREAGE** 53      **PARCEL NUMBER** 84-92      **DATE LISTED** 1/24/2001

**LAST KNOWN PROPERTY OWNER:**

Wayne County  
Post Office Box 270  
Jesup, GA 31598

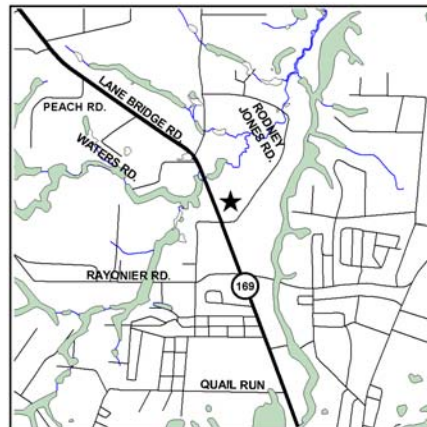

**STATUS OF CLEANUP ACTIVITIES:**

Cleanup activities are being conducted for source materials and groundwater.

**CLEANUP PRIORITY:** The Director has designated this site as a Class IV

**GA EPD DIRECTOR'S DETERMINATION REGARDING CORRECTIVE ACTION:**

The Director has determined that this site requires corrective action.

**REGULATED SUBSTANCES RELEASED, AND THREATS TO HUMAN HEALTH AND ENVIRONMENT POSED BY THE RELEASE:**

This site has a known release of Vinyl chloride in groundwater at levels exceeding the reportable quantity. No human exposure via drinking water is suspected from this release. The nearest drinking water well is less than 0.5 miles from the area affected by the release.

**REGULATED SUBSTANCES:**

Substance Name	GW	Soil	Substance Name	GW	Soil
1,1-Dichloroethane	<input checked="" type="checkbox"/>	<input type="checkbox"/>	Antimony	<input checked="" type="checkbox"/>	<input type="checkbox"/>
Arsenic	<input checked="" type="checkbox"/>	<input type="checkbox"/>	Barium	<input checked="" type="checkbox"/>	<input type="checkbox"/>
Benzene	<input checked="" type="checkbox"/>	<input type="checkbox"/>	Beryllium	<input checked="" type="checkbox"/>	<input type="checkbox"/>
Chlorobenzene	<input checked="" type="checkbox"/>	<input type="checkbox"/>	Chloroethane	<input checked="" type="checkbox"/>	<input type="checkbox"/>
Cis-1,2-Dichloroethene	<input checked="" type="checkbox"/>	<input type="checkbox"/>	Lead	<input checked="" type="checkbox"/>	<input type="checkbox"/>
p-Dichlorobenzene	<input checked="" type="checkbox"/>	<input type="checkbox"/>	Vinyl chloride	<input checked="" type="checkbox"/>	<input type="checkbox"/>
Zinc	<input checked="" type="checkbox"/>	<input type="checkbox"/>			

**GEORGIA ENVIRONMENTAL PROTECTION DIVISION  
HAZARDOUS SITE INVENTORY**

Site Number **10687**

**SITE NAME:** Whitfield Co. / Dalton - Old Dixie HWY Phases 2, 4 and 5 MSWLF

**LOCATION:** Old Dixie Road  
Dalton, Whitfield County, GA 30722

Latitude 34° 39' 5" N Longitude 84° 57' 1" W

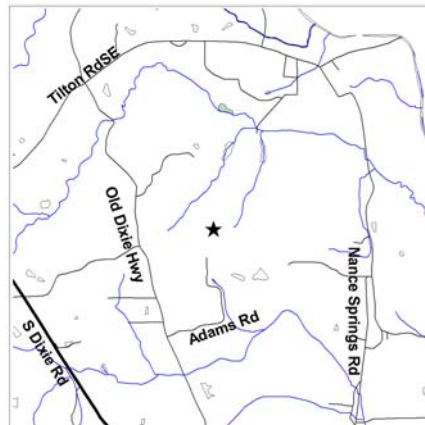

ACREAGE	PARCEL NUMBER	DATE LISTED
69	13-169-03-000	1/24/2001
35	13-156-11-000	1/24/2001
61.3	13-157-02-000	1/24/2001

**LAST KNOWN PROPERTY OWNER:**

Dalton - Whitfield Regional Solid Waste Management Authority  
4189 Old Dixie Highway  
Dalton, GA 30721

**STATUS OF CLEANUP ACTIVITIES:**

Cleanup activities are being conducted for source materials and groundwater.

**CLEANUP PRIORITY:** The Director has designated this site as a Class IV

**GA EPD DIRECTOR'S DETERMINATION REGARDING CORRECTIVE ACTION:**

The Director has determined that this site requires corrective action.

**REGULATED SUBSTANCES RELEASED, AND THREATS TO HUMAN HEALTH AND ENVIRONMENT POSED BY THE RELEASE:**

This site has a known release of Vinyl chloride in groundwater at levels exceeding the reportable quantity. No human exposure via drinking water is suspected from this release. The nearest drinking water well is between 1 and 2 miles from the area affected by the release.

**REGULATED SUBSTANCES:**

Substance Name	GW	Soil	Substance Name	GW	Soil
1,1-Dichloroethane	<input checked="" type="checkbox"/>	<input type="checkbox"/>	Benzene	<input checked="" type="checkbox"/>	<input type="checkbox"/>
Chlorobenzene	<input checked="" type="checkbox"/>	<input type="checkbox"/>	Chloroethane	<input checked="" type="checkbox"/>	<input type="checkbox"/>
Cis-1,2-Dichloroethene	<input checked="" type="checkbox"/>	<input type="checkbox"/>	Nickel	<input checked="" type="checkbox"/>	<input type="checkbox"/>
Trichloroethene	<input checked="" type="checkbox"/>	<input type="checkbox"/>	Vinyl chloride	<input checked="" type="checkbox"/>	<input type="checkbox"/>

**SITE NAME:** Wilkinson Co. - Hwy. 57 Public Works Camp MSWLF

**LOCATION:** State Highway 57  
Irwinton, Wilkinson County, GA 31042

Latitude 32° 50' 0" N Longitude 83° 15' 51" W

**ACREAGE** 340 **PARCEL NUMBER** 037 054 **DATE LISTED** 1/24/2001

**LAST KNOWN PROPERTY OWNER:**

Wilkinson County  
Post Office Box 161 / 100 Bacon Street  
Irwinton, GA 31042

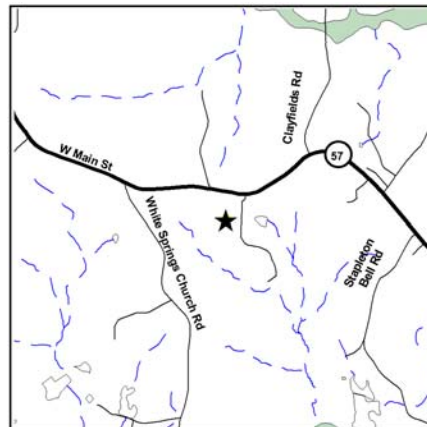

**STATUS OF CLEANUP ACTIVITIES:**

Cleanup activities are being conducted for source materials and groundwater.

**CLEANUP PRIORITY:** The Director has designated this site as a Class IV

**GA EPD DIRECTOR'S DETERMINATION REGARDING CORRECTIVE ACTION:**

The Director has determined that this site requires corrective action.

**REGULATED SUBSTANCES RELEASED, AND THREATS TO HUMAN HEALTH AND ENVIRONMENT POSED BY THE RELEASE:**

This site has a known release of Mercury in groundwater at levels exceeding the reportable quantity. No human exposure via drinking water is suspected from this release. The nearest drinking water well is less than 0.5 miles from the area affected by the release.

**REGULATED SUBSTANCES:**

Substance Name	GW	Soil	Substance Name	GW	Soil
1,1,1-Trichloroethane	<input checked="" type="checkbox"/>	<input type="checkbox"/>	1,1-Dichloroethane	<input checked="" type="checkbox"/>	<input type="checkbox"/>
Barium	<input checked="" type="checkbox"/>	<input type="checkbox"/>	Benzene	<input checked="" type="checkbox"/>	<input type="checkbox"/>
Beryllium	<input checked="" type="checkbox"/>	<input type="checkbox"/>	Cis-1,2-Dichloroethene	<input checked="" type="checkbox"/>	<input type="checkbox"/>
Dichloromethane	<input checked="" type="checkbox"/>	<input type="checkbox"/>	Dieldrin	<input checked="" type="checkbox"/>	<input type="checkbox"/>
Ethylbenzene	<input checked="" type="checkbox"/>	<input type="checkbox"/>	Mercury	<input checked="" type="checkbox"/>	<input type="checkbox"/>
p-Cresol	<input checked="" type="checkbox"/>	<input type="checkbox"/>	Zinc	<input checked="" type="checkbox"/>	<input type="checkbox"/>

**SITE NAME:** Woodall Creek Site  
**LOCATION:** 1400 Block of Ellsworth Industrial Blvd.  
Atlanta, Fulton County, GA 30318

Latitude 33° 47' 46" N Longitude 84° 25' 30" W

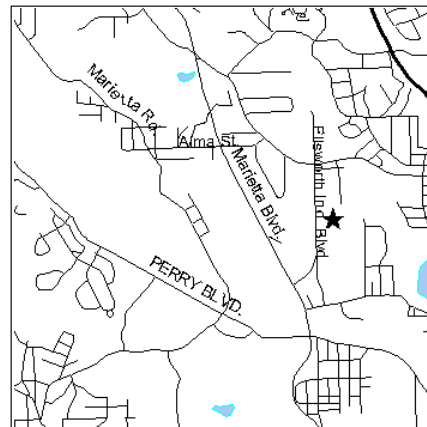

ACREAGE	PARCEL NUMBER	DATE LISTED
2.18	17-191-LL-42	11/17/2000
11.51	17-187-LL-73	11/17/2000
1.991	17-187-LL-72	11/17/2000
3.89	17-187-LL-70	11/17/2000
3.59	17-187-LL-69	11/17/2000
0.9504	17-187-LL-59	11/17/2000
5.98	42; 17-188-001-17	11/17/2000
4.78	42; 17-188-001-16	11/17/2000
5	42; 17-188-001-15	11/17/2000
1.32	17-191-LL-22	11/17/2000

**LAST KNOWN PROPERTY OWNER:**  
Southern Metals Finishing Company  
1591 Huber Street, NW  
Atlanta, Georgia 30318-7701

**STATUS OF CLEANUP ACTIVITIES:**

Cleanup activities are being conducted for source materials, soil, and groundwater.

**CLEANUP PRIORITY:** The Director has designated this site as a Class I

**GA EPD DIRECTOR'S DETERMINATION REGARDING CORRECTIVE ACTION:**

The Director has determined that this site requires corrective action.

**REGULATED SUBSTANCES RELEASED, AND THREATS TO HUMAN HEALTH AND ENVIRONMENT POSED BY THE RELEASE:**

The Director has determined that a release of regulated substances from groundwater to a water of the state has resulted in an exceedance of state water quality standards.

**REGULATED SUBSTANCES:**

Substance Name	GW	Soil	Substance Name	GW	Soil
1,1-Dichloroethene	<input checked="" type="checkbox"/>	<input type="checkbox"/>	Cis-1,2-Dichloroethene	<input checked="" type="checkbox"/>	<input type="checkbox"/>
Tetrachloroethene	<input checked="" type="checkbox"/>	<input type="checkbox"/>	Vinyl chloride	<input checked="" type="checkbox"/>	<input type="checkbox"/>

**SITE NAME:** Imperial Cleaners (Former)  
**LOCATION:** 1201 Alpharetta Street  
Roswell, Fulton County, GA 30075

Latitude 34° 1' 54" N Longitude 84° 21' 1" W

**ACREAGE** 9.11      **PARCEL NUMBER** 12199304500635      **DATE LISTED** 1/5/2001

**LAST KNOWN PROPERTY OWNER:**

PM Ltd., a Georgia Limited Partnership (Trust Co. Bank INV ADV)  
c/o SunTrust Bank, 25 Park Place  
Atlanta, GA 30003

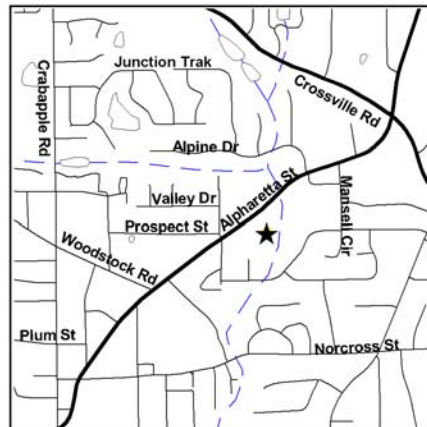

**STATUS OF CLEANUP ACTIVITIES:**

Cleanup activities are being conducted for source materials, soil, and groundwater.

**CLEANUP PRIORITY:** The Director has designated this site as a Class I

**GA EPD DIRECTOR'S DETERMINATION REGARDING CORRECTIVE ACTION:**

The Director has determined that this site requires corrective action.

**REGULATED SUBSTANCES RELEASED, AND THREATS TO HUMAN HEALTH AND ENVIRONMENT POSED BY THE RELEASE:**

This site has a known release of Vinyl chloride in groundwater at levels exceeding the reportable quantity. No human exposure via drinking water is suspected from this release. The nearest drinking water well is between 1 and 2 miles from the area affected by the release.

This site has a known release of Tetrachloroethene in soil at levels exceeding the reportable quantity. This site has unlimited access. The nearest resident individual is less than 300 feet from the area affected by the release.

**REGULATED SUBSTANCES:**

Substance Name	GW	Soil	Substance Name	GW	Soil
Cis-1,2-Dichloroethene	<input checked="" type="checkbox"/>	<input type="checkbox"/>	Tetrachloroethene	<input checked="" type="checkbox"/>	<input checked="" type="checkbox"/>
trans-1,2-Dichloroethene	<input checked="" type="checkbox"/>	<input type="checkbox"/>	Trichloroethene	<input checked="" type="checkbox"/>	<input type="checkbox"/>
Vinyl chloride	<input checked="" type="checkbox"/>	<input type="checkbox"/>			

**SITE NAME:** Basket Creek Drum Disposal Site  
**LOCATION:** 7840 Basket Creek Road  
Douglasville, Douglas County, GA 30135

Latitude 33° 35' 27" N Longitude 84° 48' 59" W

<b>ACREAGE</b>	<b>PARCEL NUMBER</b>	<b>DATE LISTED</b>
5.2	48-3-5-27	1/18/2001

**LAST KNOWN PROPERTY OWNER:**  
Estate of Harriett Foster c/o L. Cleaton, Executor  
2704 Bonaire Terrace  
Marietta, GA 30066

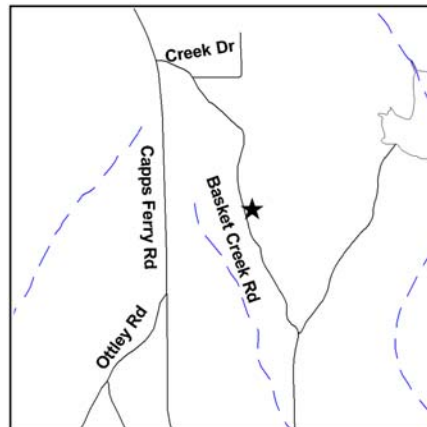

**STATUS OF CLEANUP ACTIVITIES:**

Cleanup activities are being conducted for source materials, soil, and groundwater.

**CLEANUP PRIORITY:** The Director has designated this site as a Class I

**GA EPD DIRECTOR'S DETERMINATION REGARDING CORRECTIVE ACTION:**

The Director has determined that this site requires corrective action.

**REGULATED SUBSTANCES RELEASED, AND THREATS TO HUMAN HEALTH AND ENVIRONMENT POSED BY THE RELEASE:**

This site has a known release of Arsenic in soil at levels exceeding the reportable quantity. This site has unlimited access. The nearest resident individual is less than 300 feet from the area affected by the release.

**REGULATED SUBSTANCES:**

Substance Name	GW	Soil	Substance Name	GW	Soil
Aroclor 1248	<input type="checkbox"/>	<input checked="" type="checkbox"/>	Arsenic	<input type="checkbox"/>	<input checked="" type="checkbox"/>

**SITE NAME:** Junction Cleaners  
**LOCATION:** 2635 Sandy Plains Road  
Marietta, Cobb County, GA 30066

Latitude 34° 0' 54" N Longitude 84° 29' 43" W

**ACREAGE** 1.53      **PARCEL NUMBER** 16059500160      **DATE LISTED** 2/28/2001

**LAST KNOWN PROPERTY OWNER:**  
Sandy Plains Junction of Marietta LLC  
2783 Rolling View Drive  
Jonesboro, GA 30236



**STATUS OF CLEANUP ACTIVITIES:**

Hazardous Site Response Act cleanup levels have been met for source materials and soil. Cleanup activities are being conducted for groundwater.

**CLEANUP PRIORITY:** The Director has designated this site as a Class I

**GA EPD DIRECTOR'S DETERMINATION REGARDING CORRECTIVE ACTION:**

The Director has determined that this site requires corrective action.

**REGULATED SUBSTANCES RELEASED, AND THREATS TO HUMAN HEALTH AND ENVIRONMENT POSED BY THE RELEASE:**

This site has a known release of Tetrachloroethene in groundwater at levels exceeding the reportable quantity. This release has resulted in known human exposure greater than or equal to the MCL for Tetrachloroethene.

**REGULATED SUBSTANCES:**

Substance Name	GW	Soil	Substance Name	GW	Soil
Acetone	<input checked="" type="checkbox"/>	<input type="checkbox"/>	Chloroform	<input checked="" type="checkbox"/>	<input type="checkbox"/>
Cis-1,2-Dichloroethene	<input checked="" type="checkbox"/>	<input type="checkbox"/>	Methyl ethyl ketone	<input checked="" type="checkbox"/>	<input type="checkbox"/>
Methyl isobutyl ketone	<input checked="" type="checkbox"/>	<input type="checkbox"/>	Tetrachloroethene	<input checked="" type="checkbox"/>	<input type="checkbox"/>
Trichloroethene	<input checked="" type="checkbox"/>	<input type="checkbox"/>			



**SITE NAME:** Hercules, Inc.  
**LOCATION:** 3000 Louisville Road  
Savannah, Chatham County, GA 31415

Latitude 32° 5' 17" N Longitude 81° 8' 52" W

<b>ACREAGE</b>	<b>PARCEL NUMBER</b>	<b>DATE LISTED</b>
13.34	2-0734-01-001	3/22/2001
7.8	2-0734-03-001	3/22/2001

**LAST KNOWN PROPERTY OWNER:**

Hercules, Inc.  
1313 Market Street  
Wilmington, Delaware 19894

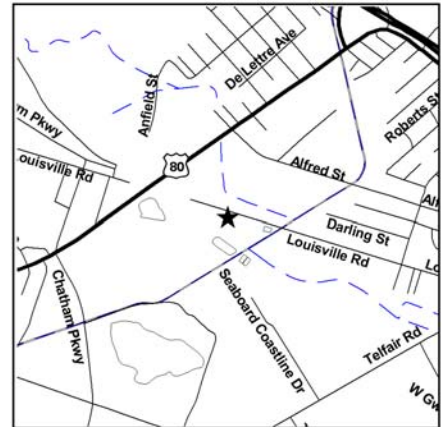

**STATUS OF CLEANUP ACTIVITIES:**

Cleanup activities are being conducted for source materials, soil, and groundwater.

**CLEANUP PRIORITY:** The Director has designated this site as a Class V

**GA EPD DIRECTOR'S DETERMINATION REGARDING CORRECTIVE ACTION:**

The Director has determined that this site requires corrective action.

**REGULATED SUBSTANCES RELEASED, AND THREATS TO HUMAN HEALTH AND ENVIRONMENT POSED BY THE RELEASE:**

This site has a known release of Acrolein in groundwater at levels exceeding the reportable quantity. No human exposure via drinking water is suspected from this release. The nearest drinking water well is less than 0.5 miles from the area affected by the release.

This site has a known release of Cyanides (soluble salts and complexes) n.o.s. in soil at levels exceeding the reportable quantity. This site has limited access. The nearest resident individual is between 301 and 1000 feet from the area affected by the release.

**REGULATED SUBSTANCES:**

Substance Name	GW	Soil	Substance Name	GW	Soil
1,2-Dichloropropane	<input checked="" type="checkbox"/>	<input type="checkbox"/>	1,4-Dioxane	<input checked="" type="checkbox"/>	<input type="checkbox"/>
Acenaphthene	<input checked="" type="checkbox"/>	<input type="checkbox"/>	Acetone	<input type="checkbox"/>	<input checked="" type="checkbox"/>
Acetone cyanohydrin	<input checked="" type="checkbox"/>	<input type="checkbox"/>	Acrolein	<input checked="" type="checkbox"/>	<input checked="" type="checkbox"/>
Aniline	<input type="checkbox"/>	<input checked="" type="checkbox"/>	Aroclor 1254	<input checked="" type="checkbox"/>	<input type="checkbox"/>
Asbestos	<input type="checkbox"/>	<input checked="" type="checkbox"/>	Benzene	<input checked="" type="checkbox"/>	<input type="checkbox"/>
Benzo(a)anthracene	<input type="checkbox"/>	<input checked="" type="checkbox"/>	Benzo(a)pyrene	<input type="checkbox"/>	<input checked="" type="checkbox"/>
Benzo(b)fluoranthene	<input type="checkbox"/>	<input checked="" type="checkbox"/>	Benzo(k)fluoranthene	<input type="checkbox"/>	<input checked="" type="checkbox"/>
bis(2-Ethylhexyl) phthalate	<input checked="" type="checkbox"/>	<input checked="" type="checkbox"/>	Carbon disulfide	<input checked="" type="checkbox"/>	<input type="checkbox"/>
Chrysene	<input type="checkbox"/>	<input checked="" type="checkbox"/>	Cyanides (soluble salts and complexes) n.o.s.	<input type="checkbox"/>	<input checked="" type="checkbox"/>
DDT	<input checked="" type="checkbox"/>	<input type="checkbox"/>	Dioxin	<input checked="" type="checkbox"/>	<input type="checkbox"/>
Endrin aldehyde	<input checked="" type="checkbox"/>	<input type="checkbox"/>	Ethylbenzene	<input checked="" type="checkbox"/>	<input type="checkbox"/>
Fluoranthene	<input checked="" type="checkbox"/>	<input type="checkbox"/>	Formaldehyde	<input checked="" type="checkbox"/>	<input checked="" type="checkbox"/>
Isobutyl alcohol	<input checked="" type="checkbox"/>	<input checked="" type="checkbox"/>	Lead	<input checked="" type="checkbox"/>	<input type="checkbox"/>
Methyl ethyl ketone	<input type="checkbox"/>	<input checked="" type="checkbox"/>	Naphthalene	<input checked="" type="checkbox"/>	<input type="checkbox"/>
N-Nitrosodimethylamine	<input checked="" type="checkbox"/>	<input type="checkbox"/>	N-Nitrosodi-n-butylamine	<input checked="" type="checkbox"/>	<input type="checkbox"/>
Parathion	<input type="checkbox"/>	<input checked="" type="checkbox"/>	Phenanthrene	<input type="checkbox"/>	<input checked="" type="checkbox"/>
Pyrene	<input checked="" type="checkbox"/>	<input type="checkbox"/>	Toluene	<input checked="" type="checkbox"/>	<input type="checkbox"/>
Xylenes	<input checked="" type="checkbox"/>	<input type="checkbox"/>			

**SITE NAME:** Norfolk Southern - Natrochem, Inc., Site  
**LOCATION:** Dillard Road (former Cinder Street)  
Savannah, Chatham County, GA 31498

Latitude 32° 5' 6" N Longitude 81° 6' 37" W

**ACREAGE** 3.43 **PARCEL NUMBER** 2-0018-01-008 **DATE LISTED** 3/20/2001

**LAST KNOWN PROPERTY OWNER:**

Exley Land Holdings, LLC  
P.O. Box 1205  
Savannah, GA 31402

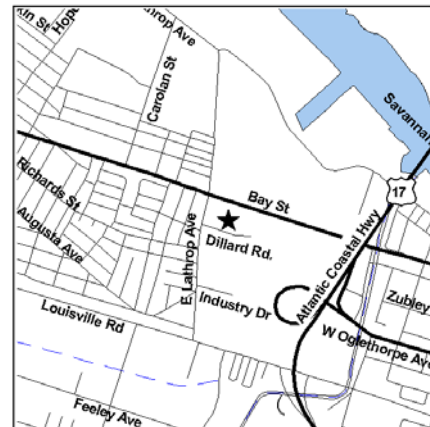

**STATUS OF CLEANUP ACTIVITIES:**

Cleanup activities are being conducted for source materials and soil. Investigations are being conducted to determine how much cleanup is necessary for groundwater.

**CLEANUP PRIORITY:** The Director has designated this site as a Class II

**GA EPD DIRECTOR'S DETERMINATION REGARDING CORRECTIVE ACTION:**

Pending

**REGULATED SUBSTANCES RELEASED, AND THREATS TO HUMAN HEALTH AND ENVIRONMENT POSED BY THE RELEASE:**

This site has a known release of Benzene in groundwater at levels exceeding the reportable quantity. No human exposure via drinking water is suspected from this release. The nearest drinking water well is between 0.5 and 1 miles from the area affected by the release.

This site has a known release of Benzo(a)pyrene in soil at levels exceeding the reportable quantity. This site has unlimited access. The nearest resident individual is between 1001 and 3000 feet from the area affected by the release.

**REGULATED SUBSTANCES:**

Substance Name	GW	Soil	Substance Name	GW	Soil
Acenaphthene	<input checked="" type="checkbox"/>	<input type="checkbox"/>	Acenaphthylene	<input type="checkbox"/>	<input checked="" type="checkbox"/>
Acetone	<input type="checkbox"/>	<input checked="" type="checkbox"/>	Benzene	<input checked="" type="checkbox"/>	<input type="checkbox"/>
Benzo(a)anthracene	<input type="checkbox"/>	<input checked="" type="checkbox"/>	Benzo(a)pyrene	<input type="checkbox"/>	<input checked="" type="checkbox"/>
Benzo(b)fluoranthene	<input type="checkbox"/>	<input checked="" type="checkbox"/>	Benzo(k)fluoranthene	<input type="checkbox"/>	<input checked="" type="checkbox"/>
Chrysene	<input type="checkbox"/>	<input checked="" type="checkbox"/>	Dibenzo(a,h)anthracene	<input type="checkbox"/>	<input checked="" type="checkbox"/>
Ethylbenzene	<input checked="" type="checkbox"/>	<input checked="" type="checkbox"/>	Fluoranthene	<input type="checkbox"/>	<input checked="" type="checkbox"/>
Fluorene	<input checked="" type="checkbox"/>	<input type="checkbox"/>	Indeno(1,2,3-cd)pyrene	<input type="checkbox"/>	<input checked="" type="checkbox"/>
Naphthalene	<input checked="" type="checkbox"/>	<input checked="" type="checkbox"/>	Phenanthrene	<input type="checkbox"/>	<input checked="" type="checkbox"/>
Pyrene	<input type="checkbox"/>	<input checked="" type="checkbox"/>	Toluene	<input checked="" type="checkbox"/>	<input checked="" type="checkbox"/>
Xylenes	<input checked="" type="checkbox"/>	<input checked="" type="checkbox"/>			