



## **ENVIRONMENTAL PROTECTION DIVISION**

**Richard E. Dunn, Director**

---

**EPD Director's Office**

2 Martin Luther King, Jr. Drive  
Suite 1456, East Tower  
Atlanta, Georgia 30334  
404-656-4713

### **CATEGORICAL EXCLUSION DETERMINATION**

Fayetteville WPCP Improvements  
City of Fayetteville (Fayette County)  
GEFA Loan No. CW-2019-014

The Georgia Environmental Protection Division (EPD) has conducted a review of the above project in accordance with the State's Environmental Review Process (SERP). EPD has determined that this project is eligible for a categorical exclusion. Accordingly, no further environmental review is planned. The proposed project consists of the construction of new influent splitter boxes, construction of a new anaerobic basin, replacement of mixers in the existing equalization basin, conversion of sequencing batch reactors to conventional aeration basins, conversion of existing aeration basins to clarifiers, replacement of sand filters with cloth media disc filters, and replacement or repair of other ancillary equipment.

This project is eligible for a categorical exclusion because it meets the following specific criteria, outlined in the SERP: functional replacement of equipment, minor rehabilitation of existing facilities, and construction of new ancillary facilities adjacent to existing facilities that do not affect the degree of treatment or capacity of the existing facility. Furthermore: the project will not create a new or relocate an existing discharge to surface or ground waters; the project will not substantially increase the volume of discharge or loading of pollutants; the project will not provide capacity to serve a population 30% greater than the existing population; the project will not have a significant effect on the quality of the human environment; the action will not directly or indirectly affect cultural resources, habitats of endangered or threatened species, or environmentally important natural resource areas; and the action is cost-effective and should cause no significant public controversy.

This determination becomes effective after thirty (30) days following its distribution by EPD. This exclusion may be revoked at any time if: 1) the project is altered and no longer meets the requirements of a categorical exclusion, 2) new evidence shows that serious environmental issues exist, or 3) a local, State or Federal law is being or may be violated. The information which supports this decision is on file with the Georgia Environmental Protection Division and is available for public scrutiny upon request. A copy of the proposed project documentation is also available for review at Fayetteville City Hall in Fayette County, Georgia.

All interested agencies, groups and persons supporting or disagreeing with this decision are invited to submit comments within thirty (30) days of the publish date of this notice via email to [josh.hayes@dnr.ga.gov](mailto:josh.hayes@dnr.ga.gov) or to the following address:

Georgia Environmental Protection Division  
Watershed Protection Branch  
Wastewater Regulatory Program  
ATTN: Josh Hayes  
2 Martin Luther King Jr. Drive, Suite 1152 East  
Atlanta, Georgia 30334

After evaluating the comments received, EPD will make a final decision regarding approval of the project. No administrative action will be taken on the project for thirty (30) calendar days after publication of this Notice.

Publish Date: JUN 11 2019

  
Richard E. Dunn, Director  
Environmental Protection Division

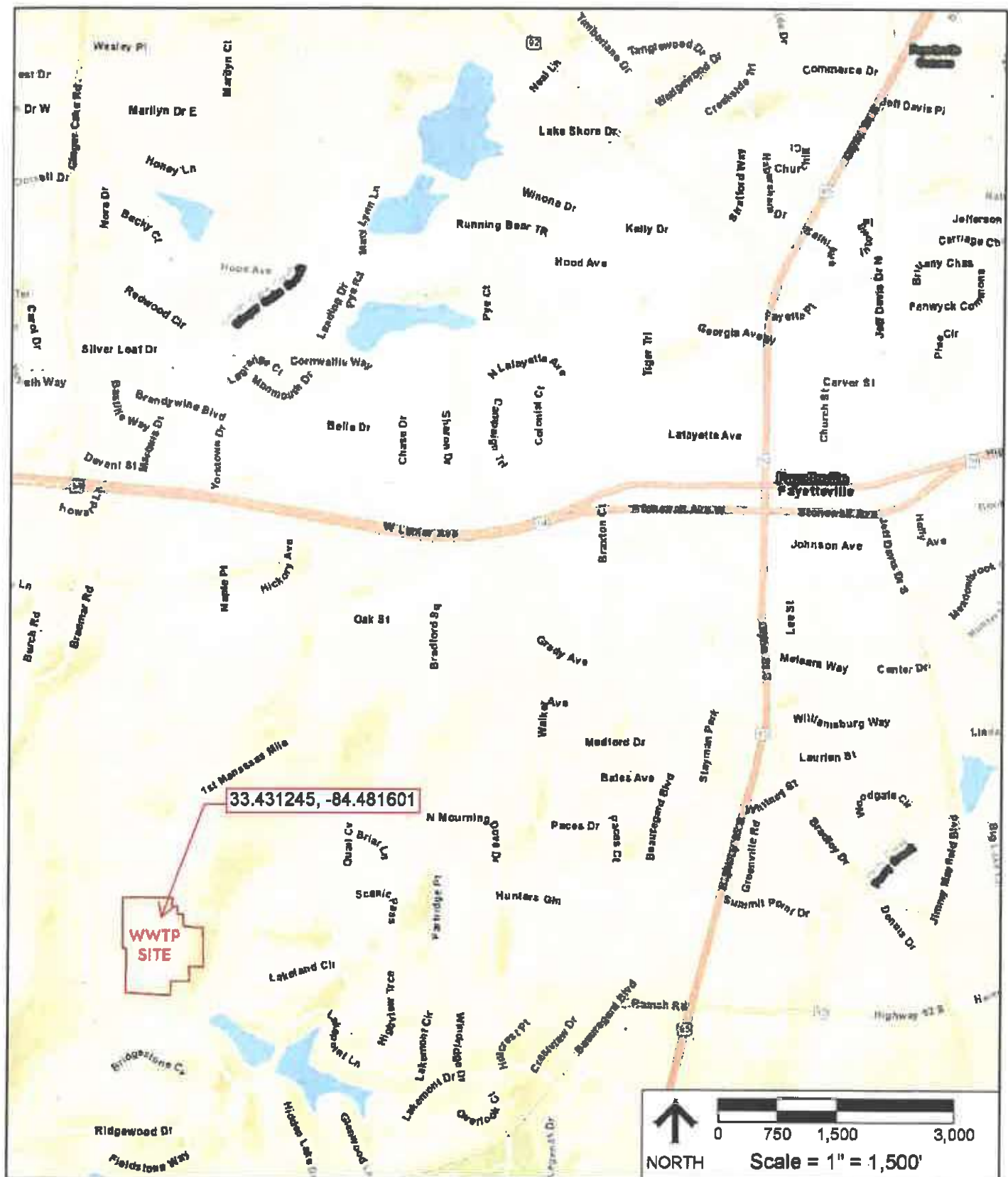

REF. SHEET: ESRI WORLD STREETS  
DESCRIPTION: ENVIRONMENTAL INFORMATION DOCUMENT

# **Fayetteville WWTP Improvements** FAYETTEVILLE, FAYETTE COUNTY, GEORGIA

## **FIGURE 1**

GENERAL LOCATION MAP  
GMC# EATL18A008  
DATE: 11/28/16  
DRAWN BY: BMI

2880 East Chase Lane, Selts 200  
Montgomery, AL 38117  
T 334.271.3200  
GMCNETWORK.COM

**GMC**