

Document Path: \\gis-s3\GIS\_Data\Sandbox\Projects\A-E\Ashland\_Brunswick\GAI\WBS2014B2\Layout\2016\_December\GWF\Figure\_04\_Potentiometric\_Shallow\_Zone\_201612.mxd

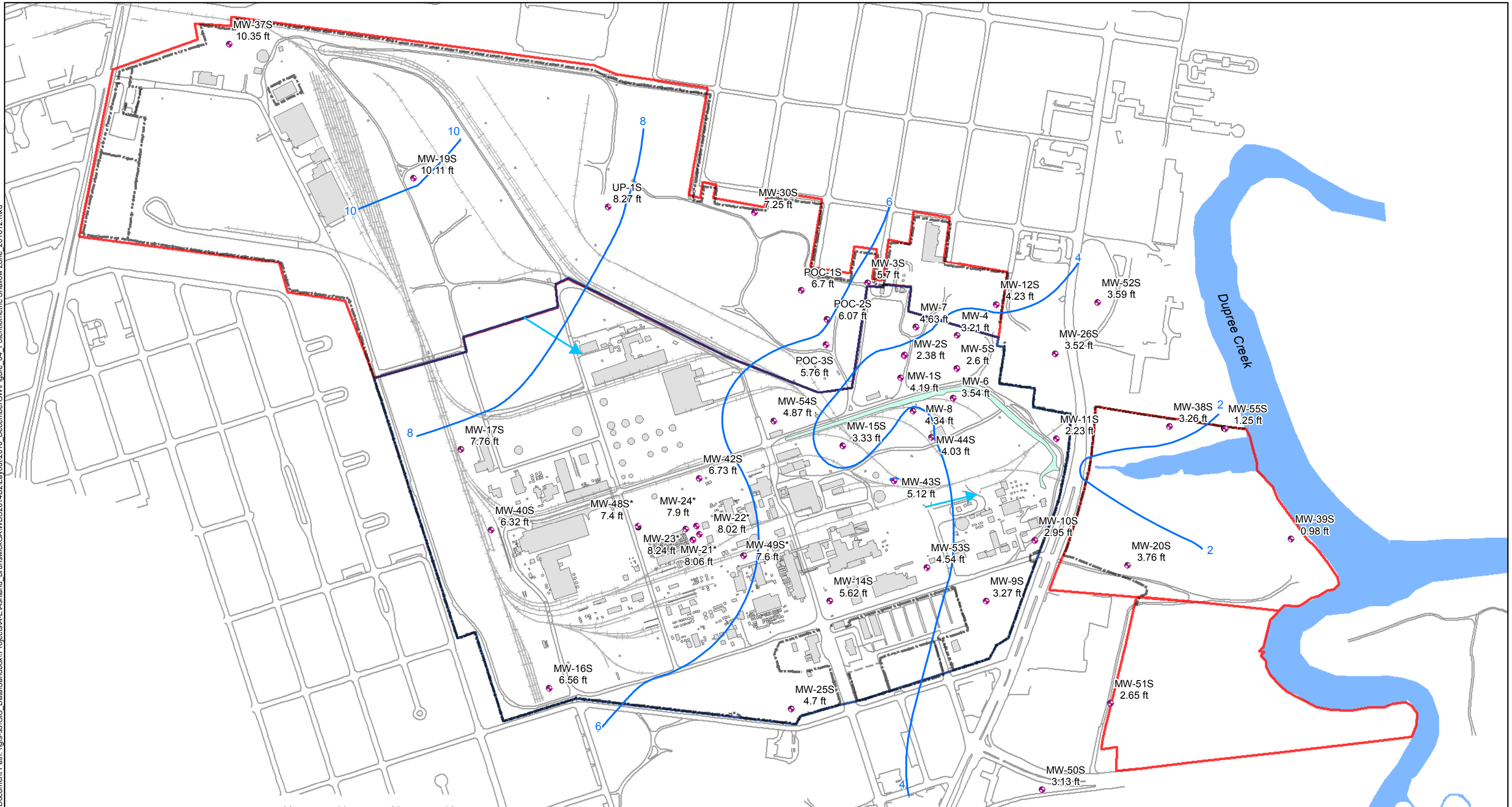

POTENTIOMETRIC MAP - SURFICIAL AQUIFER, SHALLOW ZONE OF UPPER UNIT  
 FORMER HERCULES BRUNSWICK FACILITY  
 2801 COOK STREET  
 BRUNSWICK, GLYNN COUNTY, GEORGIA

PROJECT NO. 190106854A	PREPARED BY SAA	REF SCALE 1:6,000
DATE 1/30/2017	REVIEWED BY CW	MAP SCALE 1 inch = 500 feet



**Legend**

- ◆ Shallow Monitoring Well
- N Street Ditch
- Fence
- Pinova Property
- Hercules Property
- Road
- Railroad
- Site Building
- Creek
- Potentiometric Surface Contour (feet msl)
- ➔ General Groundwater Flow Direction

6.56 ft Groundwater elevation (feet msl)

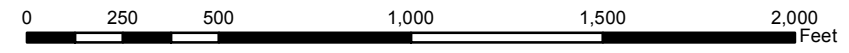

Notes:  
 Groundwater elevations measured on 12/12/2016  
 \*= Groundwater Elevation not used in contouring



Document Path: \\gis-s3\GIS\_Data\Sandbox\Projects\A-E\Ashland\_Brunswick\GAI\WBS2014B2\Layout\2016\_December\GW\Figure\_05\_Potentiometric Intermediate Zone\_201612.mxd

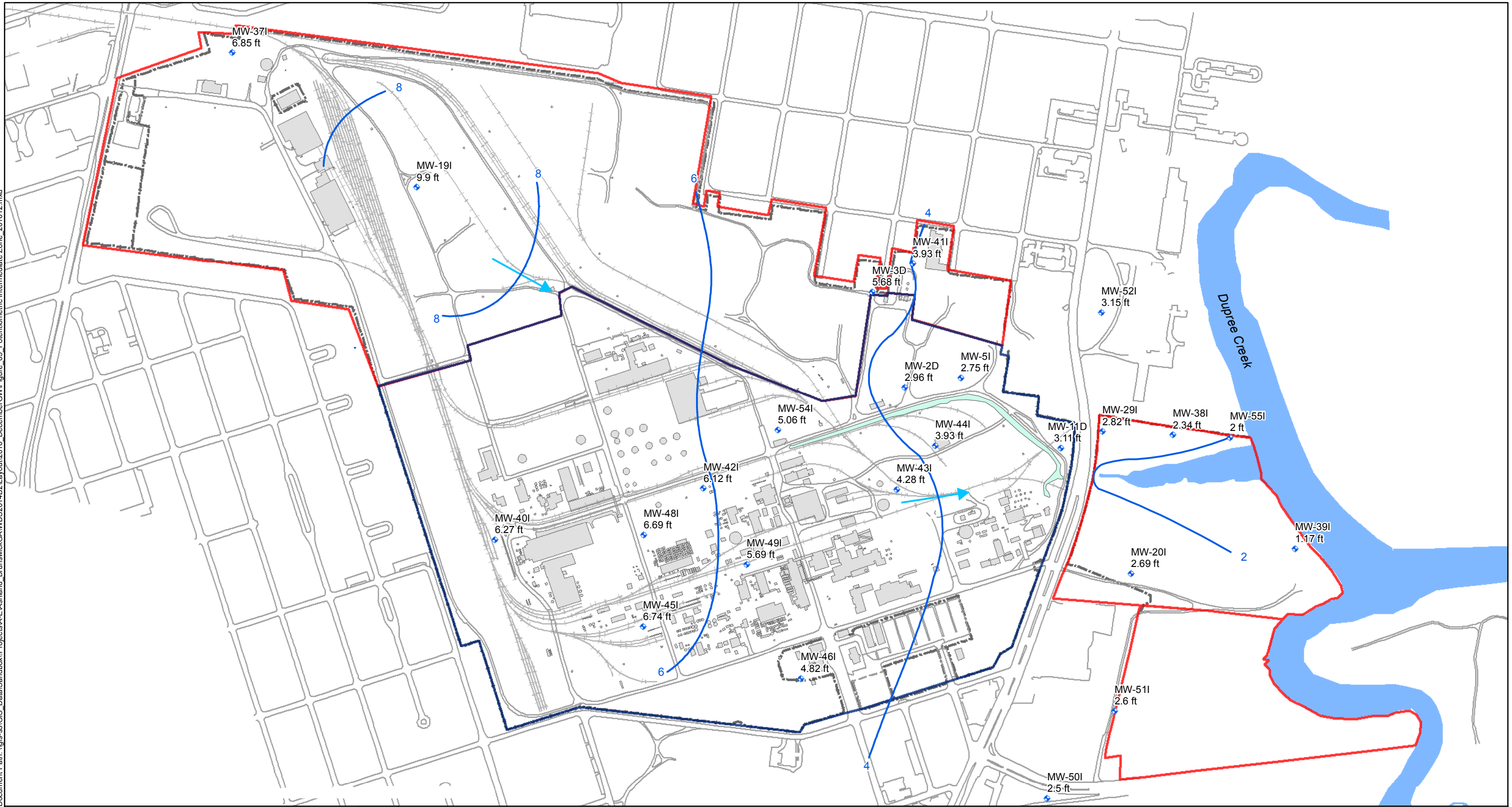

POTENTIOMETRIC MAP - SURFICIAL AQUIFER, INTERMEDIATE ZONE OF UPPER UNIT  
 FORMER HERCULES BRUNSWICK FACILITY  
 2801 COOK STREET  
 BRUNSWICK, GLYNN COUNTY, GEORGIA

PROJECT NO. 190106854A	PREPARED BY SAA	REF SCALE 1:6,000
DATE 01/30/2017	REVIEWED BY CW	MAP SCALE 1 inch = 500 feet



**Legend**

- ◆ Intermediate Monitoring Well
- N Street Ditch
- Fence
- Pinova Property
- Hercules Property
- Road
- Railroad
- Site Building
- Creek
- Potentiometric Surface Contour (feet msl)
- ➔ General Groundwater Flow Direction
- 6.56 ft Groundwater elevation (ft msl)

Notes:  
Groundwater elevations measured on 12/12/2016

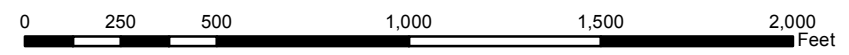



Document Path: \\gis-s3\GIS\_Data\ Sandbox\Projects\A-E\Ashland\_Brunswick\GAI\WBS2014B2\Layout\2016\_December\GWF\Figure\_06\_Potentiometric\_Deep\_Zone\_201612.mxd

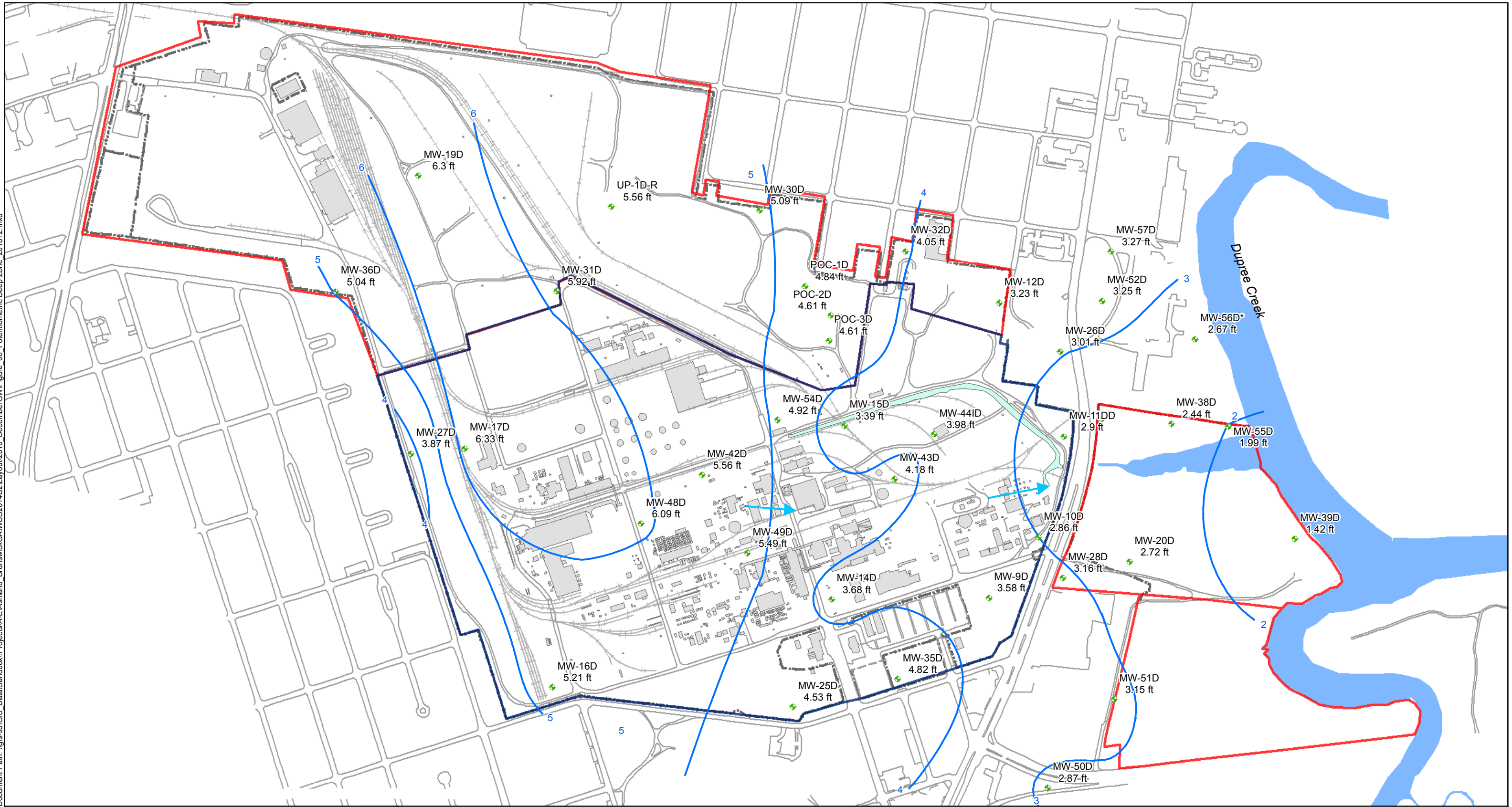

**POTENTIOMETRIC MAP - SURFICIAL AQUIFER, DEEP ZONE OF UPPER UNIT  
FORMER HERCULES BRUNSWICK FACILITY  
2801 COOK STREET  
BRUNSWICK, GLYNN COUNTY, GEORGIA**

PROJECT NO. 190106854A	PREPARED BY SAA	REF SCALE 1:6,000
DATE 09/16/2016	REVIEWED BY CW	MAP SCALE 1 inch = 500 feet

**Legend**

- ◆ Deep Monitoring Well
- N Street Ditch
- Fence
- Pinova Property
- Hercules Property
- Road
- Railroad
- Site Building
- Creek
- Potentiometric Surface Contour (feet msl)
- ➔ General Groundwater Flow Direction
- 6.56 ft Groundwater Elevation (feet msl)

**Notes:**  
Groundwater elevations measured on 12/12/2016  
\* = Groundwater elevation not used for contouring

Document Path: \\gis-s3\GIS\_Data\Sandbox\Projects\A-E\Ashland\_Brunswick\GAI\WBS2014B2\Layout\2016\_December\GWI\Figure\_07\_Potentiometric Lower Zone\_201612.mxd

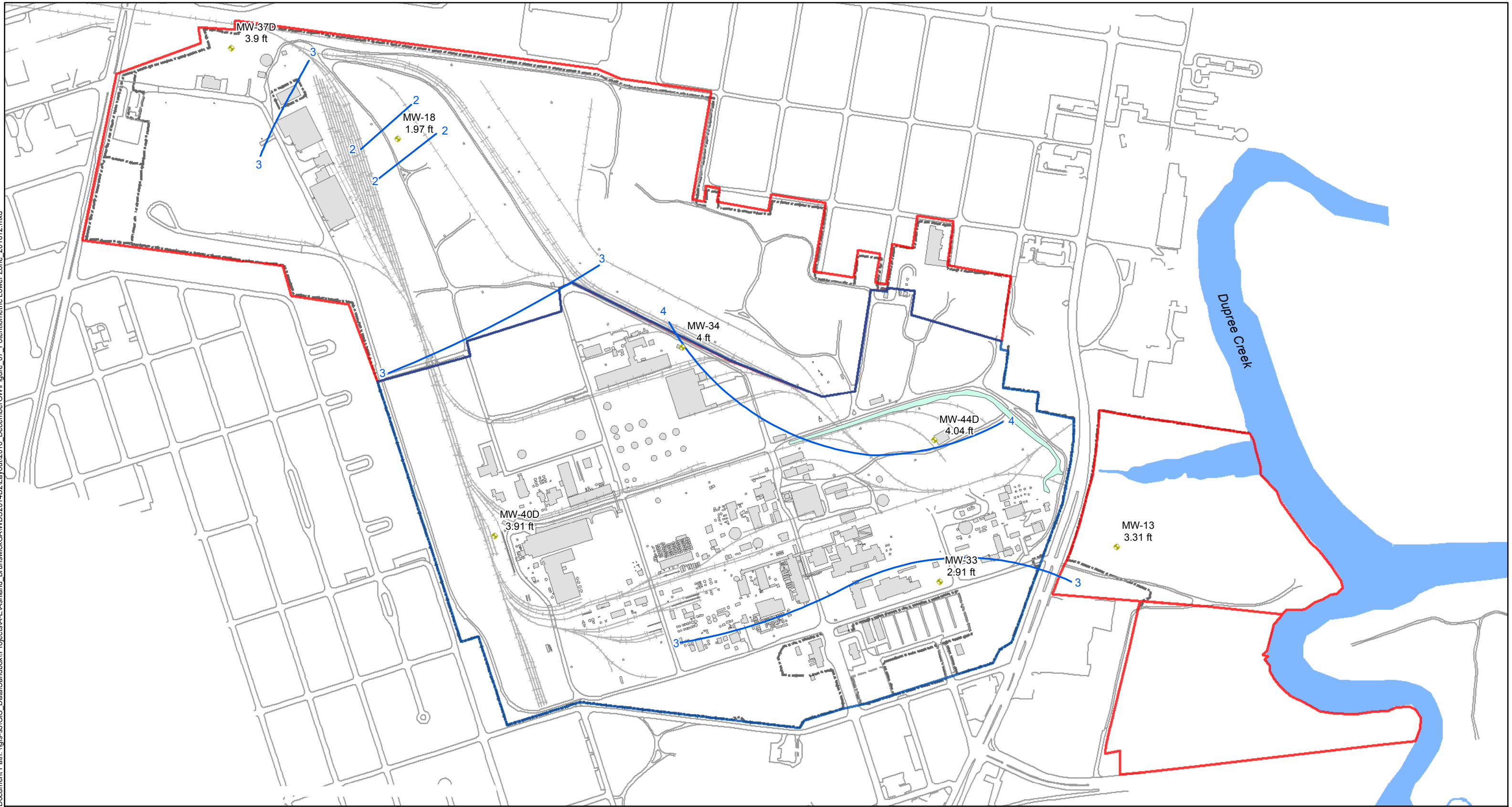

POTENTIOMETRIC MAP - SURFICIAL AQUIFER, LOWER UNIT  
 FORMER HERCULES BRUNSWICK FACILITY  
 2801 COOK STREET  
 BRUNSWICK, GLYNN COUNTY, GEORGIA

PROJECT NO. 190106854A	PREPARED BY SAA	REF SCALE 1:6,000
DATE 09/16/2016	REVIEWED BY CW	MAP SCALE 1 inch = 500 feet



**Legend**

- ◆ Lower Unit Monitoring Well
- N Street Ditch
- Pinova Property
- Hercules Property
- Road
- Railroad
- Site Building
- Fence
- Creek

— Potentiometric Surface Contour (feet msl)  
 6.56 ft Groundwater Elevation (feet msl)

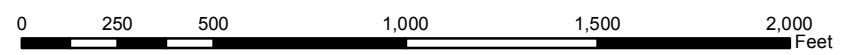

Notes:  
 Groundwater elevations measured on 12/12/2016

