

**GEORGIA ENVIRONMENTAL PROTECTION DIVISION
HAZARDOUS SITE INVENTORY**

Site Number **10637**

SITE NAME: Welcome Years, Inc.
LOCATION: 1115 Howell Mill Road
Atlanta, Fulton County, GA 30318

Latitude 33° 47' 06" N Longitude 84° 24' 38" W

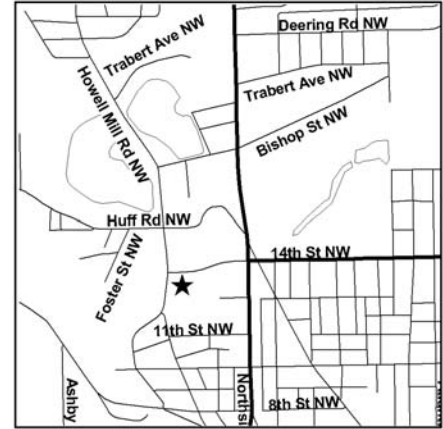

ACREAGE	PARCEL NUMBER	DATE LISTED
0.2445	17-0150-0009-061-5	9/18/2000
0.8923	17-0150-0009-014-4	9/18/2000
0.905	17-0150-0009-071-4	9/18/2000
5.29	17-0150-0009-076-3	9/18/2000
0.7025	17-0150-0009-062-3	9/18/2000
1.57	17-0150-0009-013-6	9/18/2000
3.21	17-0150-0009-064-9	9/18/2000

LAST KNOWN PROPERTY OWNER:

VLP2, LLC / c/o Anthony J. Zivalich, Jr.
221 Uncle Heinie Way
Atlanta, GA 30332-0257

STATUS OF CLEANUP ACTIVITIES:

Cleanup activities are being conducted for source materials, soil, and groundwater.

CLEANUP PRIORITY: The Director has designated this site as a Class V

GA EPD DIRECTOR'S DETERMINATION REGARDING CORRECTIVE ACTION:

The Director has determined that this site requires corrective action.

REGULATED SUBSTANCES RELEASED, AND THREATS TO HUMAN HEALTH AND ENVIRONMENT POSED BY THE RELEASE:

This site has a known release of Lead in soil at levels exceeding the reportable quantity. This site has limited access. The nearest resident individual is between 301 and 1000 feet from the area affected by the release.

REGULATED SUBSTANCES:

Substance Name	GW	Soil	Substance Name	GW	Soil
Arsenic	<input type="checkbox"/>	<input checked="" type="checkbox"/>	Barium	<input checked="" type="checkbox"/>	<input checked="" type="checkbox"/>
Benzene	<input checked="" type="checkbox"/>	<input type="checkbox"/>	Cadmium	<input type="checkbox"/>	<input checked="" type="checkbox"/>
Chromium	<input type="checkbox"/>	<input checked="" type="checkbox"/>	Ethylbenzene	<input checked="" type="checkbox"/>	<input checked="" type="checkbox"/>
Lead	<input type="checkbox"/>	<input checked="" type="checkbox"/>	Naphthalene	<input checked="" type="checkbox"/>	<input checked="" type="checkbox"/>
Tetrachloroethene	<input checked="" type="checkbox"/>	<input type="checkbox"/>	Toluene	<input checked="" type="checkbox"/>	<input checked="" type="checkbox"/>
Xylenes	<input checked="" type="checkbox"/>	<input checked="" type="checkbox"/>			