

**GEORGIA ENVIRONMENTAL PROTECTION DIVISION
HAZARDOUS SITE INVENTORY**

Site Number **10956**

SITE NAME: Ace Pole Company
LOCATION: 6352 Timber Lane
Blackshear, Pierce County, GA 31516

Latitude 31° 15' 24" N Longitude 82° 17' 35" W

| | | |
|----------------|----------------------|--------------------|
| ACREAGE | PARCEL NUMBER | DATE LISTED |
| 86.77 | 024 155 | 5/28/2020 |
| 101.75 | 024D 040 | 5/28/2020 |

LAST KNOWN PROPERTY OWNER:

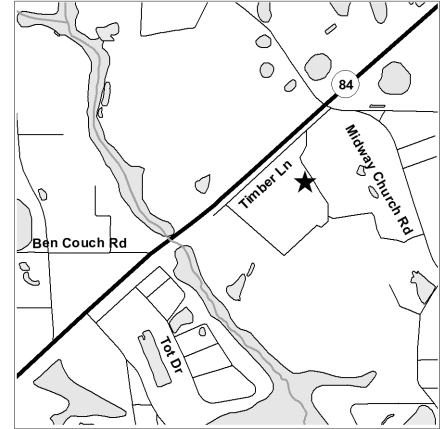

Ace Pole Company, Inc.
P.O. Box 1323
Waycross, GA 31502

Eunice Family LLLP
2679 Midway Church Road
Blackshear, GA 31516

STATUS OF CLEANUP ACTIVITIES:

Cleanup activities are being conducted for source materials, soil, and groundwater.

CLEANUP PRIORITY: The Director has designated this site as a Class V

GA EPD DIRECTOR'S DETERMINATION REGARDING CORRECTIVE ACTION:

The Director has determined that this site requires corrective action.

REGULATED SUBSTANCES RELEASED, AND THREATS TO HUMAN HEALTH AND ENVIRONMENT POSED BY THE RELEASE:

This site has a known release of Chromium (VI) in groundwater at levels exceeding the reportable quantity. No human exposure via drinking water is suspected from this release. The nearest drinking water well is less than 0.5 miles from the area affected by the release.

This site has a known release of Arsenic in soil at levels exceeding the reportable quantity. This site has unlimited access. The nearest resident individual is between 301 and 1000 feet from the area affected by the release.

REGULATED SUBSTANCES:

| Substance Name | GW | Soil | Substance Name | GW | Soil |
|----------------|-------------------------------------|-------------------------------------|----------------|-------------------------------------|-------------------------------------|
| Arsenic | <input checked="" type="checkbox"/> | <input checked="" type="checkbox"/> | Chromium | <input checked="" type="checkbox"/> | <input checked="" type="checkbox"/> |
| Copper | <input checked="" type="checkbox"/> | <input checked="" type="checkbox"/> | | | |