

**GEORGIA ENVIRONMENTAL PROTECTION DIVISION
HAZARDOUS SITE INVENTORY**

Site Number **10467**

SITE NAME: Bleckley County Municipal Landfill
LOCATION: 794 E GA Hwy 26
 Cochran, Bleckley County, GA 31014

Latitude 32° 25' 17" N Longitude 83° 18' 34" W

ACREAGE **PARCEL NUMBER** **DATE LISTED**
 69.67 B51 129 4/28/1997

LAST KNOWN PROPERTY OWNER:

Bleckley County
 112 N. Second Street
 Cochran, GA 31014

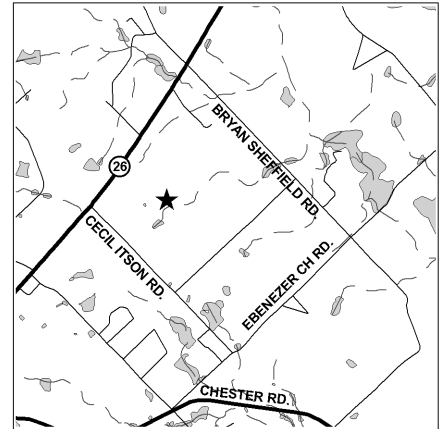

STATUS OF CLEANUP ACTIVITIES:

Cleanup activities are being conducted for source materials and groundwater.

CLEANUP PRIORITY: The Director has designated this site as a Class IV

GA EPD DIRECTOR'S DETERMINATION REGARDING CORRECTIVE ACTION:

The Director has determined that this site requires corrective action.

REGULATED SUBSTANCES RELEASED, AND THREATS TO HUMAN HEALTH AND ENVIRONMENT POSED BY THE RELEASE:

This site has a known release of Vinyl chloride in groundwater at levels exceeding the reportable quantity. No human exposure via drinking water is suspected from this release. The nearest drinking water well is less than 0.5 miles from the area affected by the release.

REGULATED SUBSTANCES:

Substance Name	GW	Soil	Substance Name	GW	Soil
1,2-Dichloropropane	<input checked="" type="checkbox"/>	<input type="checkbox"/>	Barium	<input checked="" type="checkbox"/>	<input type="checkbox"/>
Benzene	<input checked="" type="checkbox"/>	<input type="checkbox"/>	Chlorobenzene	<input checked="" type="checkbox"/>	<input type="checkbox"/>
Chloroethane	<input checked="" type="checkbox"/>	<input type="checkbox"/>	Cis-1,2-Dichloroethene	<input checked="" type="checkbox"/>	<input type="checkbox"/>
Dichlorobenzene, N.O.S.	<input checked="" type="checkbox"/>	<input type="checkbox"/>	Lead	<input checked="" type="checkbox"/>	<input type="checkbox"/>
Naphthalene	<input checked="" type="checkbox"/>	<input type="checkbox"/>	p-Dichlorobenzene	<input checked="" type="checkbox"/>	<input type="checkbox"/>
Vinyl chloride	<input checked="" type="checkbox"/>	<input type="checkbox"/>	Xylenes	<input checked="" type="checkbox"/>	<input type="checkbox"/>
Zinc	<input checked="" type="checkbox"/>	<input type="checkbox"/>			